

UNITED STATES
DEPARTMENT OF THE INTERIOR
GEOLOGICAL SURVEY

OGLETOWN QUADRANGLE
PENNSYLVANIA
7.5 MINUTE SERIES (TOPOGRAPHIC)

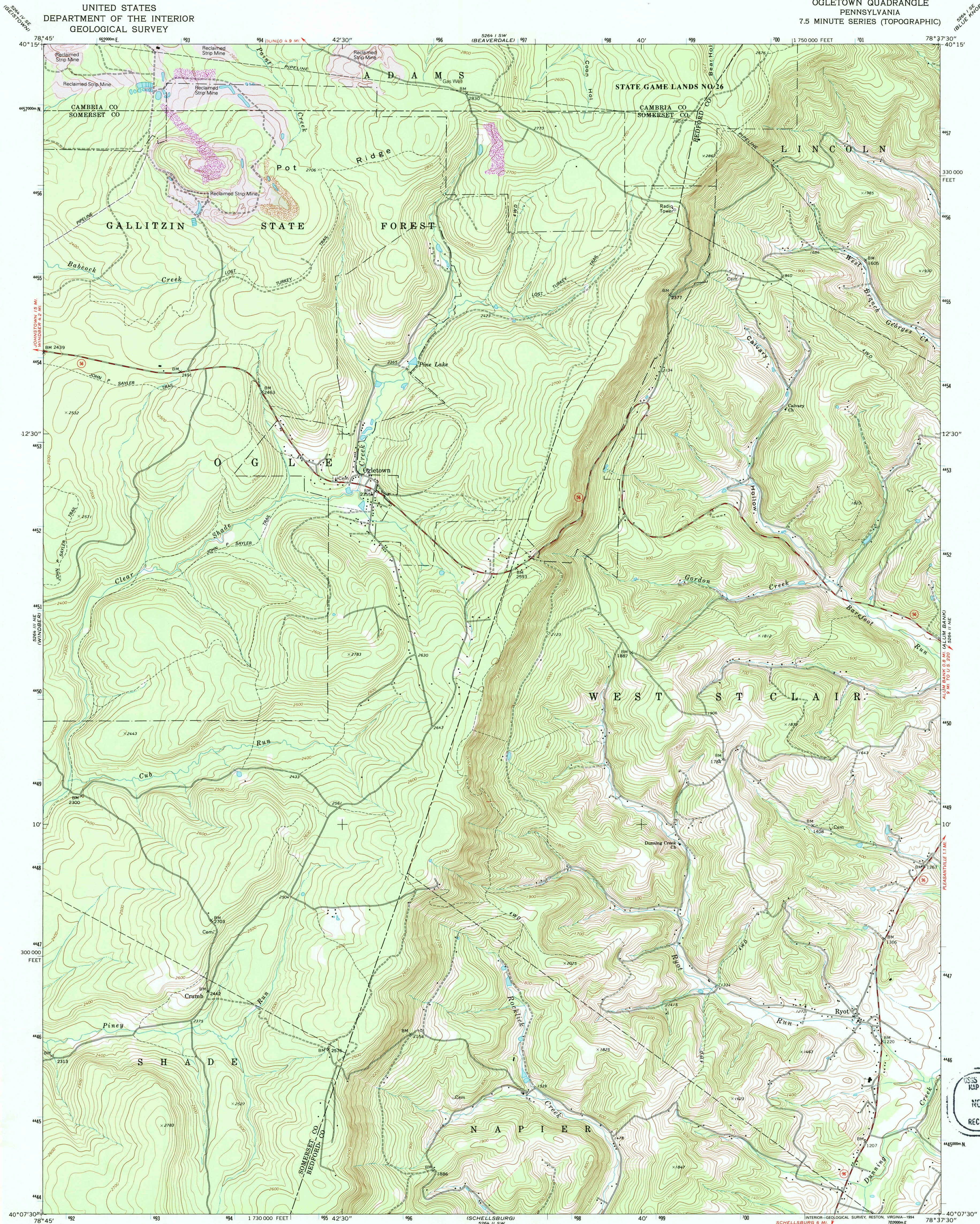

USGS AND HISTORICAL
MAP ARCHIVES
NOV 13 1995
REC'D FILE COPY

Produced by the United States Geological Survey
in cooperation with Commonwealth of Pennsylvania agencies
Control by USGS and NOS/NOAA
Topography by photogrammetric methods from aerial photographs
taken 1966-67 and 1969. Field checked 1971. Revised from aerial photographs
taken 1988 and 1991. Map edited 1994
Projection and 10,000-foot grid ticks: Pennsylvania coordinate
system, south zone (Lambert conformal conic)
1000-meter Universal Transverse Mercator grid ticks, zone 17, shown in blue
1927 North American Datum (NAD 27)
North American Datum of 1983 (NAD 83) is shown by dashed corner ticks
The values of the shift between NAD 27 and NAD 83 for 7.5-minute
intersections are given in USGS Bulletin 1875
There may be private inholdings within the boundaries of
the National or State reservations shown on this map
Fine red dashed lines indicate selected fence and field lines where
generally visible on aerial photographs. This information is unchecked

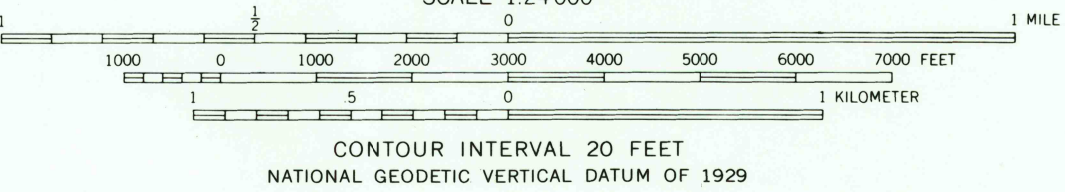
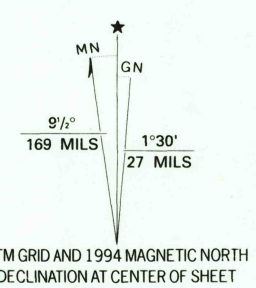

THIS MAP COMPLIES WITH NATIONAL MAP ACCURACY STANDARDS
FOR SALE BY U.S. GEOLOGICAL SURVEY, DENVER, COLORADO 80225
OR RESTON, VIRGINIA 22092
A FOLDER DESCRIBING TOPOGRAPHIC MAPS AND SYMBOLS IS AVAILABLE ON REQUEST

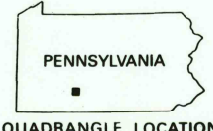

Contours in strip mine areas may not accurately
represent present topography
Light purple tint indicates reclaimed strip mine areas

ROAD CLASSIFICATION
Primary highway, hard surface
Secondary highway, hard surface
Light-duty road, hard or improved surface
Unimproved road
Interstate Route
U.S. Route
State Route

OGLETOWN, PA.
40078-B6-TF-024
1971
REVISED 1994
DMA 5264 II NW-SERIES V831

13BN 0-507-14545-2
9 780607 464356