

(Georgetown) 78° 30' 40° 00'

DEPARTMENT OF THE INTERIOR
U. S. GEOLOGICAL SURVEY

826-N-11-W/2
STATE OF PENNSYLVANIA
DEPARTMENT OF INTERNAL AFFAIRS
JAMES F. WOODWARD, SECRETARY
TOPOGRAPHIC AND GEOLOGIC SURVEY
GEORGE H. ASHLEY, STATE GEOLOGIST
(Everett)

Advance sheet
Subject to correction

PENNSYLVANIA
CLEARVILLE QUADRANGLE

78° 15' 40° 00'



15 Miles
14
13
12
11
10
9
8
7
6
5
4
3
2
1
0
1
2
3
4
5
6
7
8
9
10
11
12
13
14
15

(Flinstone) 78° 30' 195 000 YARDS

Glenn S. Smith, Division Engineer
Topography by CW Goodlove, JI Gayetty, RC Seitz, RF Wilcoxon,
Kostka Mudd, H.A. Bean, and C.S. Wells
Control by U. S. Geological Survey and
Pennsylvania State Highway Department
Surveyed in 1977

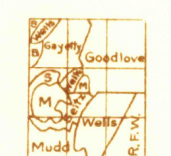

APPROXIMATE MEAN DECLINATION, 1927

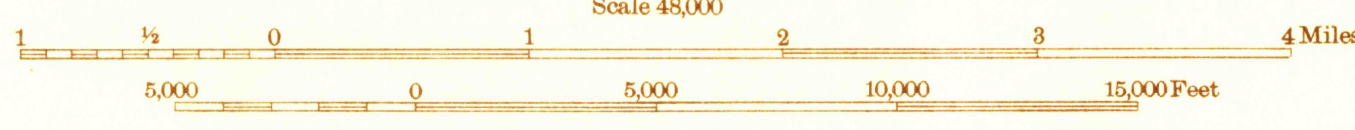

Scale 48,000
Contour interval 20 feet
Datum is mean sea level

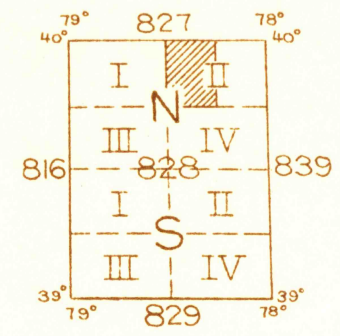

Polyconic projection. North American datum
5000 yard grid based upon U. S. zone system, B

CLEARVILLE, PA

78° 15' (Hancock) 39° 45'