

(Scranton)

CORPS OF ENGINEERS, U.S. ARMY
PROGRESSIVE MILITARY MAP

ADVANCE SHEET
859-S-IV-W/2

PENNSYLVANIA
POCONO QUADRANGLE.

MAPPED BY U.S.G.S. IN 1918
1921

(Hawley)

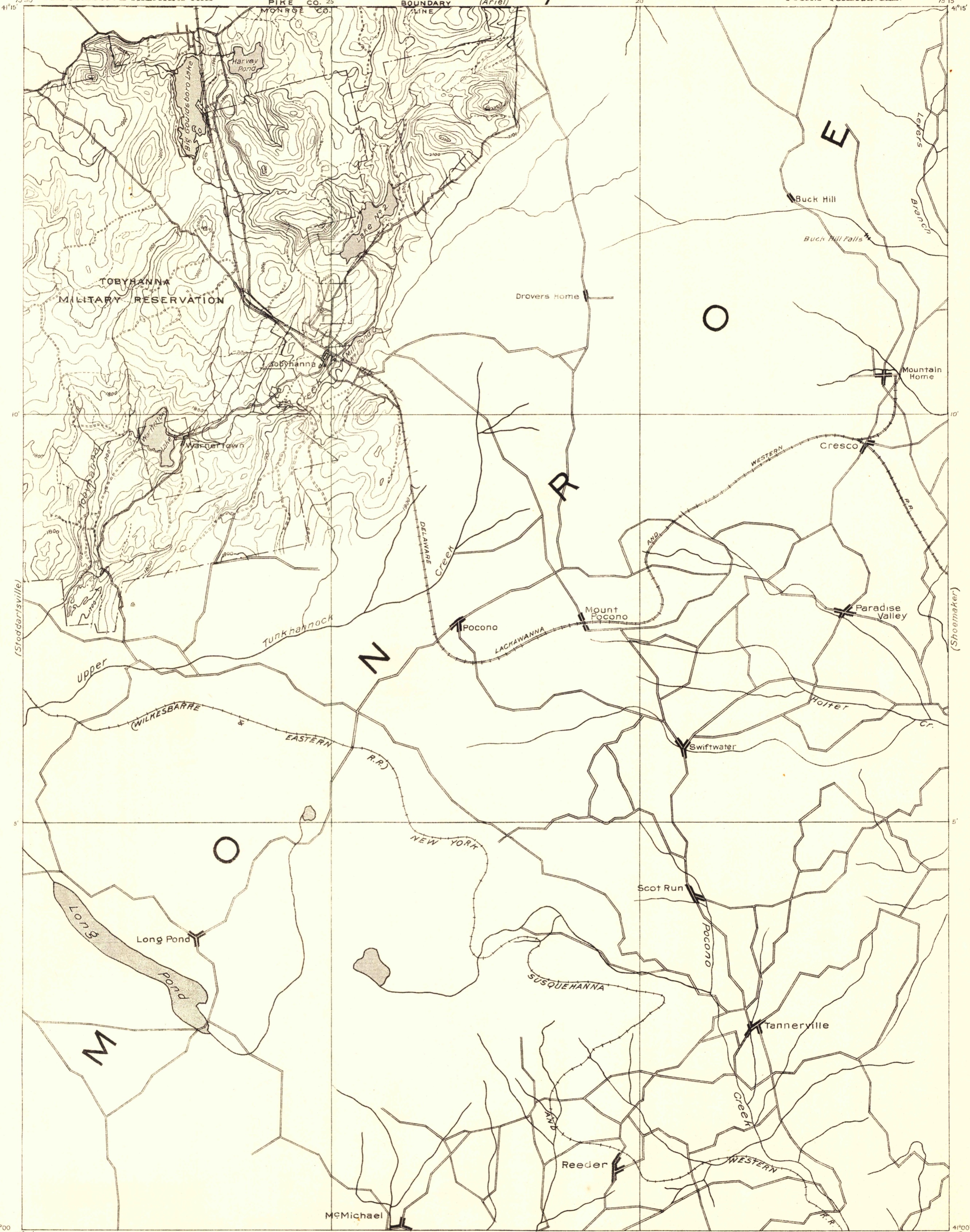

Compilation under the direction of
Brig Gen. Theo. A. Bingham, Corps of Engineers, U.S.A.,
Department Engineer, Eastern Department,
Oct. 1918.

Base map from Tobyhanna Military Reservation and
Monroe County maps.

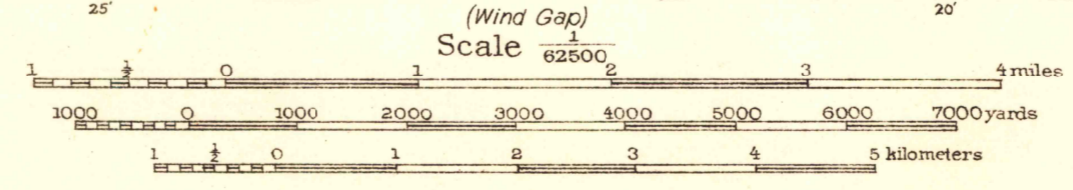

NOTE: OFFICERS USING THIS MAP WILL MARK HEREON CORRECTIONS AND ADDITIONS WHICH COME
TO THEIR ATTENTION AND MAIL DIRECT TO "THE CHIEF OF ENGINEERS, WASHINGTON, D.C."

Engineer Reproduction Plant, U. S. Army, Washington Barracks, D.C.
1919

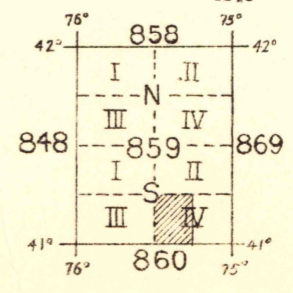

APPROXIMATE MEAN
DECLINATION 1919
POCONO PA

(Mauch Chunk)

(Delaware Water Gap)

FILE COPY
INFORMATION OFFICE