

FINAL SHEET  
823-N-III-W/2-NE/4  
(Fort Moultrie)

SOUTH CAROLINA  
(CHARLESTON COUNTY)  
THE JETTIES QUADRANGLE

CORPS OF ENGINEERS, U. S. ARMY  
PROGRESSIVE MILITARY MAP

Cummings Point

MOYAT ISLAND

SOUTH JETTY

NORTH JETTY

OCEAN

ATLANTIC

James Island

Capers Island

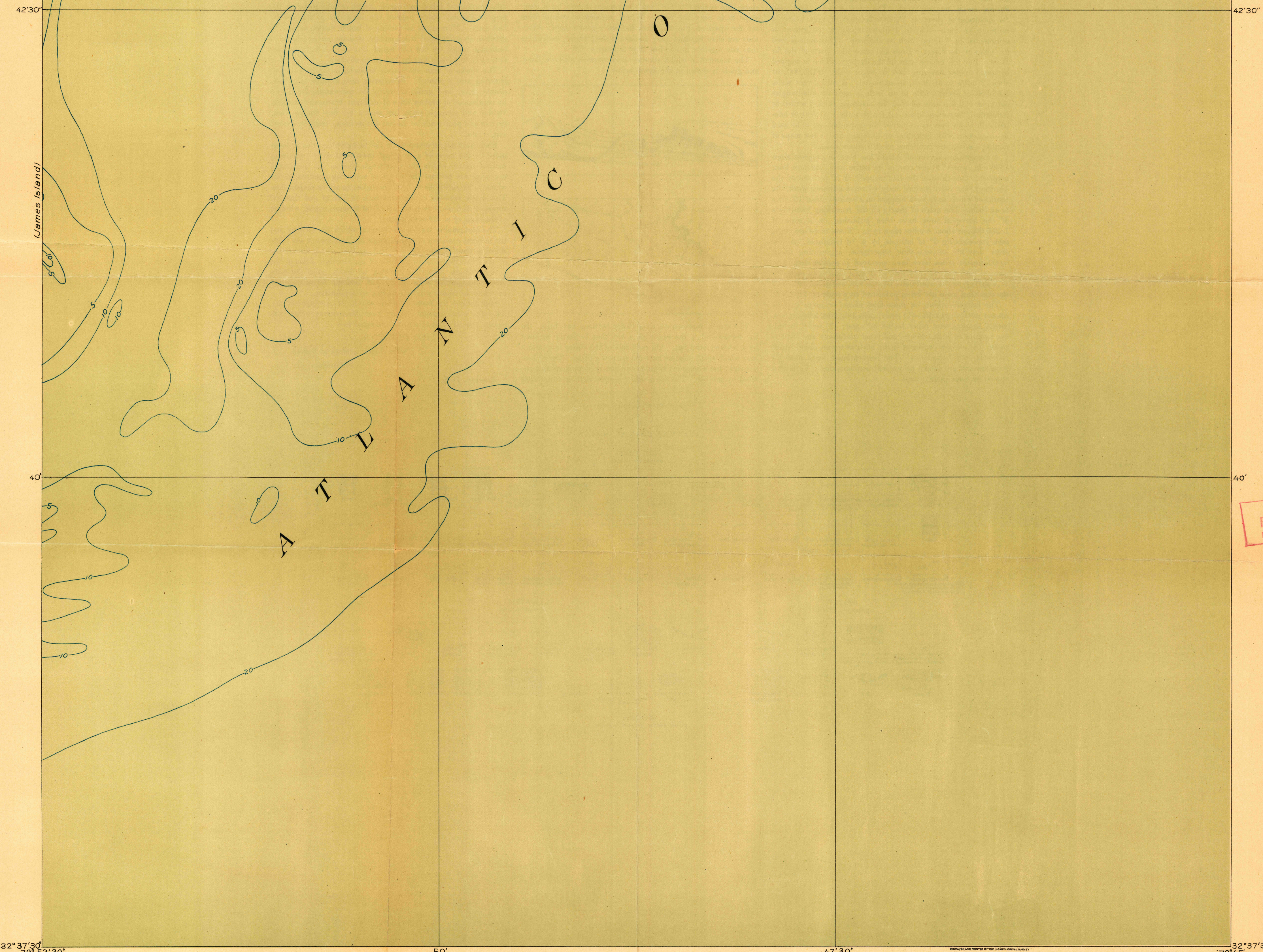

U. S. G. S.  
FILE COPY  
Inspection and Editing.

R. B. Marshall, Lt. Col. Engineers, Chief Geographer.  
W. H. Herron, Major Engineers, Geographer in charge.  
Topography and control by U. S. Coast and Geodetic Survey.  
COMPILED, 1919, IN COOPERATION WITH THE NAVY DEPARTMENT  
U. S. GEOLOGICAL SURVEY, GEORGE OTIS SMITH, DIRECTOR

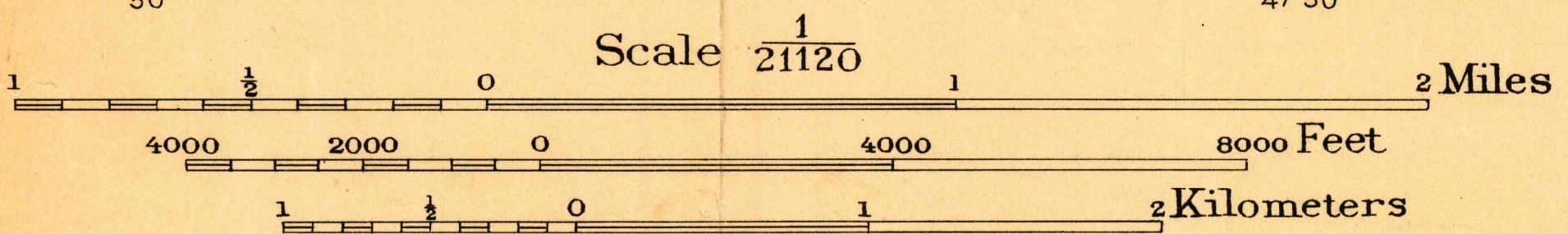

Contours off shore 5, 10, and 20 feet below mean low water.  
NOTE: OFFICERS USING THIS MAP WILL MAKE NECESSARY CORRECTIONS AND ADDITIONS WHICH COME TO THEIR ATTENTION AND MAIL DIRECT TO "THE CHIEF OF ENGINEERS, WASHINGTON, D. C."

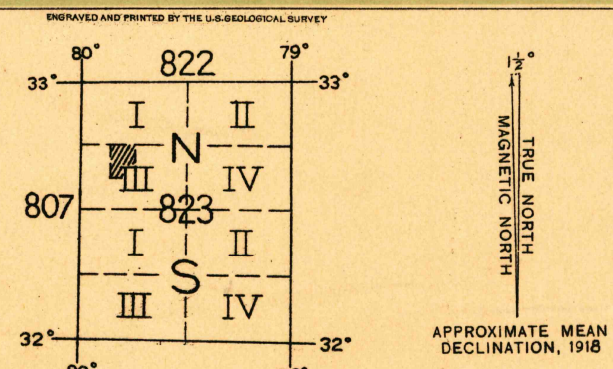

Edition of 1919.