

DEPARTMENT OF THE INTERIOR
FRANKLIN K. LANE, SECRETARY
U. S. GEOLOGICAL SURVEY
GEORGE OTIS SMITH, DIRECTOR

787-S-II-E/2
TOPOGRAPHY
WAR DEPARTMENT
CORPS OF ENGINEERS, U. S. ARMY

Advanced sheet.
Subject to correction.
TOPOGRAPHIC FILES

SOUTH CAROLINA
BAMBERG QUADRANGLE



(Williston)

33° 15' 81° 15'
R. B. Marshall, Chief Geographer.
W. H. Herron, Geographer in charge.
Topography by R. L. Harrison, T. F. Slaughter,
R. H. Runyan, and H. A. Bean.
Control by U. S. Coast and Geodetic Survey, Geo. T.
Hawkins, Oscar Jones, E. L. McNair, H. S. Senseney,
C. H. Semper, and H. L. Hudson.
Surveyed in 1918-1919.

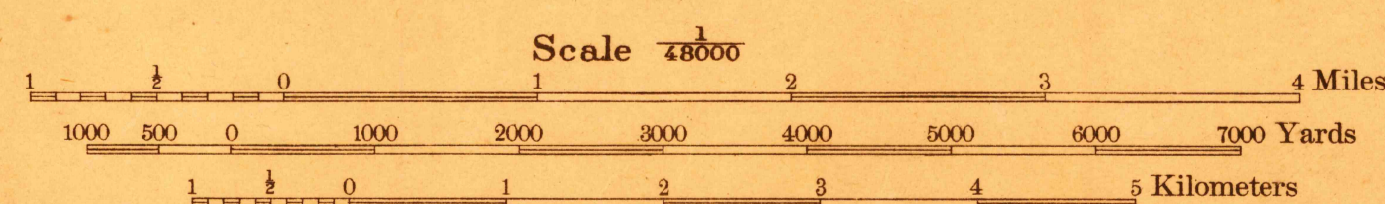
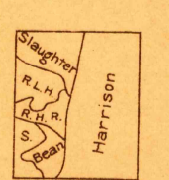

Contour interval 10 feet.
Datum is mean sea level.

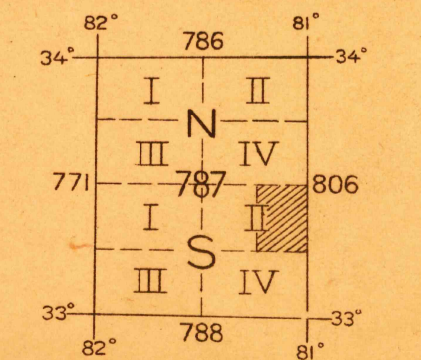

Edition of 1919
HISTORICAL FILES
RETURN TO CENTRAL FILE
(DO NOT REMOVE)
APPROXIMATE MEAN DECLINATION 1918
BAMBERG

SURVEYED IN COOPERATION WITH THE WAR DEPARTMENT