

RETAINED COPY  
This sheet must not be taken  
from the files without an order  
from the Chief Geographer.

806-N-II-E/2

TOPOGRAPHY  
WAR DEPARTMENT  
CORPS OF ENGINEERS, U. S. ARMY.

DEPARTMENT OF THE INTERIOR  
JOHN BARTON PAYNE, SECRETARY  
U. S. GEOLOGICAL SURVEY  
GEORGE OTIS SMITH, DIRECTOR

Advance sheet.  
Subject to correction.



C. H. Birdseye, Chief Topographic Engineer.  
Frank Sutton, Geographer in charge.  
Topography by Robert Muldrow, J. H. Wilke, J. S. Ward,  
W. F. Chenault, B. D. Blitch, J. R. Gravatt and Donald Noyes.  
Control by Oscar Jones, H. S. Senseney, and C. H. Semper.  
Surveyed in 1919.

SURVEYED IN COOPERATION WITH THE WAR DEPARTMENT

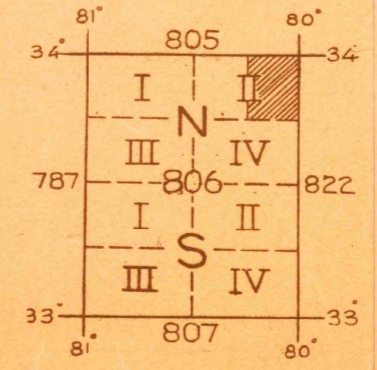
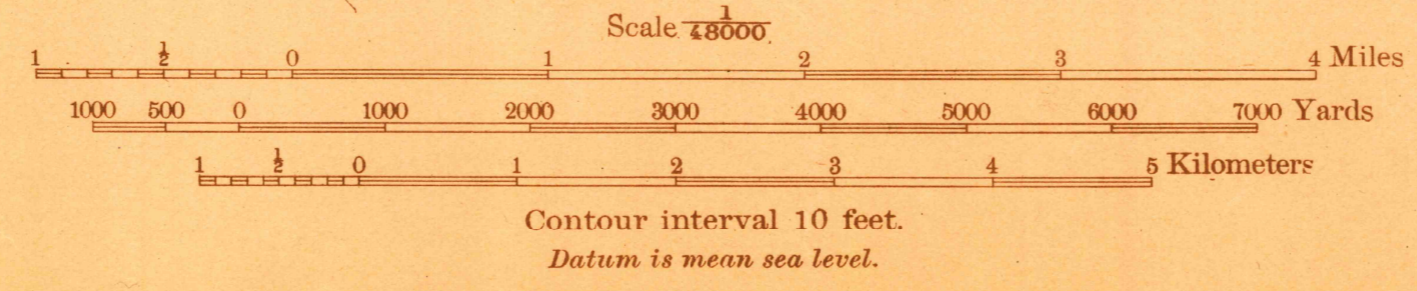
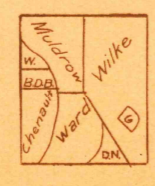

Edition of 1920

FILE COPY  
RETURN TO CENTRAL FILE  
MAYESVILLE