

CONVENTIONAL SIGNS

CULTURE
(printed in black)

- Rods and buildings
- Private and secondary roads
- Trails
- Railroads
- Street railroads
- Tunnels
- Bridges
- Ferries
- Fords
- Dams
- Locks
- U.S. township and section lines
- Located township and section corners
- Township and section corners not found
- Triangulation stations
- Bench marks
- Mines and quarries
- Prospects
- Shafts
- Mine tunnels (showing direction)
- Mine tunnels (direction unknown)

CONVENTIONAL SIGNS

RELIEF
(printed in brown)

- 5463
Figures (showing heights above mean sea level instrumentally determined)
- Contours (showing heights above sea level, horizontal form and steepness of slope of the surface)
- Depression contours
- Levees
- Cliffs
- Mine dumps
- DRAINAGE
(printed in blue)
- Streams
- Falls and rapids
- Intermittent streams
- Canals and ditches
- Lakes and ponds
- Intermittent lakes
- Glaciers
- Springs
- Salt marshes
- Fresh marshes
- Tidal flats

The above signs are in current use on the topographic maps. Variations from this usage appear in some maps of earlier dates.

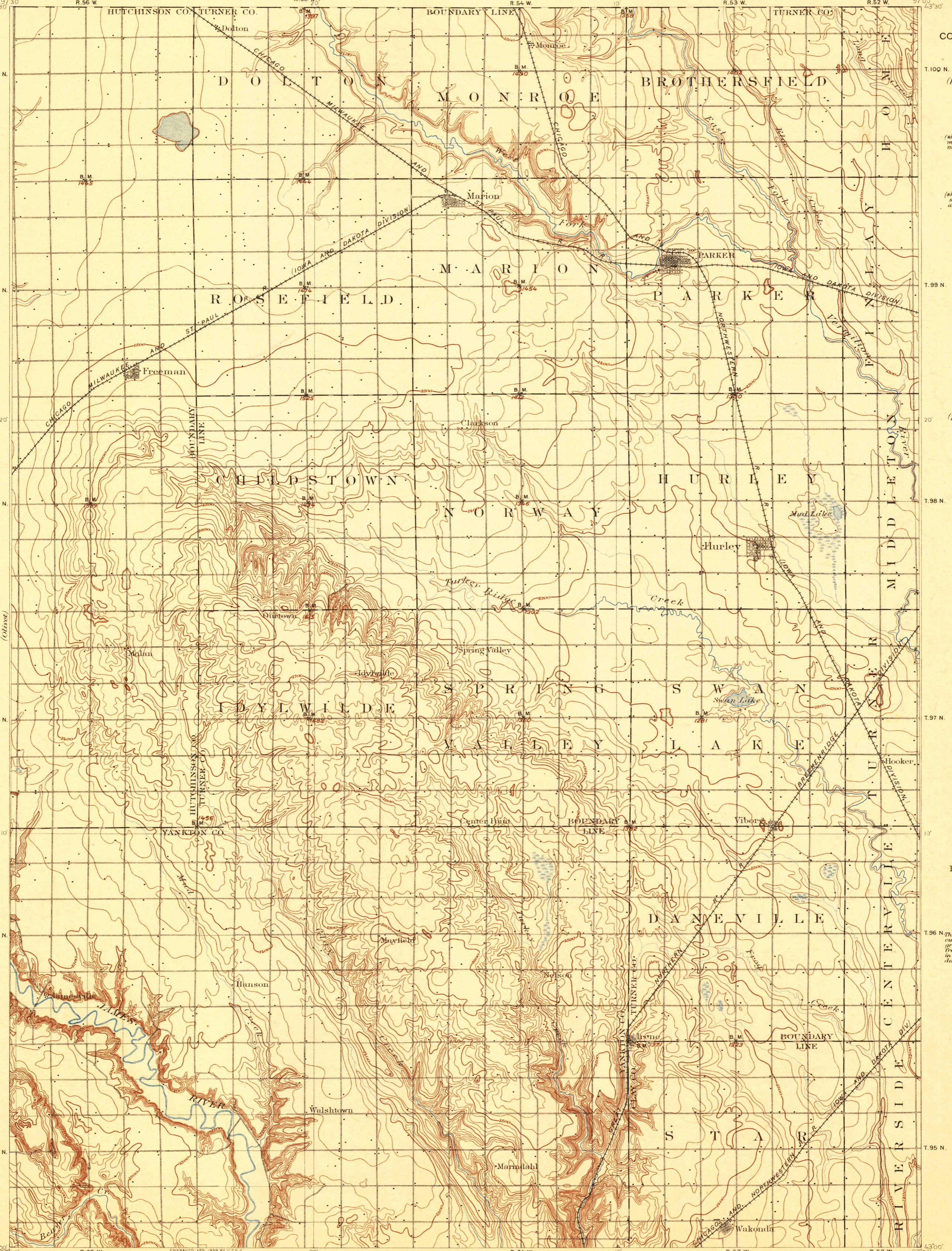

Jno. H. Renshawe Topographer in charge.
Control by Geo. T. Hawkins.
Topography by Wm. H. Griffin.
Surveyed in 1896.

Scale 1:25000
1 2 3 4 5 Miles
1 2 3 4 5 Kilometers
Contour interval 20 feet
Datum is mean sea level

U.S.G.S. HISTORICAL FILE
TOPOGRAPHIC DIVISION
FILE COPY

June 8-1898
PARKER, S. Dak