

U.S.G.S.  
FILE COPY  
TOPOGRAPHIC DIVISION

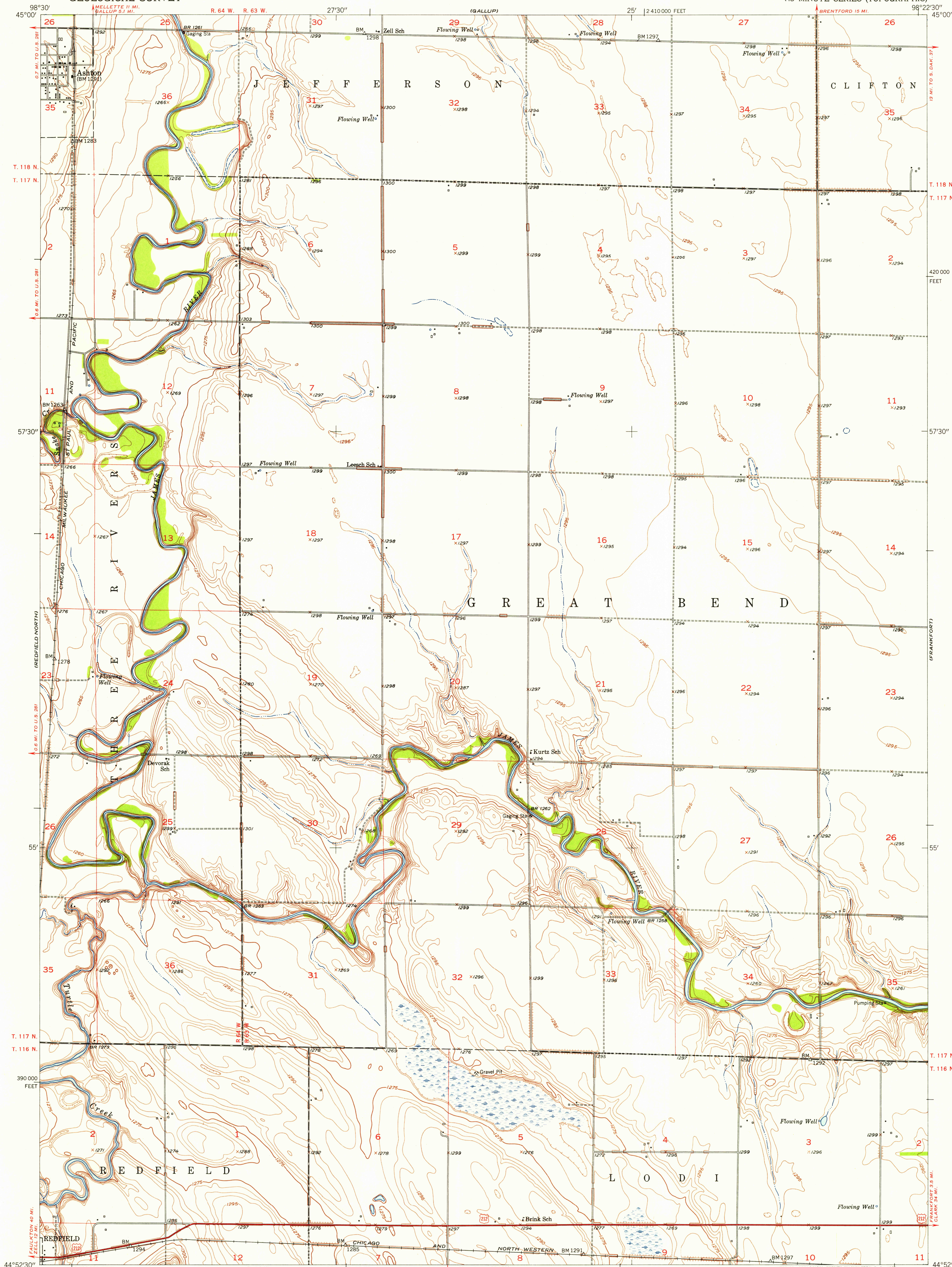

Mapped, edited, and published by the Geological Survey as part of the Department of the Interior program for the development of the Missouri River Basin Control by USGS, USC&GS, and Bureau of Reclamation Culture and drainage in part compiled from aerial photographs taken 1951. Topography by plane-table surveys 1953 Polyconic projection. 1927 North American datum 10,000-foot grid based on South Dakota coordinate system, north zone

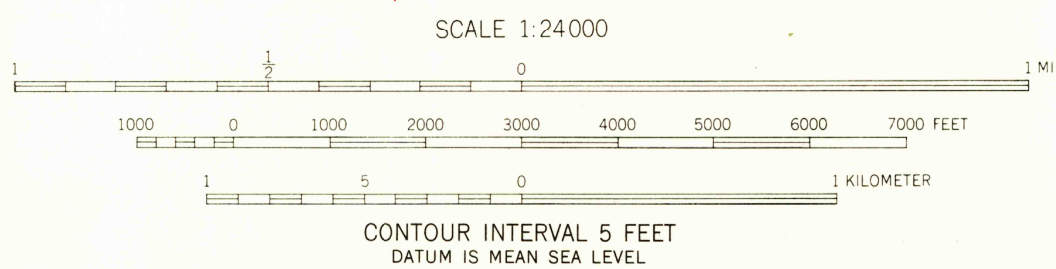

ROAD CLASSIFICATION

Heavy-duty	4 LANE 6 LANE	Light-duty
Medium-duty	4 LANE 6 LANE	Unimproved dirt

U. S. Route      State Route

USGS  
HISTORICAL FILE  
TOPOGRAPHIC DIVISION

ASHTON, S. DAK.  
N 4452.5—W 9822.5/7.5  
1953

U.S.G.S.  
FILE COPY  
TOPOGRAPHIC DIVISION