

39° 52' 30" N  
99° 52' 30" W

39° 52' 30" N  
99° 52' 30" W

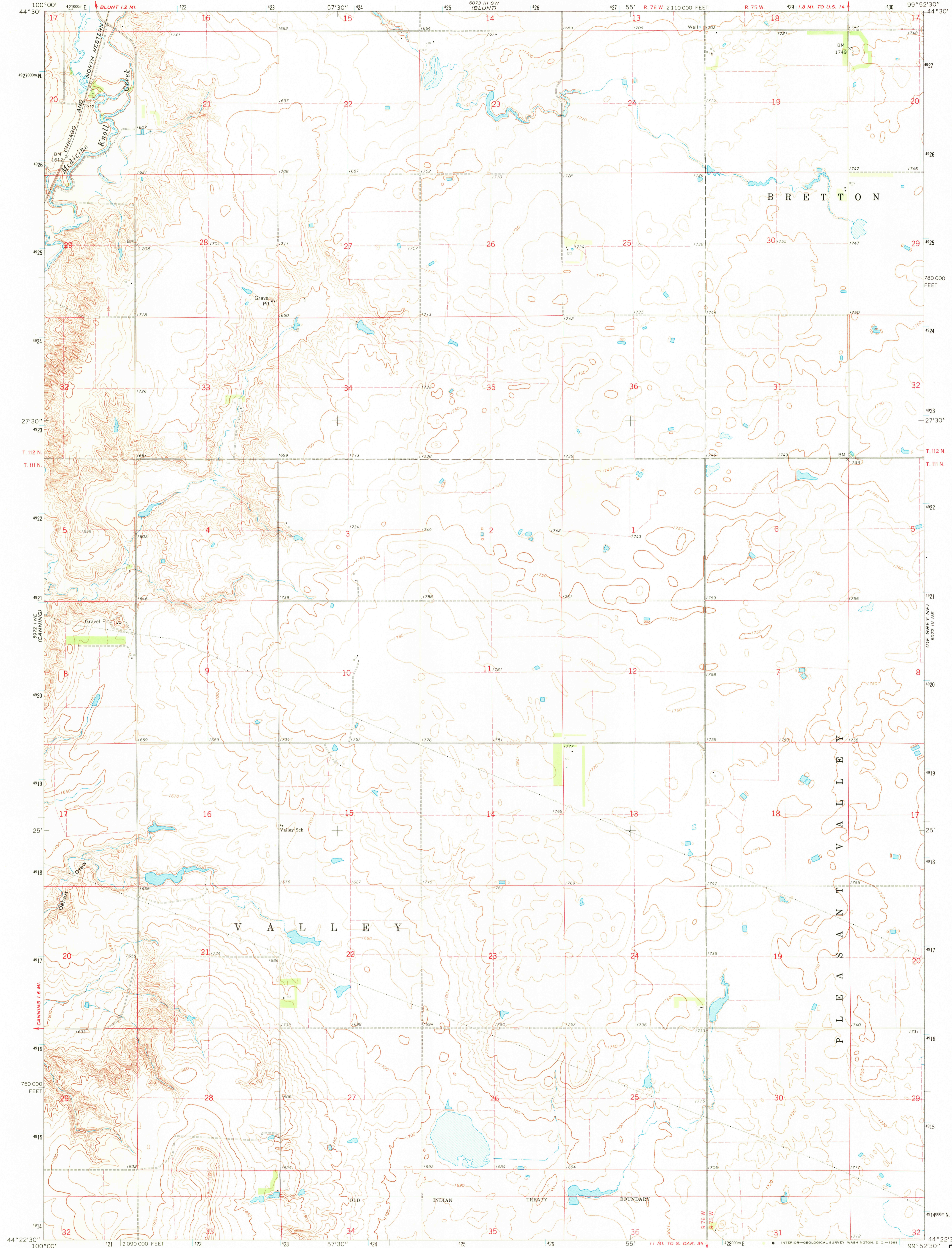

Mapped, edited, and published by the Geological Survey as part of the Department of the Interior program for the development of the Missouri River Basin Control by USGS and USC&GS  
Topography by photogrammetric methods from aerial photographs taken 1966. Field checked 1967  
Polyconic projection. 1927 North American datum  
10,000-foot grid based on South Dakota coordinate system, south zone  
1000-meter Universal Transverse Mercator grid ticks, zone 14, shown in blue  
Fine red dash lines indicate selected fence and field lines where generally visible on aerial photographs. This information is unchecked

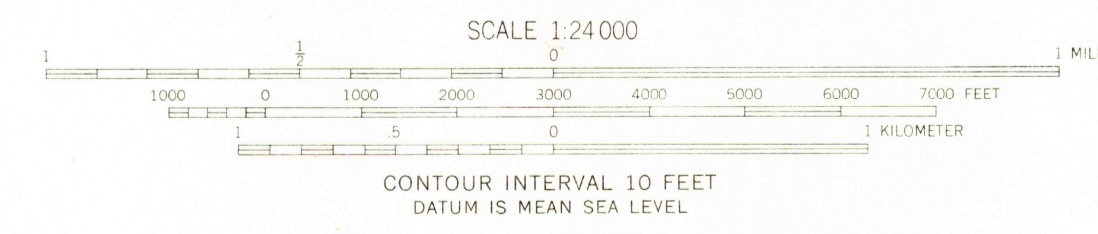
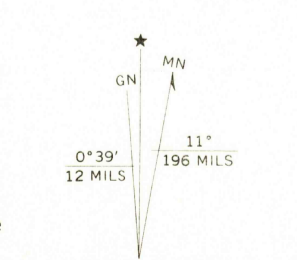

USGS  
HISTORICAL FILE  
TOPOGRAPHIC DIVISION

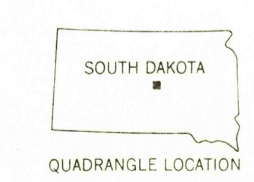

ROAD CLASSIFICATION  
Light-duty ————— Unimproved dirt —————

U.S.G.S.  
FILE COPY  
TOPOGRAPHIC DIVISION

DE GREY NW, S. DAK.  
N4422.5—W9952.5/7.5

1967

AMS 6072 IV NW—SERIES V873

2220  
AUG 5 1969