

UNITED STATES  
DEPARTMENT OF THE INTERIOR  
GEOLOGICAL SURVEY

ESTELLINE SE QUADRANGLE  
SOUTH DAKOTA  
7.5 MINUTE SERIES (TOPOGRAPHIC)

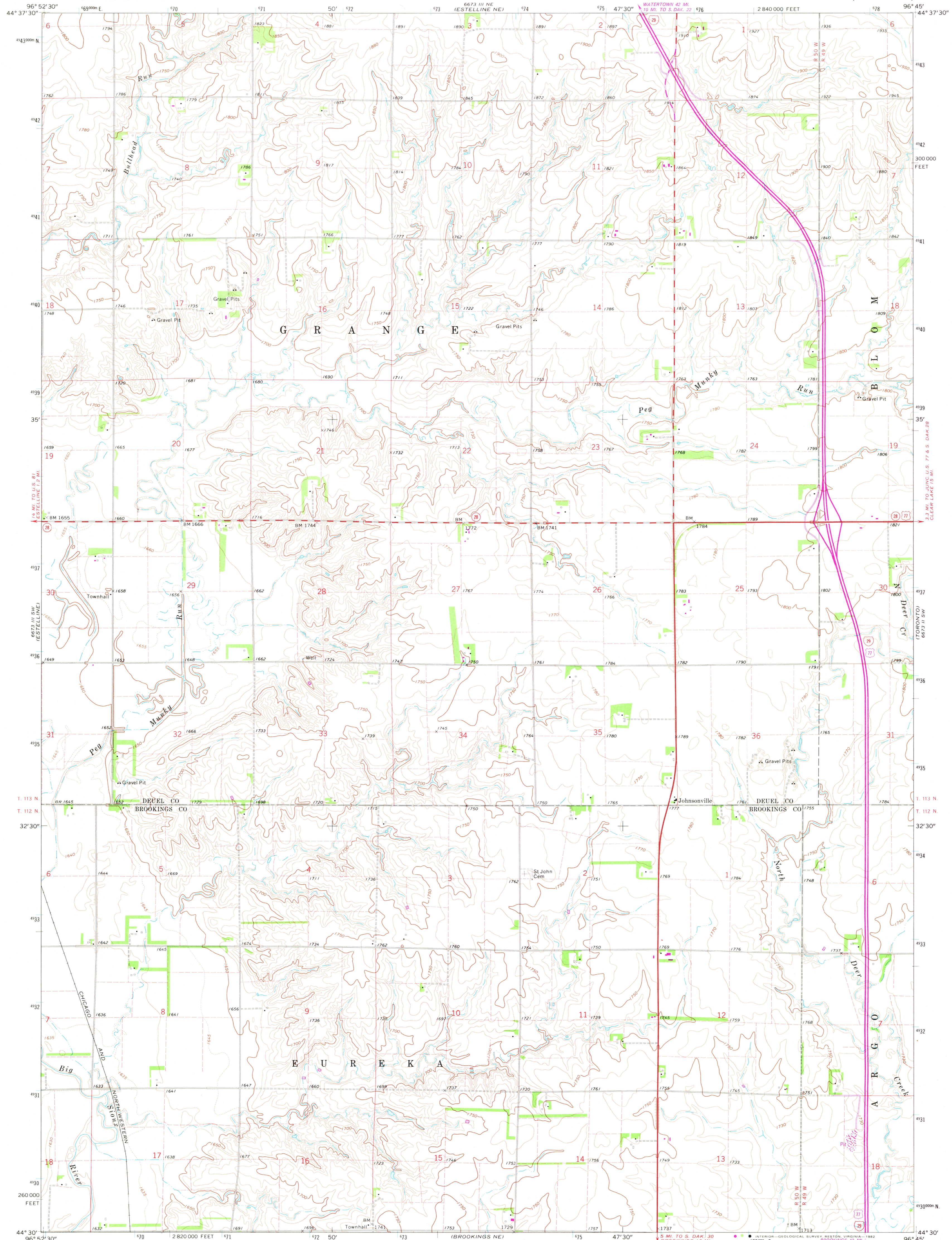

Mapped, edited, and published by the Geological Survey  
Control by USGS and USC&GS  
Topography by photogrammetric methods from aerial photographs taken 1966. Field checked 1970  
Polyconic projection. 1927 North American datum  
10,000-foot grid based on South Dakota coordinate system, north zone  
1000-meter Universal Transverse Mercator grid ticks, zone 14, shown in blue  
Fine red dashed lines indicate selected fence and field lines where generally visible on aerial photographs  
This information is unchecked  
To place on the predicted North American Datum 1983 move the projection lines 7 meters north and 27 meters east as shown by dashed corner ticks  
Revisions shown in purple compiled from aerial photographs taken 1978. Map edited 1981. This information not field checked

Scale: 1:24,000  
CONTOUR INTERVAL 10 FEET  
DOTTED LINES REPRESENT 5-FOOT CONTOURS  
NATIONAL GEODETIC VERTICAL DATUM OF 1929

UTM GRID AND 1981 MAGNETIC NORTH DECLINATION AT CENTER OF SHEET

THIS MAP COMPLEYS WITH NATIONAL MAP ACCURACY STANDARDS  
FOR SALE BY U. S. GEOLOGICAL SURVEY, DENVER, COLORADO 80225, OR RESTON, VIRGINIA 22092  
A FOLDER DESCRIBING TOPOGRAPHIC MAPS AND SYMBOLS IS AVAILABLE ON REQUEST

QUADRANGLE LOCATION

ROAD CLASSIFICATION

Primary highway, all weather, hard surface	Light-duty road, all weather, improved surface
Secondary highway, all weather, hard surface	Unimproved road, fair or dry weather

   Interstate Route   
    U. S. Route   
    State Route

ESTELLINE SE, S. DAK.  
N4430—W9645/7.5  
1970  
PHOTOREVISED 1981  
DMA 6673 III SE—SERIES V873

RETURN TO:  
USGS AND HISTORICAL MAP ARCHIVES

JAN 20 1982

2000