

5775 IV NE  
(WYANDOTA)

UNITED STATES  
DEPARTMENT OF THE INTERIOR  
GEOLOGICAL SURVEY

MC INTOSH SW QUADRANGLE  
SOUTH DAKOTA—CORSON CO.  
7.5 MINUTE SERIES (TOPOGRAPHIC)

5775 IV NE  
(MCINTOSH)

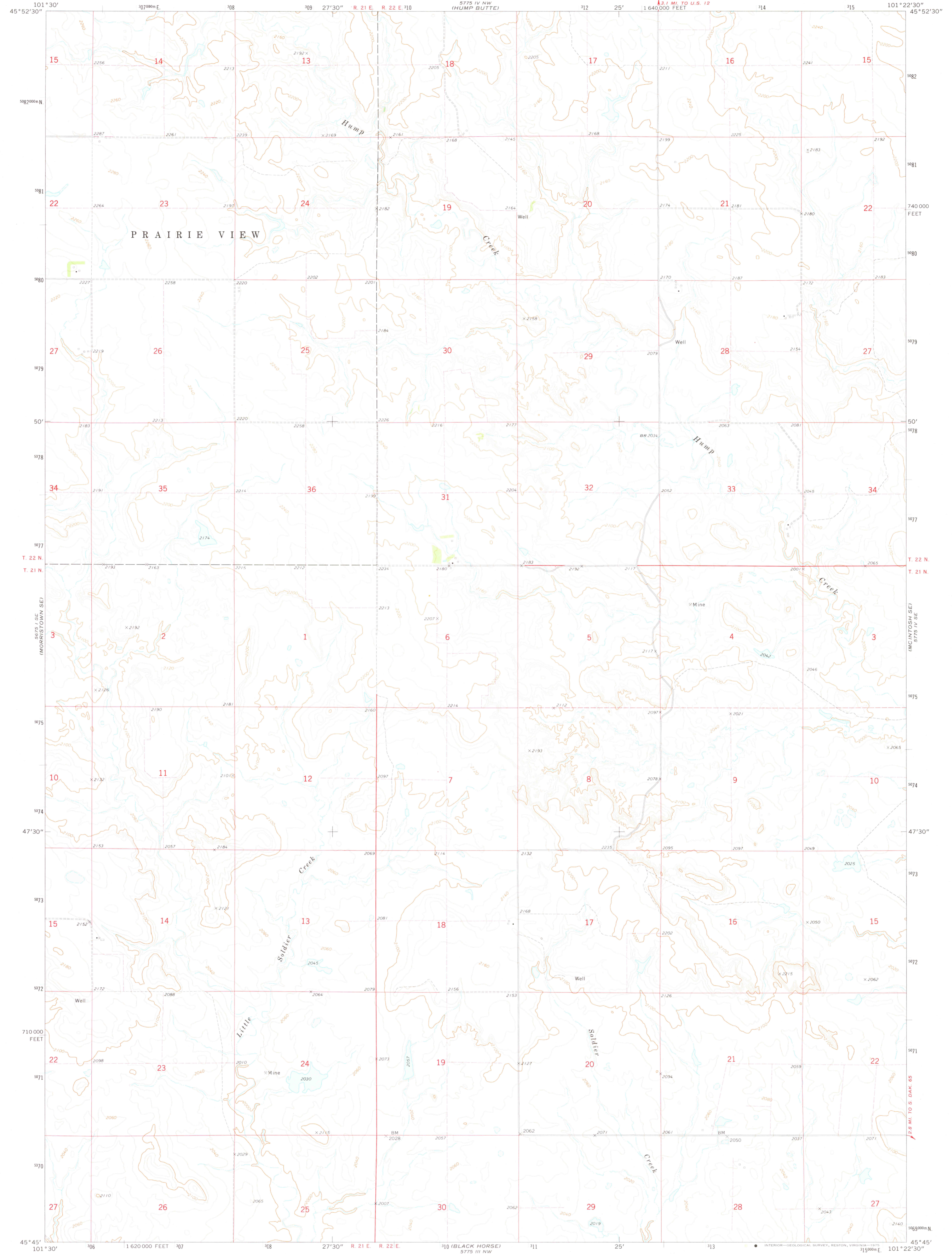

Mapped, edited, and published by the Geological Survey  
Control by USGS and USC&GS  
Topography by photogrammetric methods from aerial  
photographs taken 1972. Field checked 1972  
Projection and 10,000-foot grid ticks: South Dakota coordinate  
system, north zone (Lambert conformal conic)  
1000-meter Universal Transverse Mercator grid ticks,  
zone 14, shown in blue. 1927 North American datum  
Entire area lies within the Standing Rock Indian Reservation  
Fine red dashed lines indicate selected fence and field lines  
where generally visible on aerial photographs  
This information is unchecked

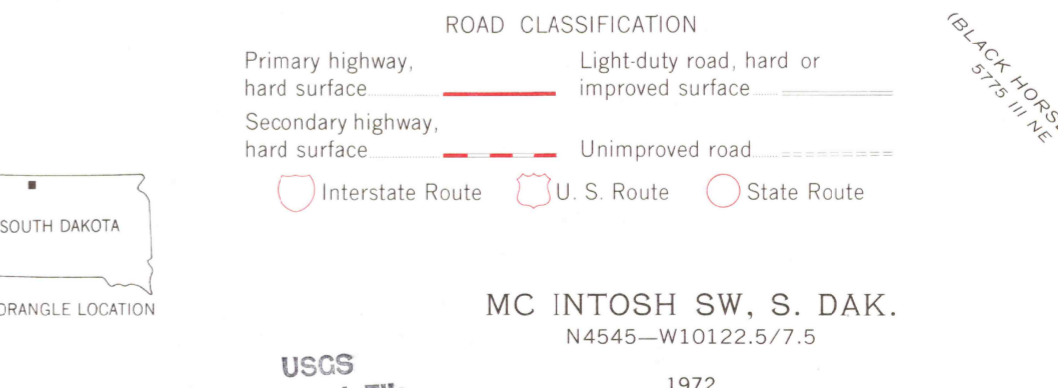
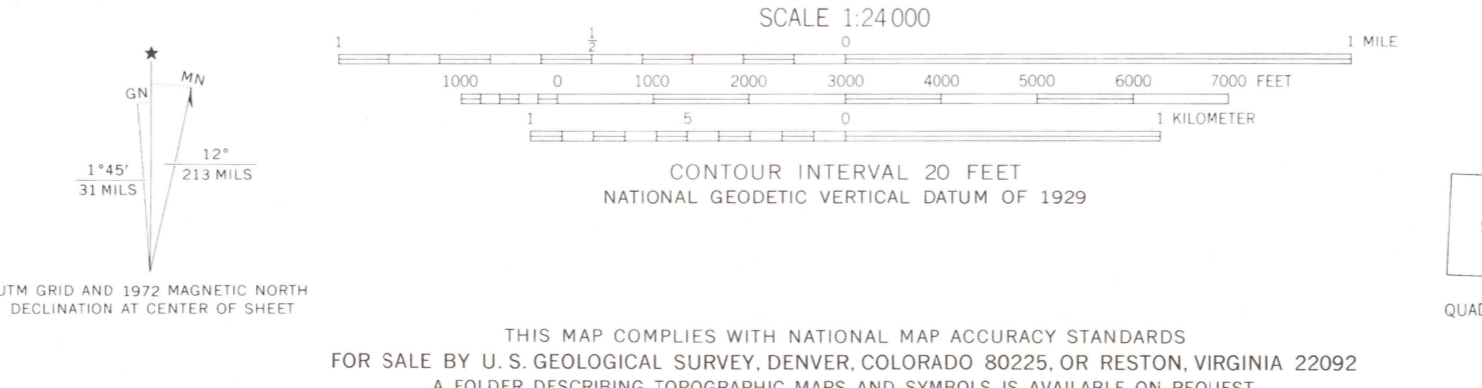

THIS MAP COMPLIES WITH NATIONAL MAP ACCURACY STANDARDS  
FOR SALE BY U.S. GEOLOGICAL SURVEY, DENVER, COLORADO 80225, OR RESTON, VIRGINIA 22092  
A FOLDER DESCRIBING TOPOGRAPHIC MAPS AND SYMBOLS IS AVAILABLE ON REQUEST

USGS  
Historical File  
Topographic Division  
1972  
AMS 5775 IV SW—SERIES V873

MC INTOSH SW, S. DAK.  
N4545—W10122.5/7.5

26 70

MAR 2 1972