

61214 SE
1920.0

6273 IV SE
1902.0

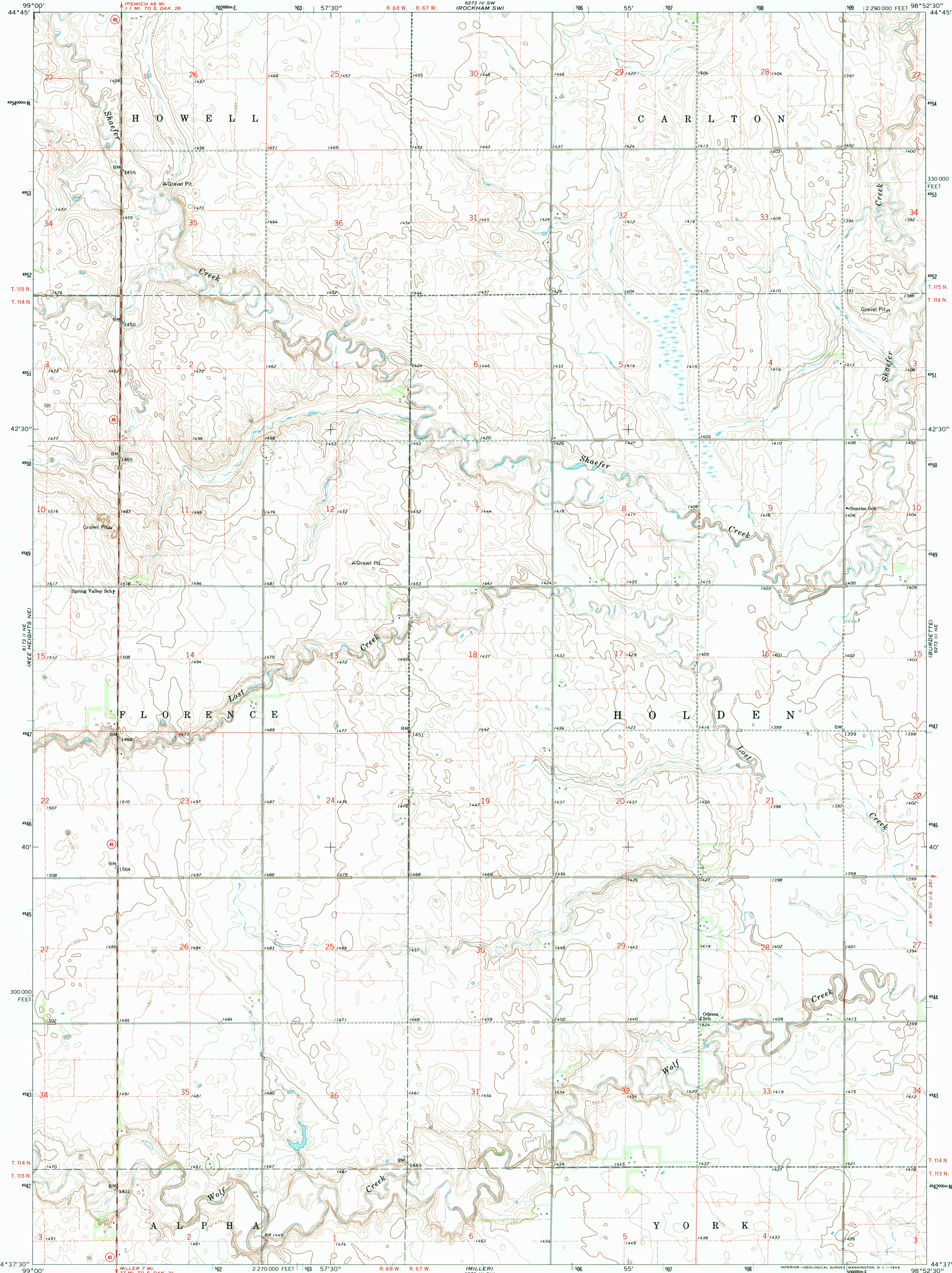

Mapped, edited, and published by the Geological Survey as part of the Department of the Interior program for the development of the Missouri River Basin Control by USGS, USC&GS, and U. S. Bureau of Reclamation. Topography by photogrammetric methods from aerial photographs taken 1965, planimetric surveys 1967, and in part by U. S. Bureau of Reclamation. Polyconic projection. 1927 North American datum 10,000-foot grid based on South Dakota coordinate system, north zone 1000-meter Universal Transverse Mercator grid ticks, zone 14, shown in blue. Fine red dashed lines indicate selected fence and field lines where generally visible on aerial photographs. This information is unchecked.

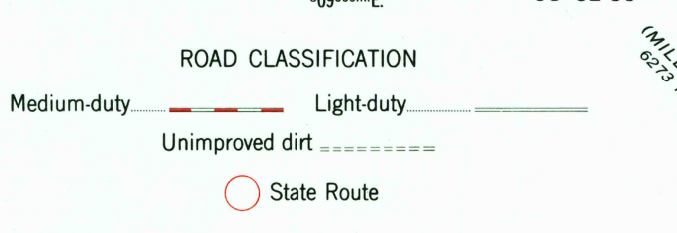
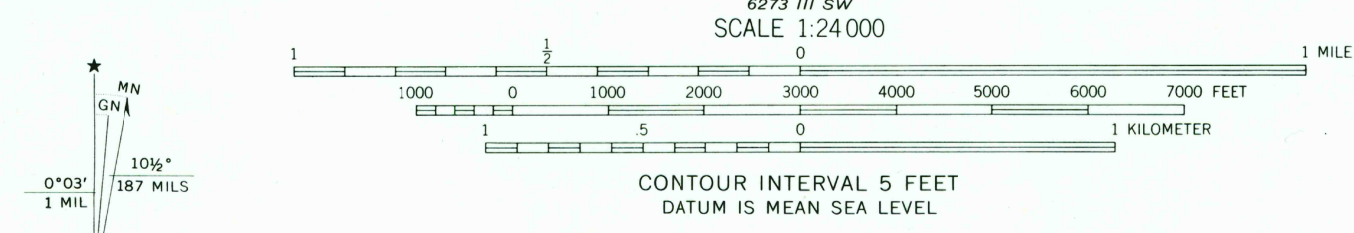

MILLER NW, S. DAK.
N4437.5—W9852.5/7.5
1967
AMS 6273 III NW—SERIES W873

FOR SALE BY U. S. GEOLOGICAL SURVEY, DENVER, COLORADO 80225, OR WASHINGTON, D. C. 20242
A FOLDER DESCRIBING TOPOGRAPHIC MAPS AND SYMBOLS IS AVAILABLE ON REQUEST

