

UNITED STATES  
DEPARTMENT OF THE INTERIOR  
GEOLOGICAL SURVEY

MITCHELL LAKE QUADRANGLE  
SOUTH DAKOTA-HYDE CO.  
7.5 MINUTE SERIES (TOPOGRAPHIC)

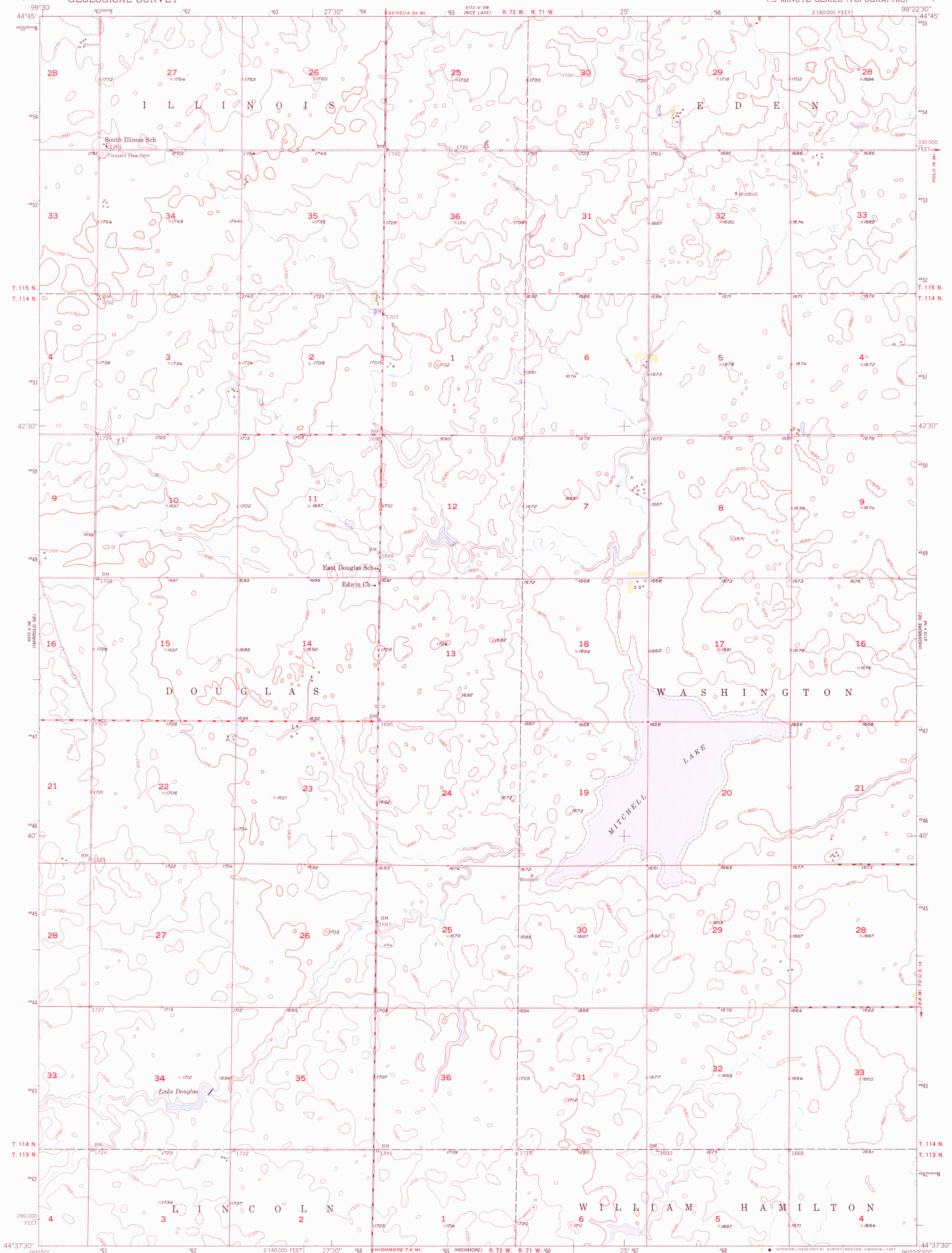

Maped, edited, and published by the Geological Survey  
as part of the Department of the Interior program  
for the development of the Missouri River Basin  
Control by USGS and USC&GS

Culture and drainage in part compiled from  
aerial photographs taken 1948  
Topography by plane-table methods 1949

Polyconic projection. 1927 North American datum  
10000-foot grid based on South Dakota coordinate system,  
north zone

To place on the predicted North American Datum 1983  
move the projection lines 6 meters north and  
32 meters east as shown by dashed corner ticks

Map photoinspected 1975  
No major culture or drainage changes observed

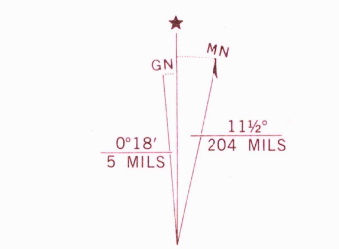

SCALE 1:24 000  
1 000 000 FEET  
1 KILOMETER  
CONTOUR INTERVAL 10 FEET  
NATIONAL GEODETIC VERTICAL DATUM OF 1929



ROAD CLASSIFICATION  
HARD-SURFACE ALL WEATHER ROADS DRY WEATHER ROADS  
Heavy-duty 4 LANE 16 LANE Improved dirt  
Medium-duty 4 LANE 16 LANE Unimproved dirt  
Loose-surface, graded, or narrow hard-surface  
U. S. Route State Route

MITCHELL LAKE, S. DAK.  
N4437.5-W9922.5/7.5

1949  
PHOTOINSPECTED 1975  
DMA 6173 III NW-SERIES V873

USGS AND HISTORICAL MAP ARCHIVES  
RETURN TO:  
USGS AND HISTORICAL MAP ARCHIVES

DEC 22 1981

1900