

UNITED STATES  
DEPARTMENT OF THE INTERIOR  
GEOLOGICAL SURVEY

ORIENT QUADRANGLE  
SOUTH DAKOTA  
7.5 MINUTE SERIES (TOPOGRAPHIC)

U. S. G. S.  
FILE COPY  
Inspection and Editing.

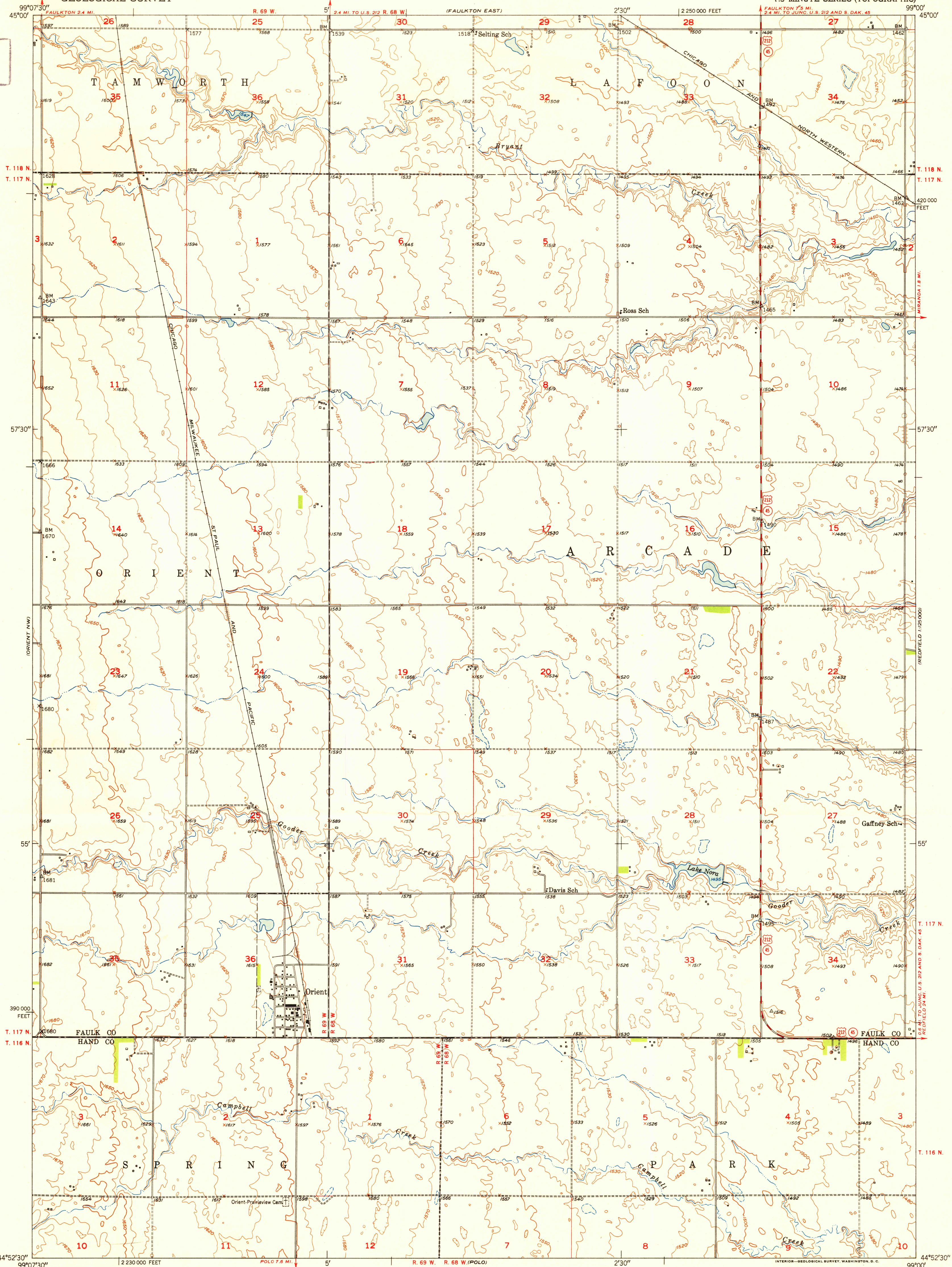

Mapped, edited, and published by the Geological Survey as part of the Department of the Interior program for the development of the Missouri River Basin  
Control by USGS and USC&GS  
Culture and drainage in part compiled from aerial photographs taken 1948  
Topography by plane-table methods 1950  
Polyconic projection. 1927 North American datum  
10,000-foot grid based on South Dakota coordinate system, north zone

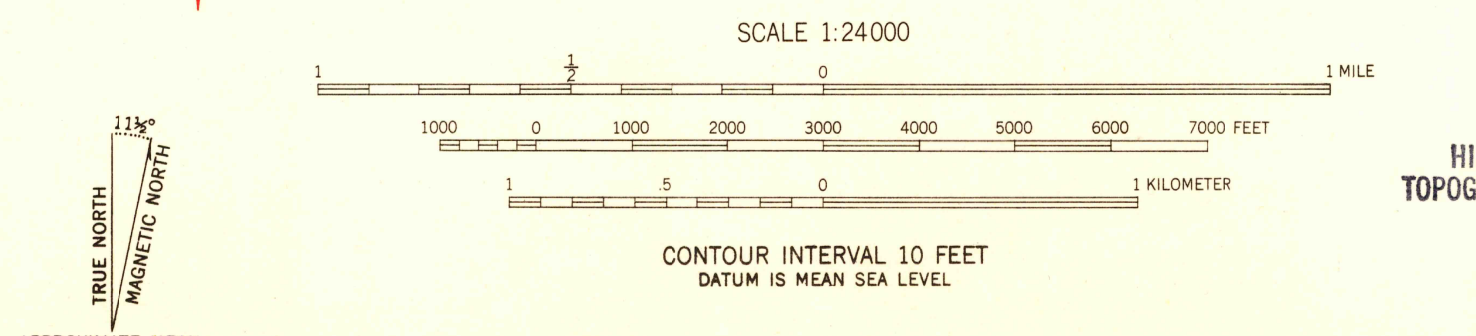

ROAD CLASSIFICATION

Heavy-duty	4 LANE I LANE	Light-duty	Light-duty
Medium-duty	4 LANE I LANE	Unimproved dirt	Unimproved dirt
U. S. Route	U. S. Route	State Route	State Route

U. S. G. S.  
FILE COPY  
Inspection and Editing.

ORIENT, S. DAK.  
N4452.5-W9900/7.5

THIS MAP COMPLIES WITH NATIONAL MAP ACCURACY STANDARDS  
FOR SALE BY U. S. GEOLOGICAL SURVEY, FEDERAL CENTER, DENVER, COLORADO OR WASHINGTON 25, D. C.  
A FOLDER DESCRIBING TOPOGRAPHIC MAPS AND SYMBOLS IS AVAILABLE ON REQUEST