

UNITED STATES  
DEPARTMENT OF THE INTERIOR  
GEOLOGICAL SURVEY

RIDGEVIEW QUADRANGLE  
SOUTH DAKOTA—DEWEY CO.  
7.5 MINUTE SERIES (TOPOGRAPHIC)

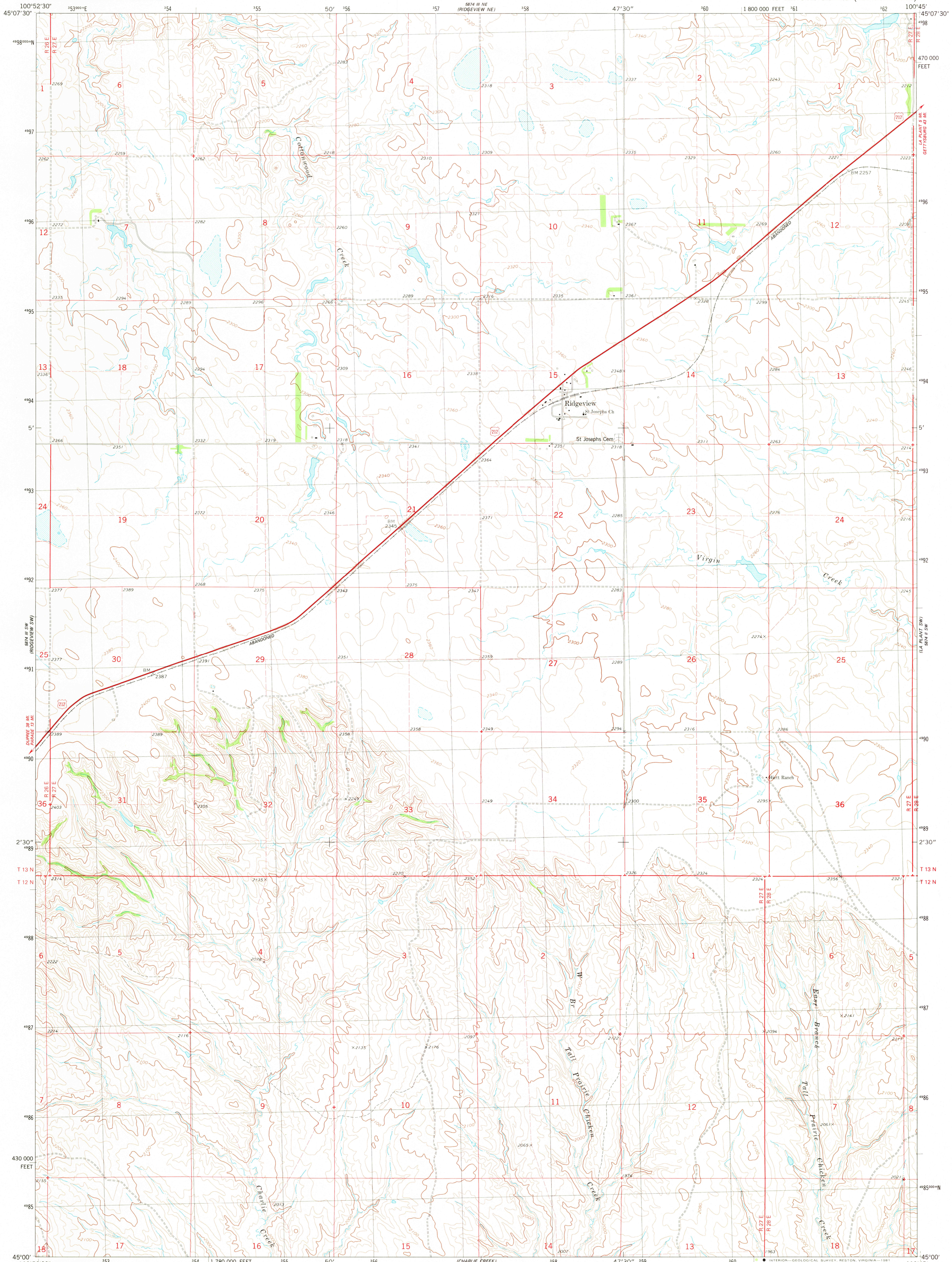

Mapped, edited, and published by the Geological Survey

Control by USGS and NOS/NOAA  
Topography by photogrammetric methods from aerial photographs taken 1974. Field checked 1976. Map edited 1981

Projection and 10,000-foot grid ticks: South Dakota coordinate system, north zone (Lambert conformal conic)  
1000-meter Universal Transverse Mercator grid, zone 14 1927 North American Datum  
To place on the predicted North American Datum 1983 move the projection lines 6 meters north and 35 meters east as shown by dashed corner ticks

There may be private inholdings within the boundaries of the National or State reservations shown on this map  
Entire area lies within the Cheyenne River Indian Reservation  
Fine red dashed lines indicate selected fence and field lines where generally visible on aerial photographs. This information is unchecked

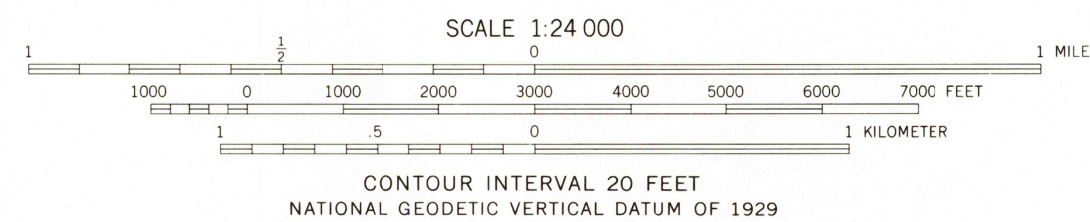
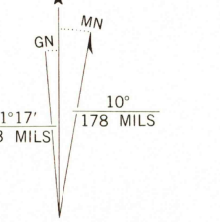

CONTOUR INTERVAL 20 FEET  
NATIONAL GEODETIC VERTICAL DATUM OF 1929



ROAD CLASSIFICATION	
Primary highway, hard surface	Light duty road, hard or improved surface
Secondary highway, hard surface	Unimproved road
Interstate Route	U. S. Route
	State Route

THIS MAP COMPLIES WITH NATIONAL MAP ACCURACY STANDARDS  
FOR SALE BY U. S. GEOLOGICAL SURVEY, DENVER, COLORADO 80225, OR RESTON, VIRGINIA 22092  
A FOLDER DESCRIBING TOPOGRAPHIC MAPS AND SYMBOLS IS AVAILABLE ON REQUEST

USGS  
HISTORICAL PHOTO  
NATIONAL MAPPING DIVISION

RIDGEVIEW, S. DAK.  
N4500-W10045/7.5  
1981  
DMA 5874 III SE—SERIES V873

AUG 3 1981

2000