

5471 I NW
(QUINCY TABLE)

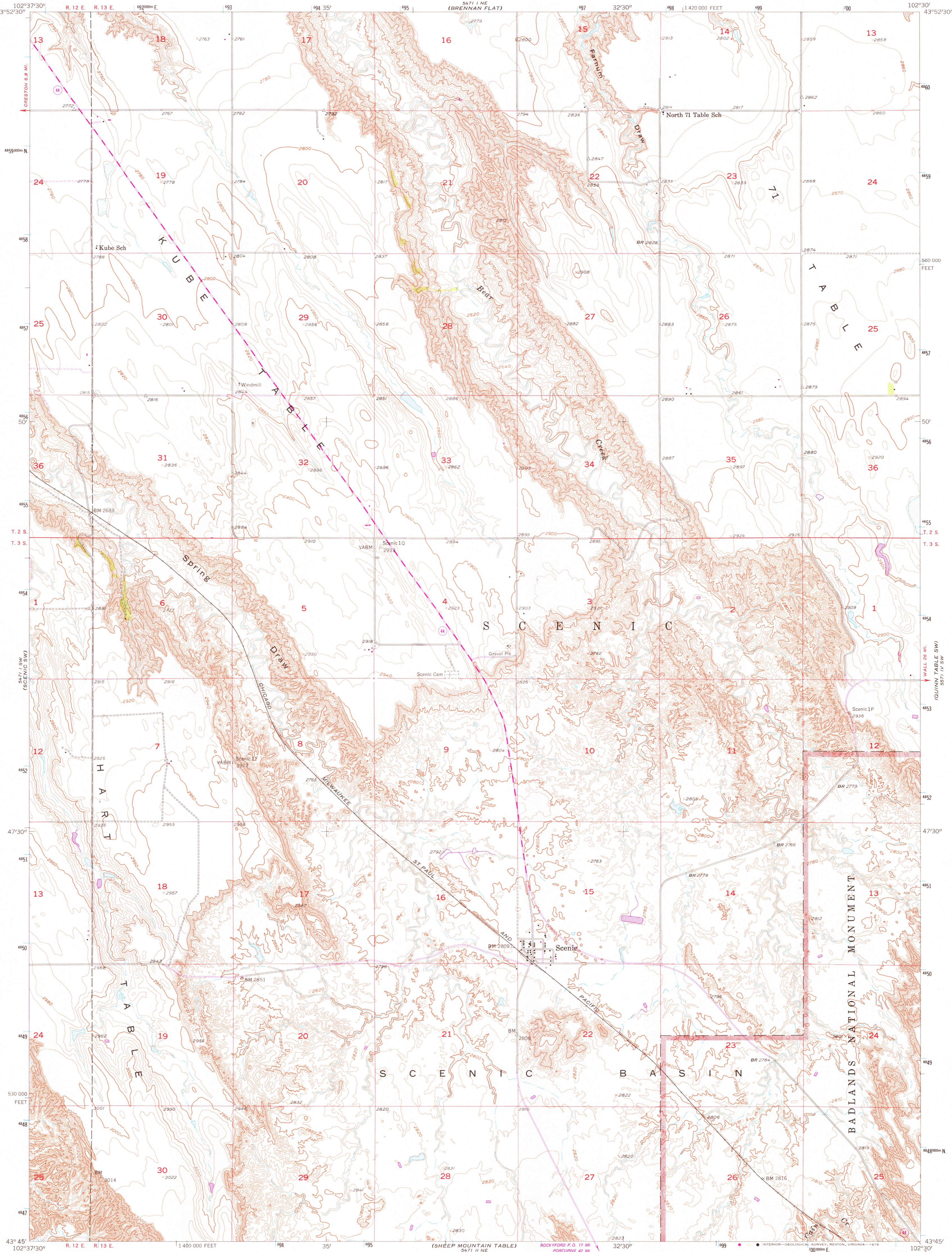

Mapped, edited, and published by the Geological Survey as part of the Department of the Interior program for the development of the Missouri River Basin Control by USGS and USC&GS
Topography from aerial photographs by photogrammetric methods
Aerial photographs taken 1948. Field check 1954
Polyconic projection. 1927 North American datum
10,000-foot grid based on South Dakota coordinate system, south zone
1000-metre Universal Transverse Mercator grid ticks, zone 13, shown in blue
There may be private inholdings within the boundaries of the National or State reservations shown on this map

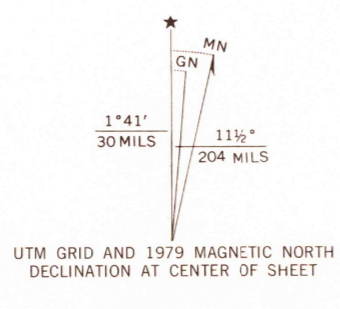

SCALE 1:24,000
1 0 1000 2000 3000 4000 5000 6000 7000 FEET
1 5 0 1 KILOMETRE
CONTOUR INTERVAL 10 FEET
NATIONAL GEODETIC VERTICAL DATUM OF 1929
THIS MAP COMPLIES WITH NATIONAL MAP ACCURACY STANDARDS
FOR SALE BY U.S. GEOLOGICAL SURVEY, DENVER, COLORADO 80225, OR RESTON, VIRGINIA 22092
A FOLDER DESCRIBING TOPOGRAPHIC MAPS AND SYMBOLS IS AVAILABLE ON REQUEST

ROAD CLASSIFICATION
Heavy-duty 4 LANE 16 LANE Light-duty
Medium-duty 2 LANE 16 LANE Unimproved dirt
U.S. Route State Route

SOUTH DAKOTA
QUADRANGLE LOCATION

USGS
Historical File
Topographic Division

SCENIC, S. DAK.
N4345-W10230/7.5
1954
PHOTOREVISED 1979
AMS 5471 I SE—SERIES V873

MAY 14 1979

1800