

(NORTHVILLE 1:25000)

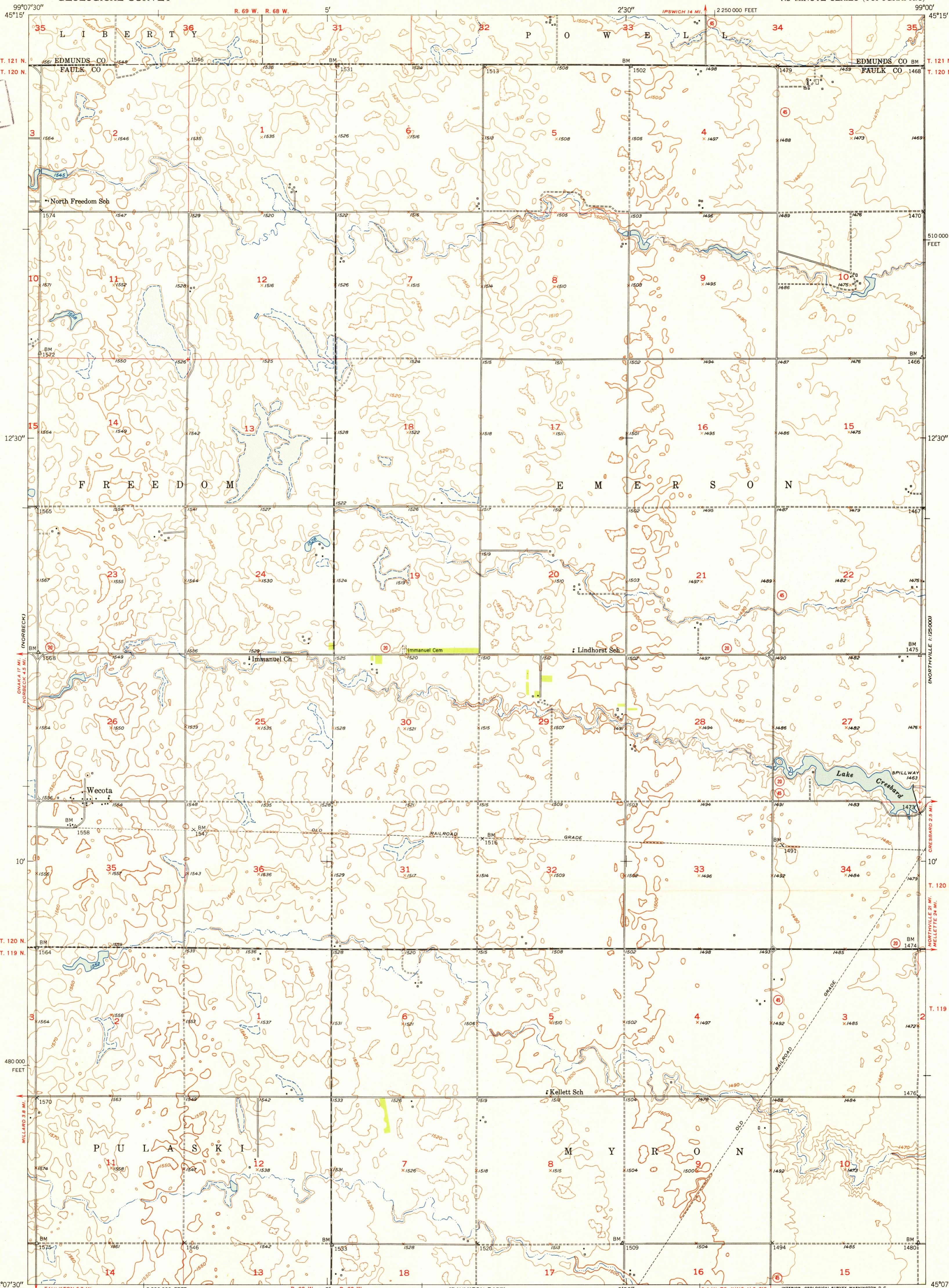

U.S.G.S.
FILE COPY
Inspection and Editing.

Mapped, edited, and published by the Geological Survey as part of the Department of the Interior program for the development of the Missouri River Basin Control by USGS and USC&GS
Culture and drainage in part compiled from aerial photographs taken 1948
Topography by plane-table methods 1950
Polyconic projection. 1927 North American datum
10,000-foot grid based on South Dakota coordinate system, north zone

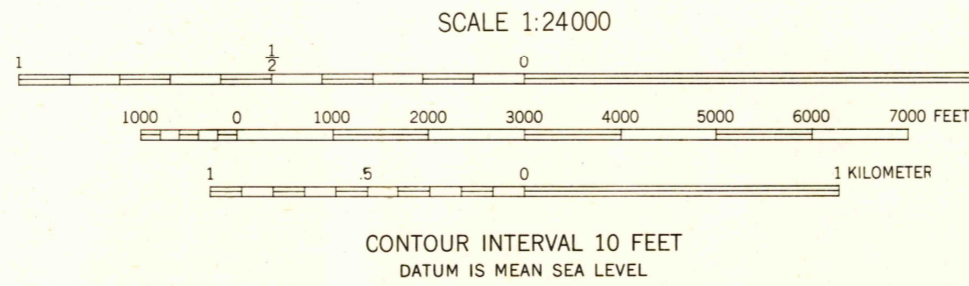
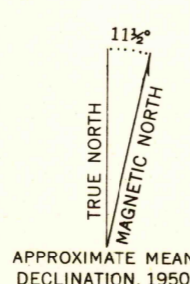

USGS
HISTORICAL FILE
TOPOGRAPHIC DIVISION

ROAD CLASSIFICATION

| | | | |
|-------------|----------------|-----------------|----------------|
| Heavy-duty | 4 LANE 16 LANE | Light-duty | 2 LANE 16 LANE |
| Medium-duty | 4 LANE 16 LANE | Unimproved dirt | |
| U. S. Route | □ | State Route | ○ |

U.S.G.S.
FILE COPY
Inspection and Editing.

WECOTA, S. DAK.
N4507.5-W9900/7.5
EDITION OF 1952

THIS MAP COMPLIES WITH NATIONAL MAP ACCURACY STANDARDS
FOR SALE BY U. S. GEOLOGICAL SURVEY, FEDERAL CENTER, DENVER, COLORADO OR WASHINGTON 25, D. C.
A FOLDER DESCRIBING TOPOGRAPHIC MAPS AND SYMBOLS IS AVAILABLE ON REQUEST