

Mapped and edited by Tennessee Valley Authority  
Published by the Geological Survey

Control by USCG&S, USGS, and TVA

Topography by USGS and TVA by multiplex methods from aerial  
photographs taken 1944. Field examination by TVA, 1948

Polyconic projection. 1927 North American datum  
10,000-foot grid based on Tennessee rectangular  
coordinate system

1000-meter Universal Transverse Mercator grid ticks,  
zone 16, shown in purple

Grid declination 0°02', 1 mi. West

Revisions in purple compiled by TVA, November 1966  
from March 1966 photography without field examination

TRUE NORTH  
MAGNETIC NORTH  
APPROXIMATE MEAN  
DECLINATION 1948  
1956

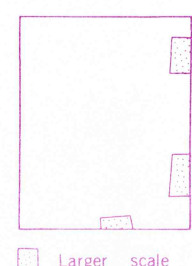

Larger scale  
topographic maps  
available from



SCALE 1:24,000  
CONTOUR INTERVAL 20 FEET  
DASHED LINES REPRESENT HALF-INTERVAL CONTOURS  
DATUM IS MEAN SEA LEVEL

THIS MAP COMPLIES WITH NATIONAL MAP ACCURACY STANDARDS  
FOR SALE BY U. S. GEOLOGICAL SURVEY, RESTON, VIRGINIA 22092  
AND BY U. S. TENNESSEE VALLEY AUTHORITY, CHATTANOOGA, TENN. 37401 OR KNOXVILLE, TENN. 37902  
A FOLDER DESCRIBING TOPOGRAPHIC MAPS AND SYMBOLS IS AVAILABLE ON REQUEST

LEGEND

- Fence and field line
- Stream
- Pond and dam
- Mine or quarry
- Woodland (formerly clearing)
- Clearing (formerly woodland)
- General deletion
- Light-duty road
- Poor motor road
- Wagon and jeep track
- Foot trail

- ROUTES USUALLY TRAVELED
- HARD, IMPERVIOUS SURFACES
- OTHER SURFACE IMPROVEMENTS
- U. S. ROUTE
- STATE ROUTE

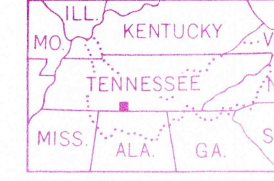

ASPEN HILL, TENN.  
N3500-W8700/7.5

USGS 1948  
Historical File  
Topographic Division

MAY 22 1974  
59-SE  
AMS 3554 II SE-SERIES V041