

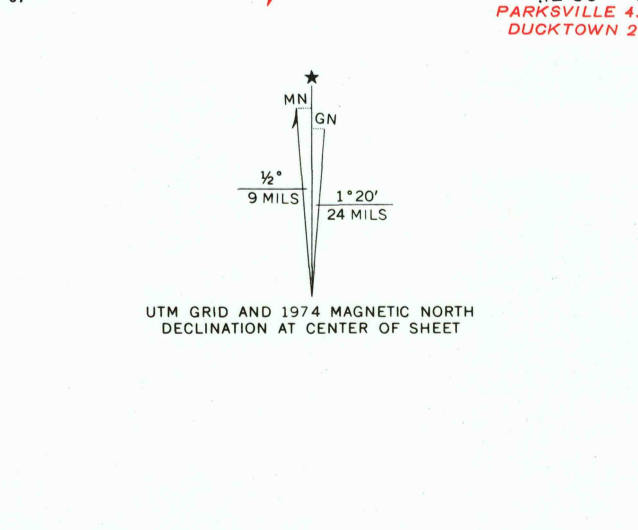

Maped and edited by Tennessee Valley Authority  
Published by the Geological Survey  
Control by NOS/NOAA, USGS, and TVA  
Revised by TVA in 1965 by photogrammetric methods using  
aerial photographs taken 1965 and by reference to TVA-USGS  
quadrangle dated 1940. Map field checked by TVA, 1967  
Polyconic projection. 1927 North American datum  
10,000 foot grid based on Tennessee rectangular  
coordinate system  
1000 metre Universal Transverse Mercator Grid ticks,  
Zone 16, shown in blue  
Fine red dashed lines indicate selected fence and field lines  
visible on aerial photographs. This information is unchecked  
Revisions shown in purple and recompilation of woodland  
areas compiled by the Tennessee Valley Authority from aerial  
photographs taken 1974. This information not field checked



ROAD CLASSIFICATION  
Heavy-duty ..... Poor motor road .....  
Medium-duty ..... Wagon and jeep track .....  
Light-duty ..... Foot trail .....  
U.S. Route ..... State Route .....  
In developed areas, only through roads are classified

QUADRANGLE LOCATION  
MO. KY. VA.  
TENN. NC.  
MISS. ALA. GA. S.C.

BENTON, TENN.  
N3507.5-W8437.5/7.5  
1967  
PHOTOREVISED 1974  
AMS 4054 II NW-SERIES V841

