

DEPARTMENT OF THE INTERIOR
FRANKLIN K. LANE, SECRETARY
U. S. GEOLOGICAL SURVEY
GEORGE OTIS SMITH, DIRECTOR

TOPOGRAPHY

HARRIS COUNTY, TEXAS

W. H. WARD, COUNTY JUDGE
W. H. LLOYD, J. A. SMITH, W. H. KISER, D. BARKER
COUNTY COMMISSIONERS

Advance sheet.
Subject to correction.

INSPECTION FILES
TOPOGRAPHY.

TEXAS
HARRIS COUNTY
ALMEDA QUADRANGLE

RETURN TO:
USGS MID HISTORICAL MAP ARCHIVES

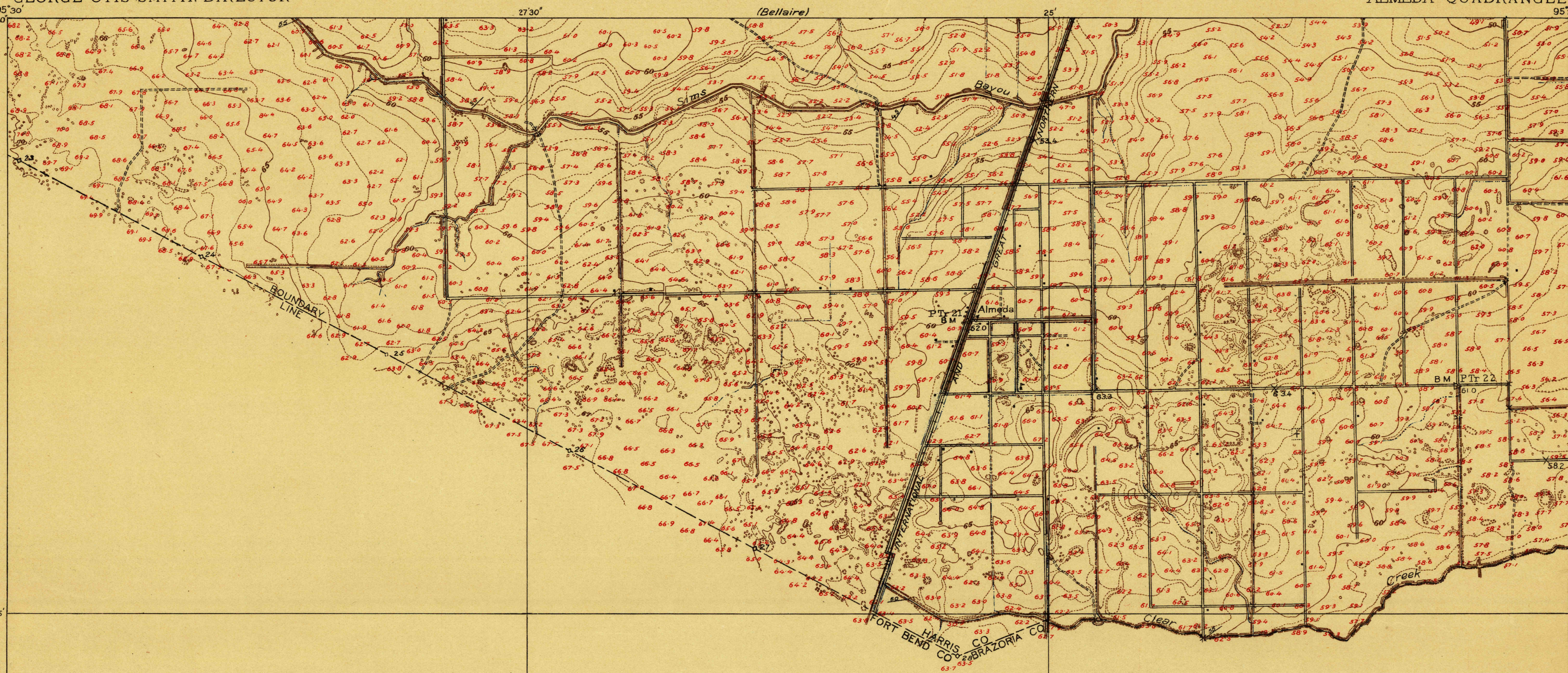

R. B. Marshall, Chief Geographer
Sledge Tatum, Geographer in charge
Topography by C. A. Stonesifer
Control by E. L. McNair and R. R. Monbeck
Surveyed in 1915

SURVEYED IN COOPERATION WITH HARRIS COUNTY, TEXAS

Scale $\frac{1}{24000}$



Contour interval 1 foot
Datum is mean sea level

TRUE NORTH
MAGNETIC NORTH
APPROXIMATE MEAN
DECLINATION 1915

Almeda, Tex.