

NATIONS SOUTH WELL

UNITED STATES  
DEPARTMENT OF THE INTERIOR  
GEOLOGICAL SURVEY

UNITED STATES  
DEPARTMENT OF THE ARMY  
CORPS OF ENGINEERS

CLINT NE QUADRANGLE  
TEXAS-EL PASO CO  
7.5 MINUTE SERIES (TOPOGRAPHIC)  
NE 1/4 CLINT 15' QUADRANGLE

HUECO MTS  
1:62,500

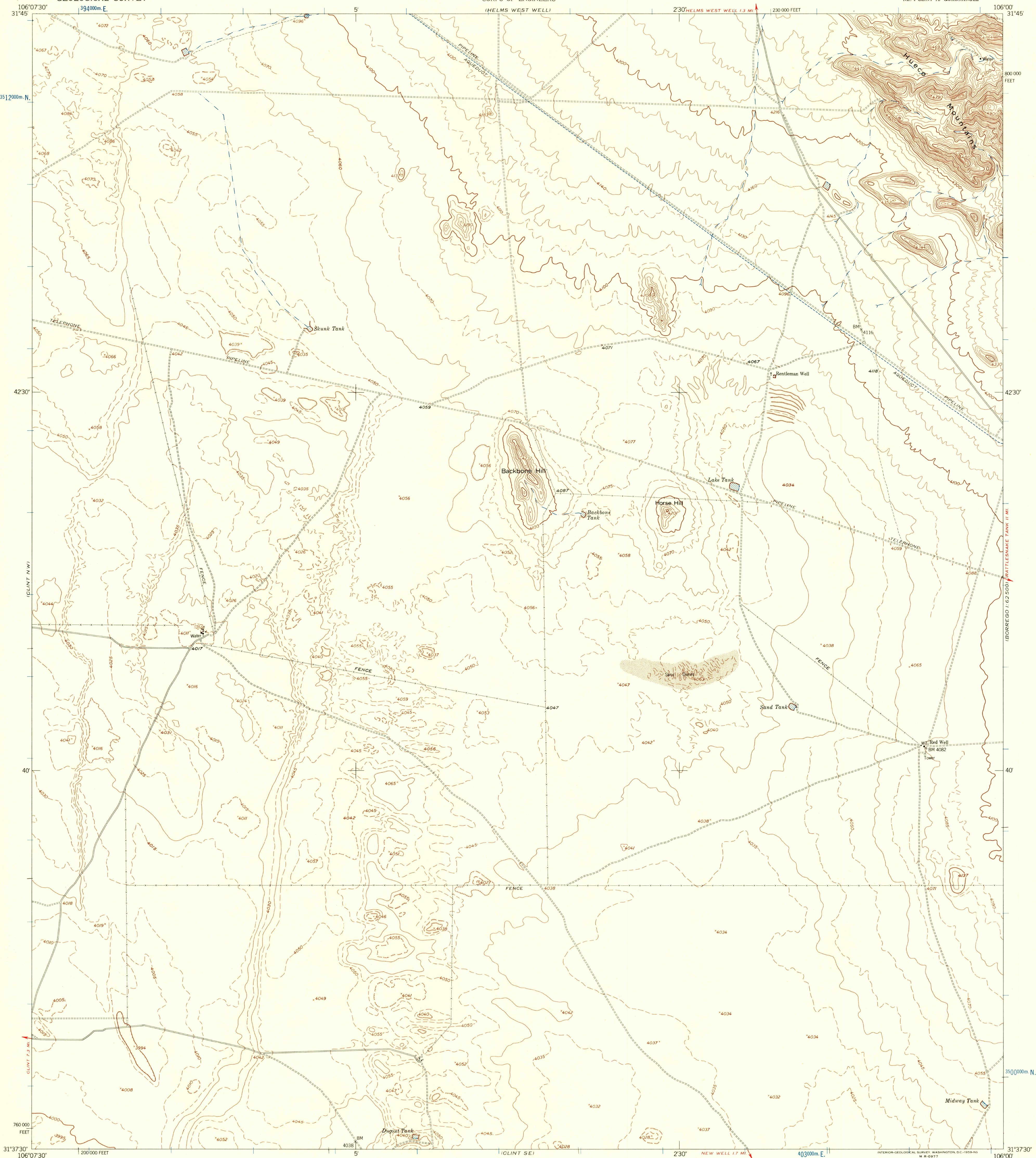

Mapped by the Army Map Service  
Published for civil use by the Geological Survey  
Control by USGS, USC&GS, and USCE  
Topography from aerial photographs by photogrammetric methods  
Aerial photographs taken 1954. Photography field annotated 1955  
Polyconic projection. 1927 North American datum  
10,000-foot grid based on Texas coordinate system,  
central zone  
1000-meter Universal Transverse Mercator grid ticks,  
zone 13, shown in blue  
Unchecked elevations are shown in brown

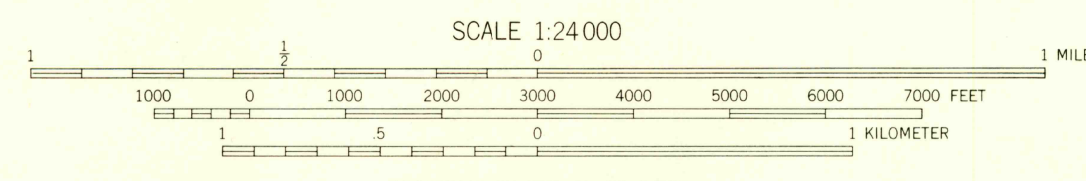
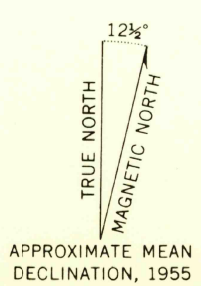

CONTOUR INTERVAL 20 FEET  
DASHED LINES REPRESENT 5 AND 10-FOOT CONTOURS  
DATUM IS MEAN SEA LEVEL

THIS MAP COMPLIES WITH NATIONAL MAP ACCURACY STANDARDS  
FOR SALE BY U.S. GEOLOGICAL SURVEY, DENVER 25, COLORADO OR WASHINGTON 25, D. C.  
A FOLDER DESCRIBING TOPOGRAPHIC MAPS AND SYMBOLS IS AVAILABLE ON REQUEST



ROAD CLASSIFICATION  
Light-duty ——— Unimproved dirt - - - - -

U.S.G.S.  
FILE COPY  
TOPOGRAPHIC DIVISION

CLINT NE, TEX.  
NE 1/4 CLINT 15' QUADRANGLE  
N3137.5-W10600/7.5

1955

DEC - 4 1959

2560