

Page 11 of 12 (Facing West)

UNITED STATES DEPARTMENT OF THE INTERIOR GEOLOGICAL SURVEY

COBURN QUADRANGLE TEXAS 7.5 MINUTE SERIES (TOPOGRAPHIC)

5956 II NE (HIGGINS NORTH)

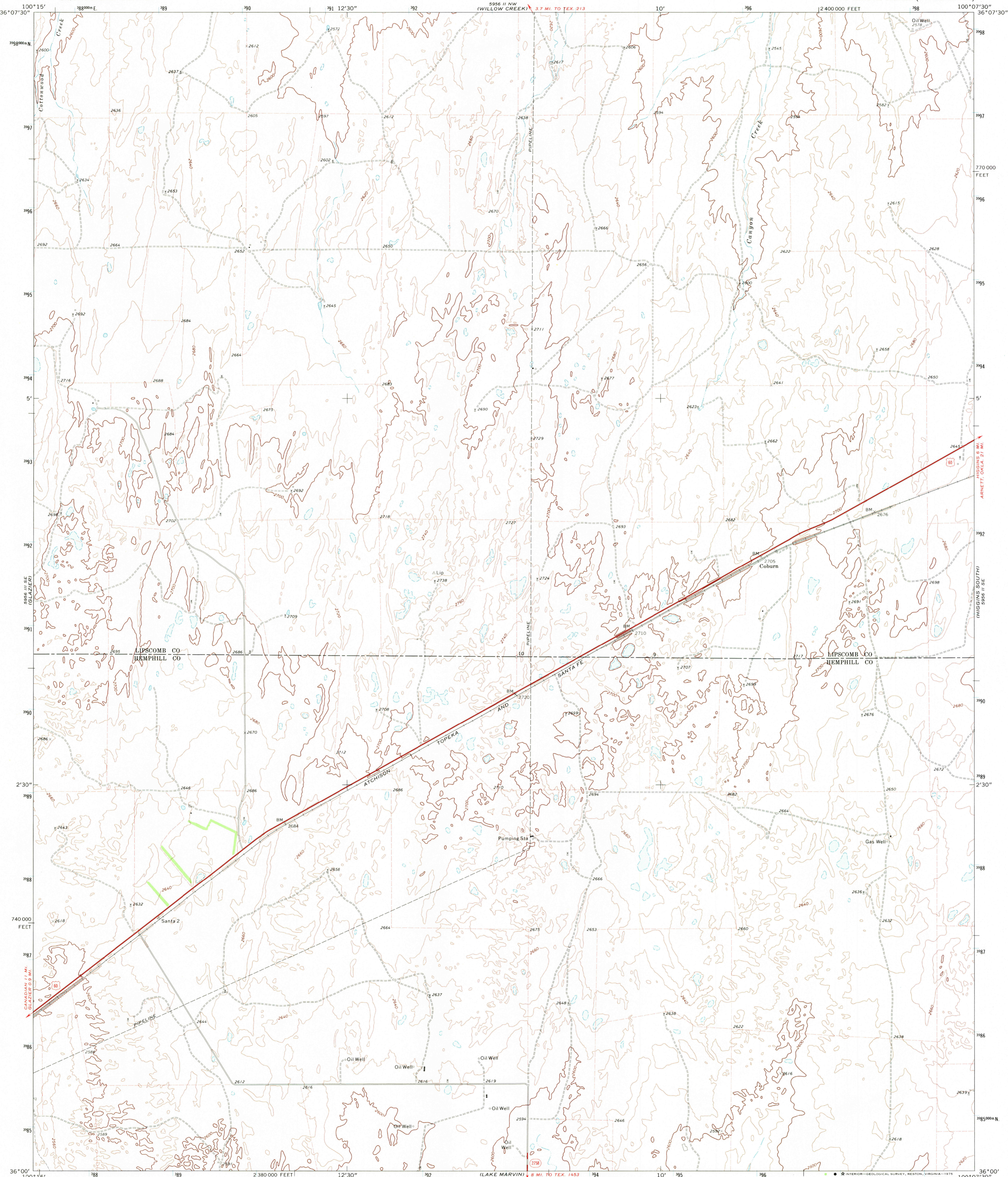

Mapped, edited, and published by the Geological Survey  
Control by USGS and USC&GS  
Topography by photogrammetric methods from aerial photographs taken 1971. Field checked 1972  
Projection and 10,000-foot grid ticks: Texas coordinate system, north zone (Lambert conformal conic); 1000-meter Universal Transverse Mercator grid ticks, zone 14, shown in blue. 1927 North American datum  
Fine red dashed lines indicate selected fence lines

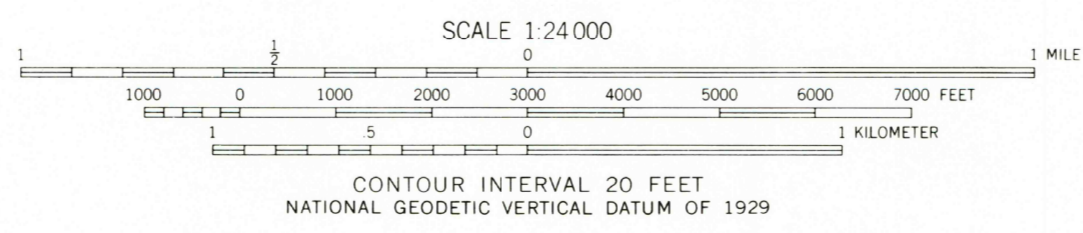
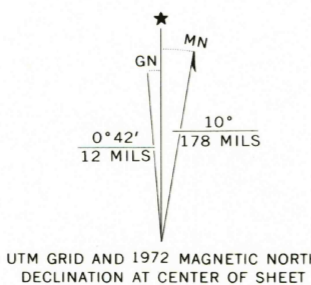

ROAD CLASSIFICATION

Primary highway, hard surface	Light-duty road, hard or improved surface
Secondary highway, hard surface	Unimproved road
Interstate Route	U. S. Route
	State Route

THIS MAP COMPLIES WITH NATIONAL MAP ACCURACY STANDARDS  
FOR SALE BY U. S. GEOLOGICAL SURVEY, DENVER, COLORADO 80225, OR RESTON, VIRGINIA 22092  
A FOLDER DESCRIBING TOPOGRAPHIC MAPS AND SYMBOLS IS AVAILABLE ON REQUEST

USGS HISTORICAL FILE TOPOGRAPHIC DIVISION

COBURN, TEX. JAN 31 1975  
1972

AMS 5956 II SW-SERIES V382

3400