

Advance sheet
Subject to correction

COMBES, TEXAS

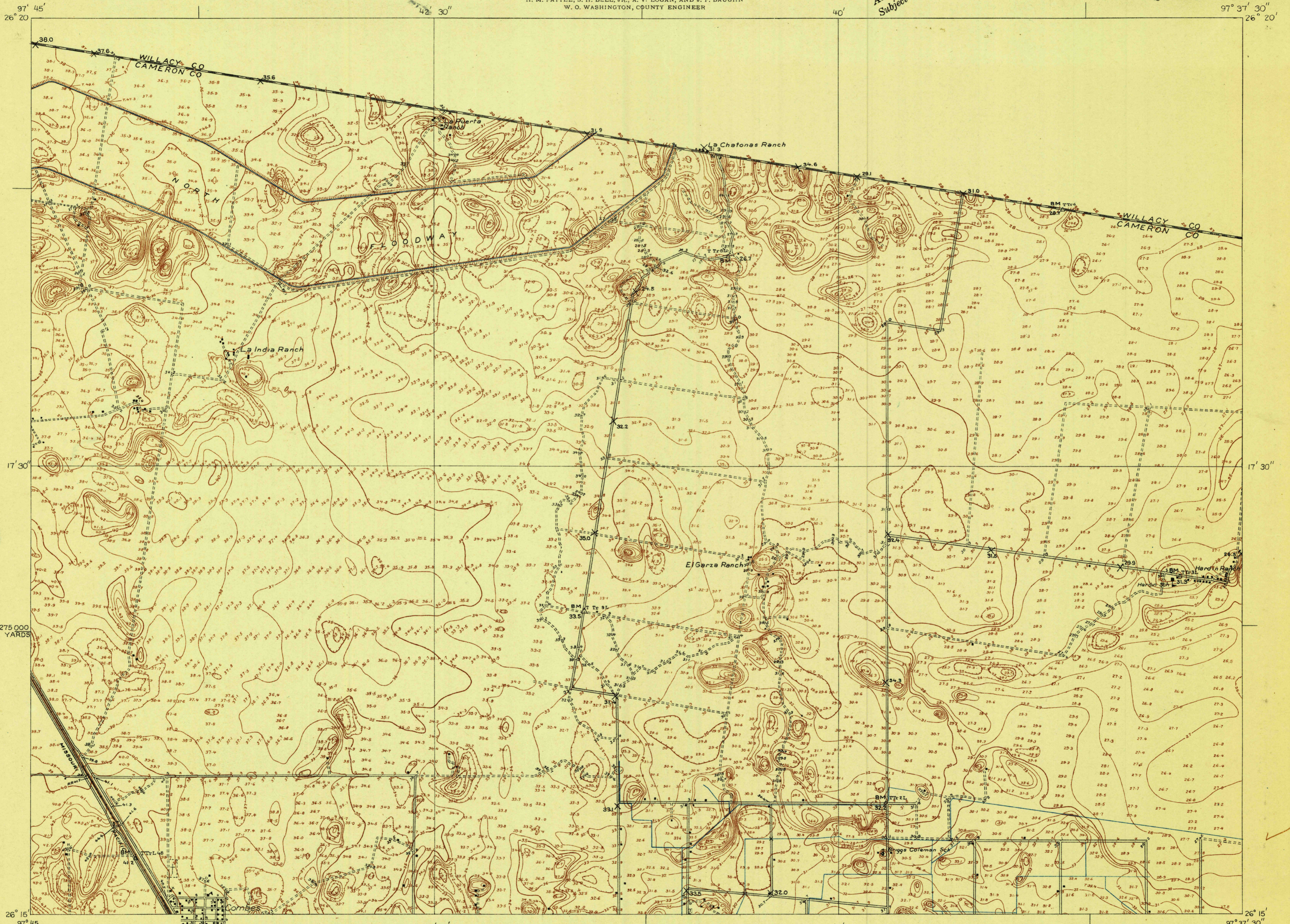

H. H. Hodgeson, Division Engineer
Topography by W.R. Chenoweth and H.S. Milsted
Culture and drainage in part compiled from aerial photographs
Control by U. S. Geological Survey, U. S. Coast and Geodetic Survey
and Texas Reclamation Department
Surveyed in 1929

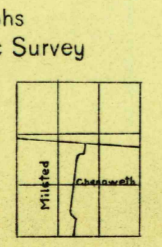

TRUE NORTH
MAGNETIC NORTH
APPROXIMATE MEAN
DECLINATION, 1929

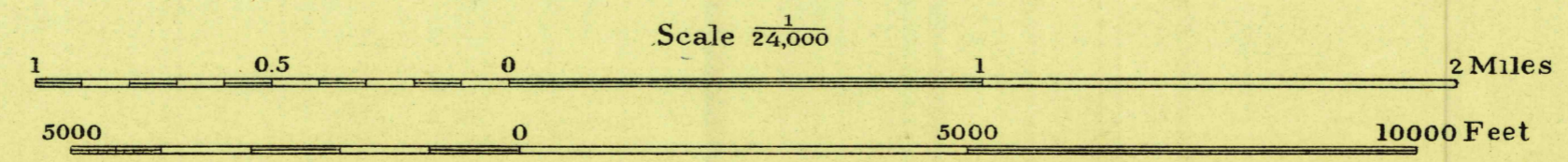

Contour interval 1 foot
Datum is mean sea level

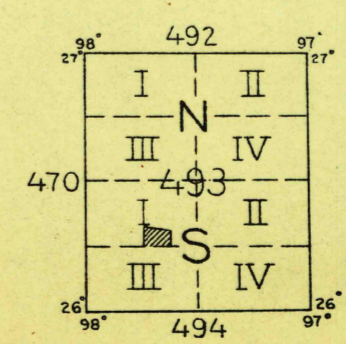

FILE COPY
MAP INFORMATION OFFICE
GEOLOGICAL SURVEY

Polyconic projection. North American datum
5000 yard grid based upon U. S. zone system, D

COMBES, TEXAS.

RETURN TO:
USGS NHD HISTORICAL MAP ARCHIVES

(ENGR. but keep for obs)