

UNITED STATES
DEPARTMENT OF THE INTERIOR
GEOLOGICAL SURVEY

CONCORDIA QUADRANGLE
TEXAS
7.5 MINUTE SERIES (TOPOGRAPHIC)
SW/4 PETRONILA 15' QUADRANGLE

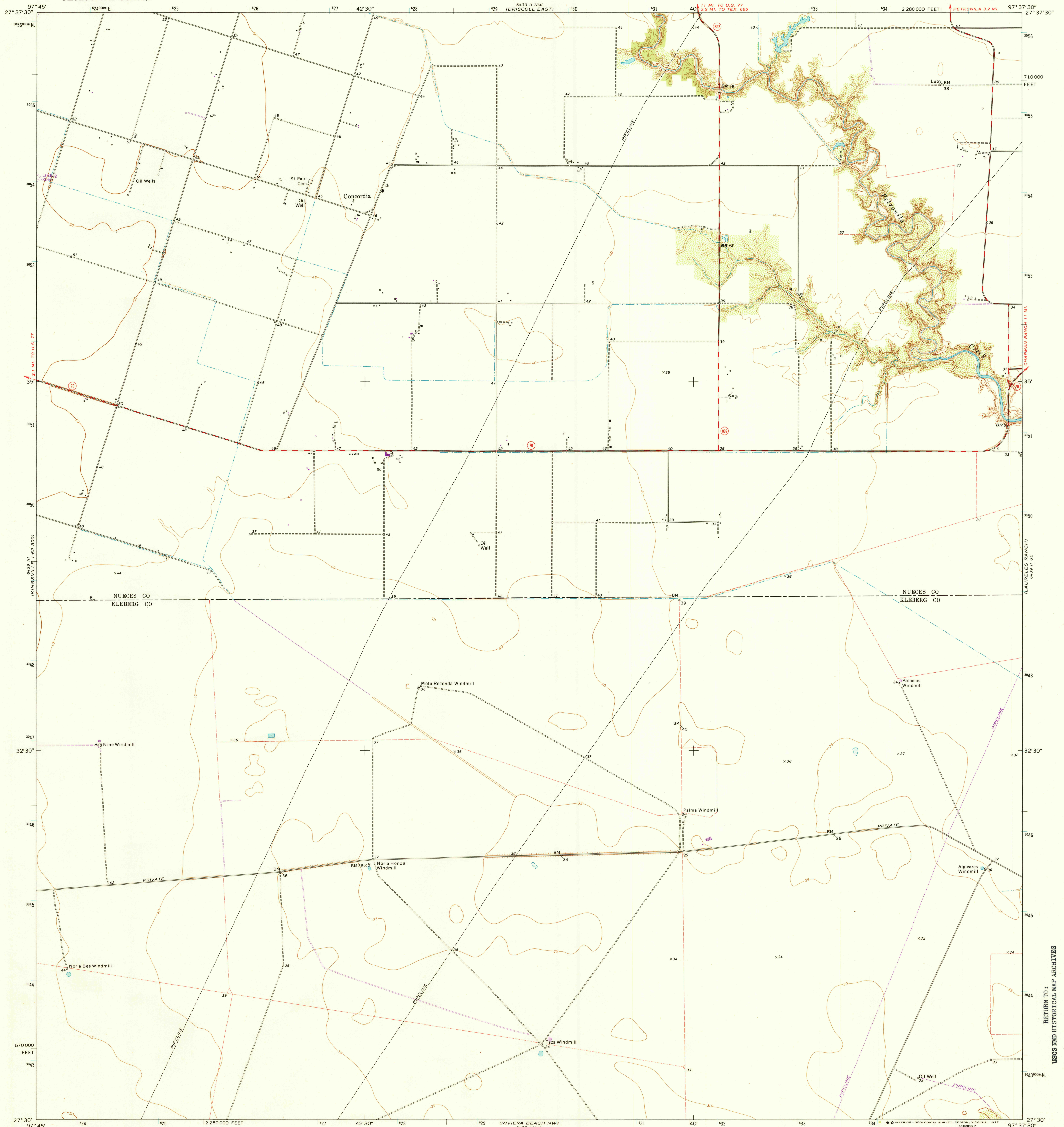

Mapped, edited, and published by the Geological Survey

Control by USGS and NOS/NOAA

Topography by photogrammetric methods from aerial photographs taken 1968. Field checked 1969

Polyconic projection. 1927 North American datum 10,000-foot grid based on Texas coordinate system, south zone

1000-meter Universal Transverse Mercator grid ticks, zone 14, shown in blue

Fine red dashed lines indicate selected fence lines

Revisions shown in purple compiled from aerial photographs taken 1975. This information not field checked

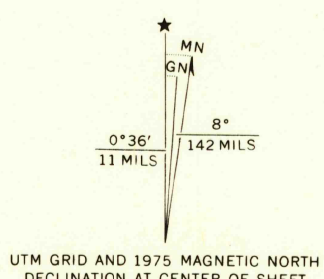

UTM GRID AND 1975 MAGNETIC NORTH DECLINATION AT CENTER OF SHEET

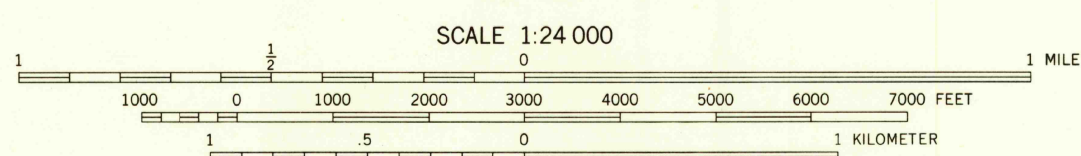

SCALE 1:24 000
CONTOUR INTERVAL 5 FEET
NATIONAL GEODETIC VERTICAL DATUM OF 1929

THIS MAP COMPLIES WITH NATIONAL MAP ACCURACY STANDARDS
FOR SALE BY U. S. GEOLOGICAL SURVEY, DENVER, COLORADO 80225, OR RESTON, VIRGINIA 22092
A FOLDER DESCRIBING TOPOGRAPHIC MAPS AND SYMBOLS IS AVAILABLE ON REQUEST



QUADRANGLE LOCATION

ROAD CLASSIFICATION

Primary highway, hard surface	Light-duty road, hard or improved surface
Secondary highway, hard surface	Unimproved road
Interstate Route	U. S. Route
	State Route

AUG 15 1977

CONCORDIA, TEX.
SW/4 PETRONILA 15' QUADRANGLE
N2730—W9737.5/7.5

1969
PHOTOREVISED 1975
AMS 6439 II SW—SERIES V882

RETURN TO:
USGS AND HISTORICAL MAP ARCHIVES

2770