

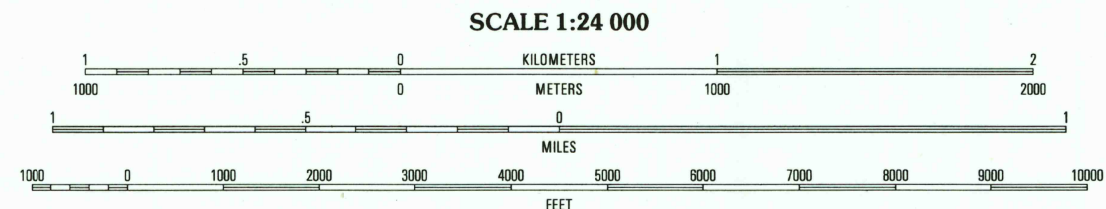

Produced by the United States Geological Survey Topography compiled 1987. Planimetry derived from imagery taken 1995. Survey control current as of 1990. North American Datum of 1983 (NAD 83). Projection and 1000-meter grid: Universal Transverse Mercator, zone 15 10 000-foot ticks: Texas Coordinate System of 1983 (south central zone). North American Datum of 1927 (NAD 27) is shown by dashed corner ticks. The values of the shift between NAD 83 and NAD 27 for 7.5-minute intersections are obtainable from National Geodetic Survey NADCON software. Landmark buildings verified 1990.

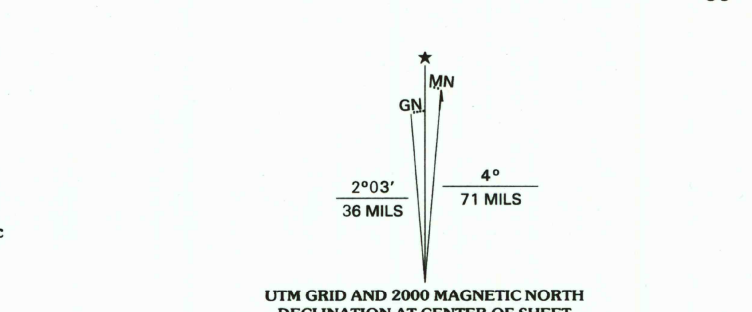

SCALE 1:24 000 CONTOUR INTERVAL 5 FEET NATIONAL GEODETIC VERTICAL DATUM OF 1929 THE MEAN RANGE OF TIDE IS APPROXIMATELY 1 FOOT TO CONVERT FROM FEET TO METERS, MULTIPLY BY 0.3048



QUADRANGLE LOCATION 2994-331

Table with 8 columns and 2 rows. Row 1: 1, 2, 3, 4, 5, 6, 7, 8. Row 2: 1 Shanks, 2 Moss Bluff, 3 Shiloh, 4 Mount Belkieu, 5 Anahouse, 6 Morgan Point, 7 Umbrella Point, 8 Oak Island.

ROAD CLASSIFICATION Primary highway hard surface, Secondary highway hard surface, Light-duty road, hard or improved surface, Unimproved road, Interstate Route, U.S. Route, State Route

RECEIVED AUG 31 2000

HISTORICAL MAP ARCHIVES

COVE, TX 1995

NIMA 7043 IV SE-SERIES V882

THIS MAP COMPLIES WITH NATIONAL MAP ACCURACY STANDARDS FOR SALE BY U.S. GEOLOGICAL SURVEY, P.O. BOX 25286, DENVER, COLORADO 80225 A FOLDER DESCRIBING TOPOGRAPHIC MAPS AND SYMBOLS IS AVAILABLE ON REQUEST

