

328 1/2 SW
5/29 1/4 SW
6/21 1/4 SW

UNITED STATES
DEPARTMENT OF THE INTERIOR
GEOLOGICAL SURVEY

STATE OF TEXAS
TEXAS WATER DEVELOPMENT BOARD

CUYLER QUADRANGLE
TEXAS-CARSON CO.
7.5 MINUTE SERIES (TOPOGRAPHIC)

5/29 1/4 SW
(REL. TO TOWN)

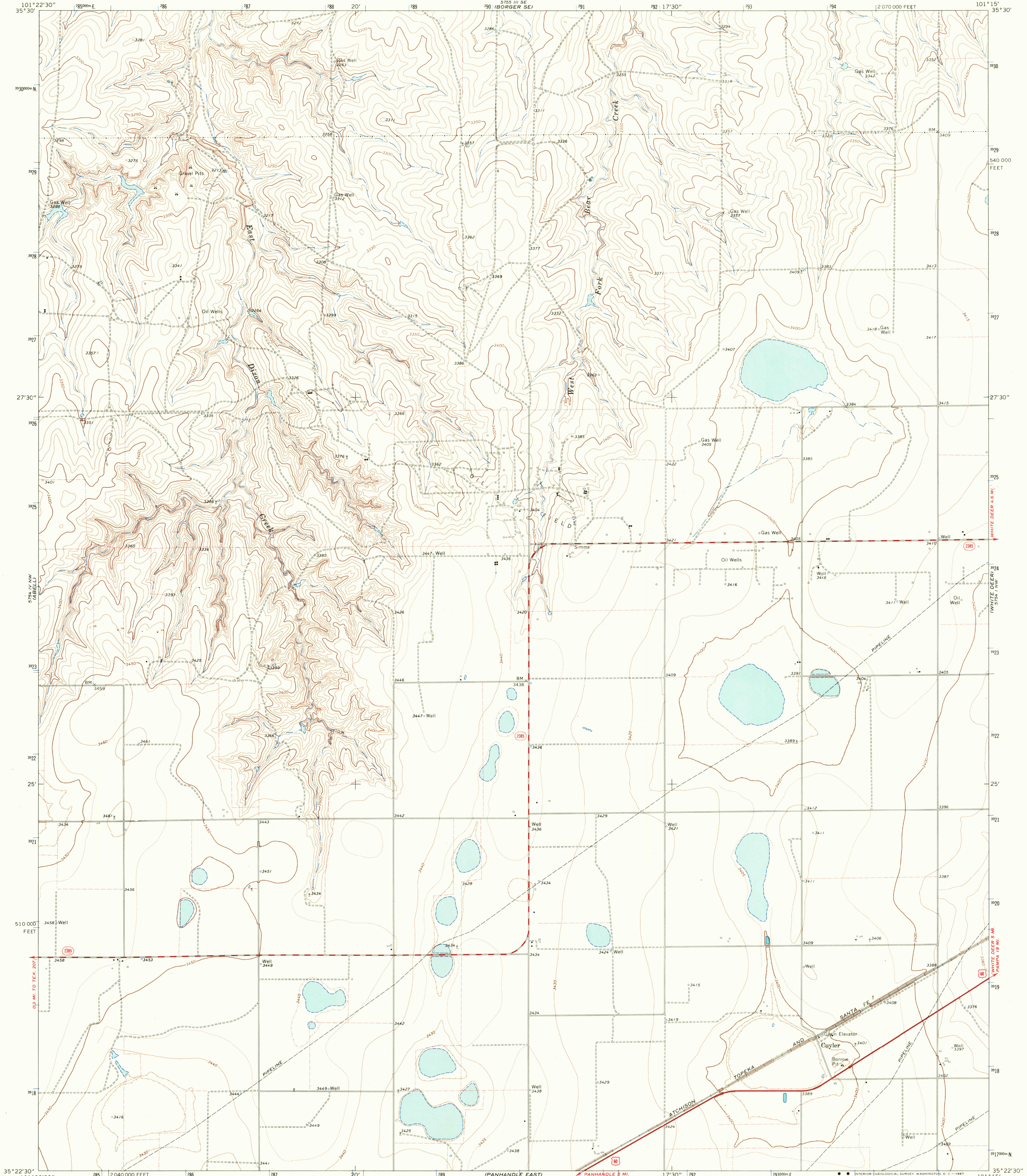

Mapped, edited, and published by the Geological Survey
Control by USGS and USC&GS
Topography by photogrammetric methods from aerial
photographs taken 1962 and planetable surveys 1966
Polyconic projection. 1927 North American datum
10,000-foot grid based on Texas coordinate system,
north zone
1000-meter Universal Transverse Mercator grid ticks,
zone 14, shown in blue
Fine red dashed lines indicate selected fence lines

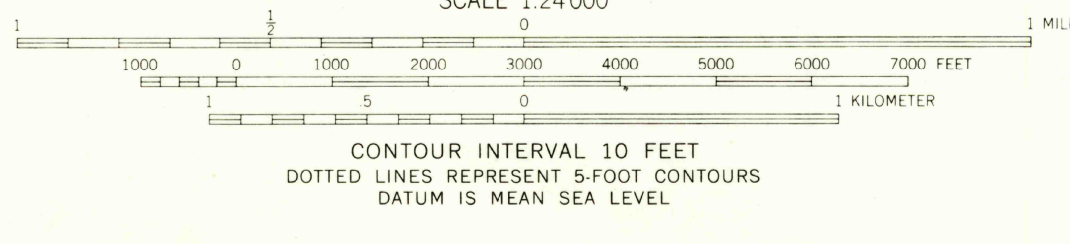
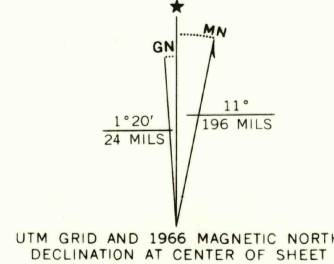

ROAD CLASSIFICATION	
Heavy-duty	Light-duty
Medium-duty	Unimproved dirt
U.S. Route	State Route

U.S.G.S.
FINE COPY
TOPOGRAPHIC DIVISION

THIS MAP COMPLIES WITH NATIONAL MAP ACCURACY STANDARDS
FOR SALE BY U.S. GEOLOGICAL SURVEY, DENVER, COLORADO 80225, OR WASHINGTON, D.C. 20242
A FOLDER DESCRIBING TOPOGRAPHIC MAPS AND SYMBOLS IS AVAILABLE ON REQUEST

CUYLER, TEX.
N3522.5-W10115.7.5
1966
2790
MAR 21 1968

AMS 5754 IV NE-SERIES V8R2