

5655 IV NE (CACTUS EAST)

UNITED STATES DEPARTMENT OF THE INTERIOR GEOLOGICAL SURVEY

STATE OF TEXAS TEXAS WATER DEVELOPMENT BOARD

DUMAS NE QUADRANGLE TEXAS—MOORE CO. 7.5 MINUTE SERIES (TOPOGRAPHIC)

5655 IV SW (CACTUS SW)

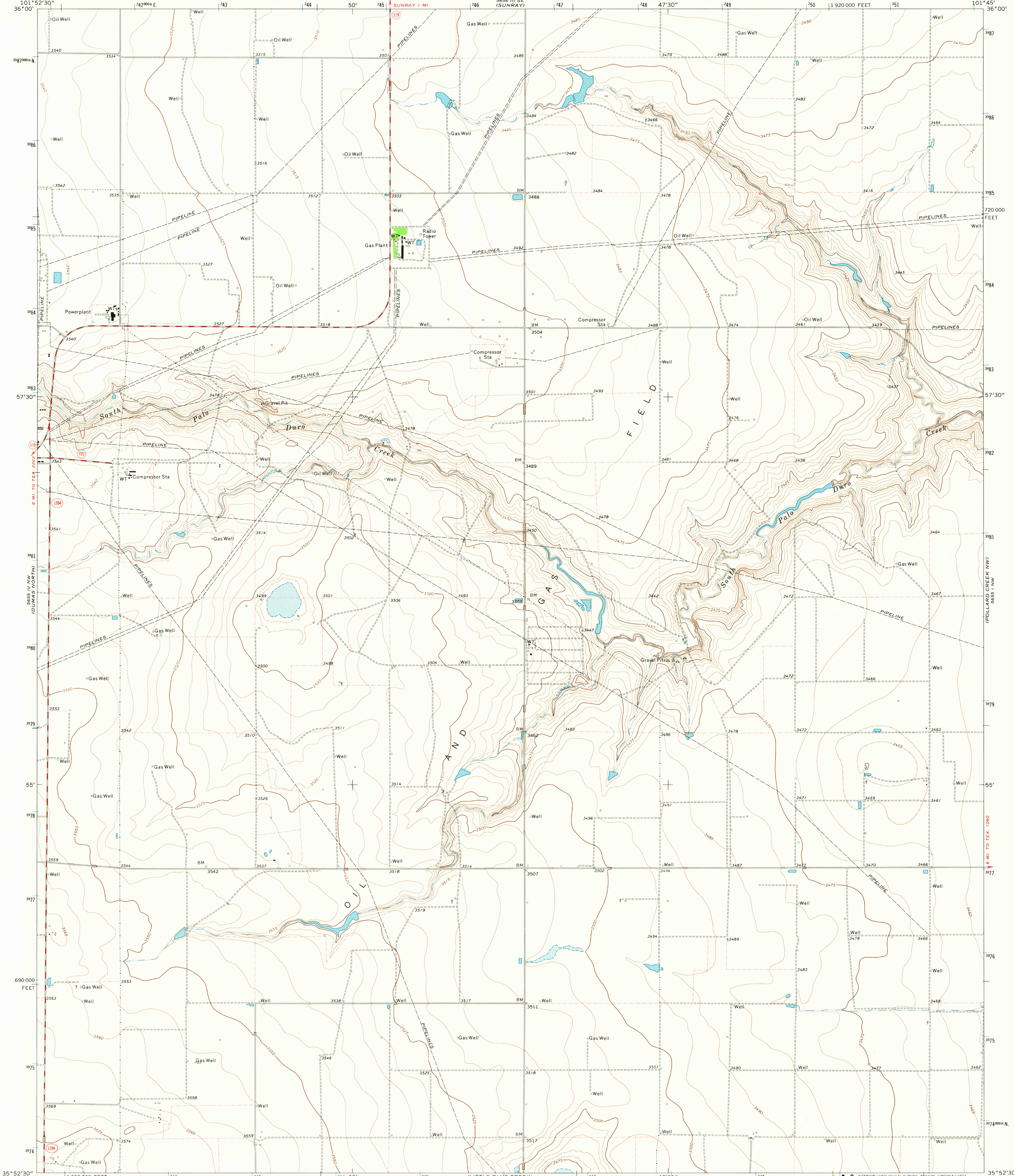

Mapped, edited, and published by the Geological Survey Control by USGS and USC&GS Topography by photogrammetric methods from aerial photographs taken 1971. Field checked 1972 Projection and 10,000-foot grid ticks: Texas coordinate system, north zone (Lambert conformal conic) 1000-meter Universal Transverse Mercator grid ticks, zone 14, shown in blue. 1927 North American datum Fine red dashed lines indicate selected fence lines

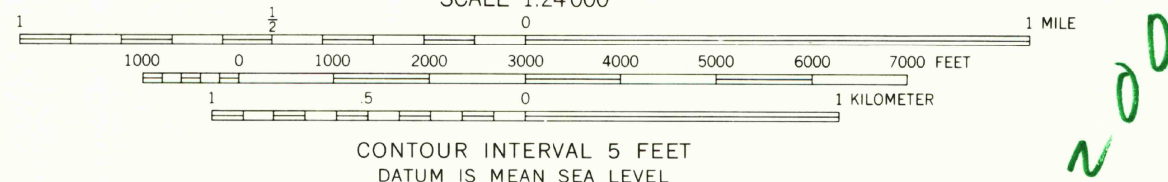
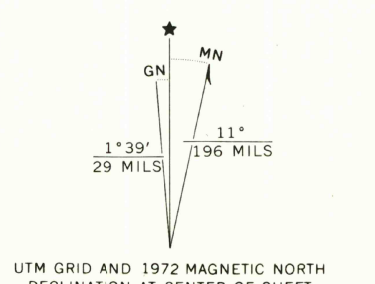

CONTOUR INTERVAL 5 FEET DATUM IS MEAN SEA LEVEL



ROAD CLASSIFICATION

Primary highway, hard surface	Light duty road, hard or improved surface
Secondary highway, hard surface	Unimproved road
Interstate Route	U. S. Route
	State Route

THIS MAP COMPLIES WITH NATIONAL MAP ACCURACY STANDARDS FOR SALE BY U. S. GEOLOGICAL SURVEY, DENVER, COLORADO 80225, OR RESTON, VIRGINIA 22092 A FOLDER DESCRIBING TOPOGRAPHIC MAPS AND SYMBOLS IS AVAILABLE ON REQUEST

USGS Historical File Topographic Division

DUMAS NE, TEX. N3552.5-W10145.7.5 1972

AMS 5655 IV NE—SERIES V882

OCT 2 4 1974