

UNITED STATES
DEPARTMENT OF THE INTERIOR
GEOLOGICAL SURVEY

GEDDIS CANYON EAST QUADRANGLE
TEXAS
7.5 MINUTE SERIES (TOPOGRAPHIC)

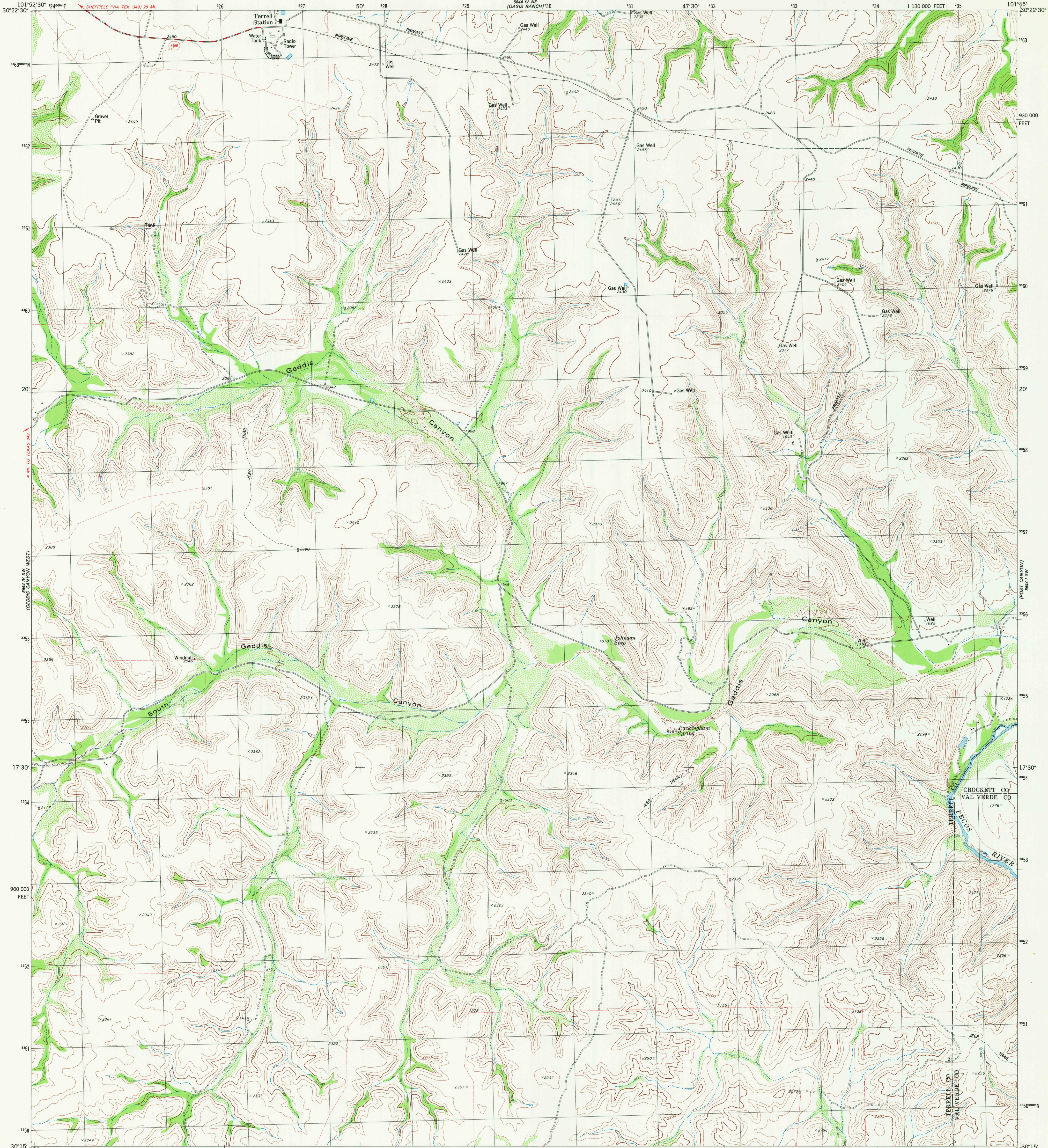

Mapped, edited, and published by the Geological Survey

Control by USGS and NOS/NOAA
Topography by photogrammetric methods from aerial photographs taken 1974. Field checked 1976. Map edited 1980
Projection and 10,000-foot ticks: Texas coordinate system, south central zone (Lambert conformal conic) 1000-meter Universal Transverse Mercator grid, zone 14
1927 North American datum
To place on the predicted North American Datum 1983 move the projection lines 16 meters south and 38 meters east as shown by dashed corner ticks
Fine red dashed lines indicate selected fence lines

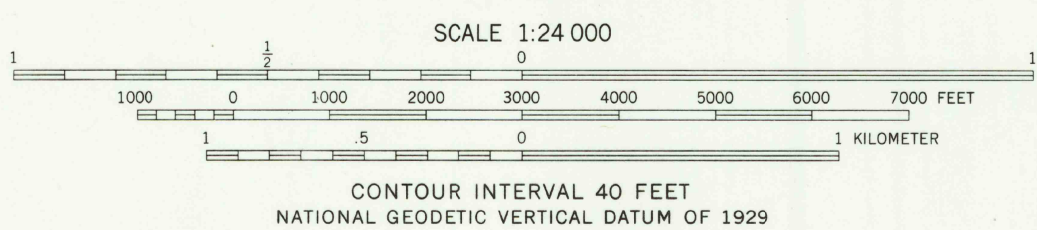
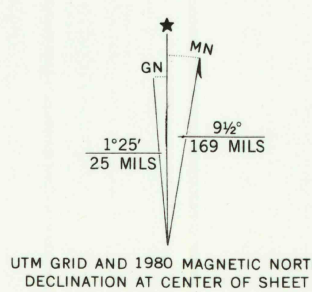

CONTOUR INTERVAL 40 FEET
NATIONAL GEODETIC VERTICAL DATUM OF 1929

THIS MAP COMPLIES WITH NATIONAL MAP ACCURACY STANDARDS
FOR SALE BY U. S. GEOLOGICAL SURVEY, DENVER, COLORADO 80225, OR RESTON, VIRGINIA 22092
A FOLDER DESCRIBING TOPOGRAPHIC MAPS AND SYMBOLS IS AVAILABLE ON REQUEST

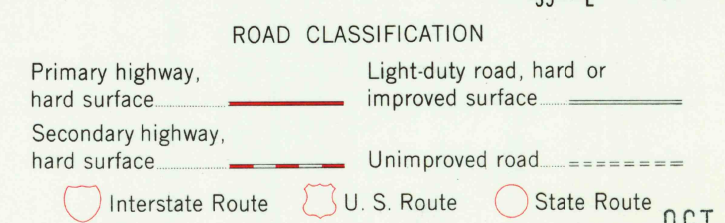

USGS
Historical File
Topographic Division

GEDDIS CANYON EAST, TEX.
N3015-W10145/7.5

1980
DMA 5644 IV SE-SERIES V882

3001-231

OCT - 2 1980

150