

5555 IV NE  
MORAN RANCH

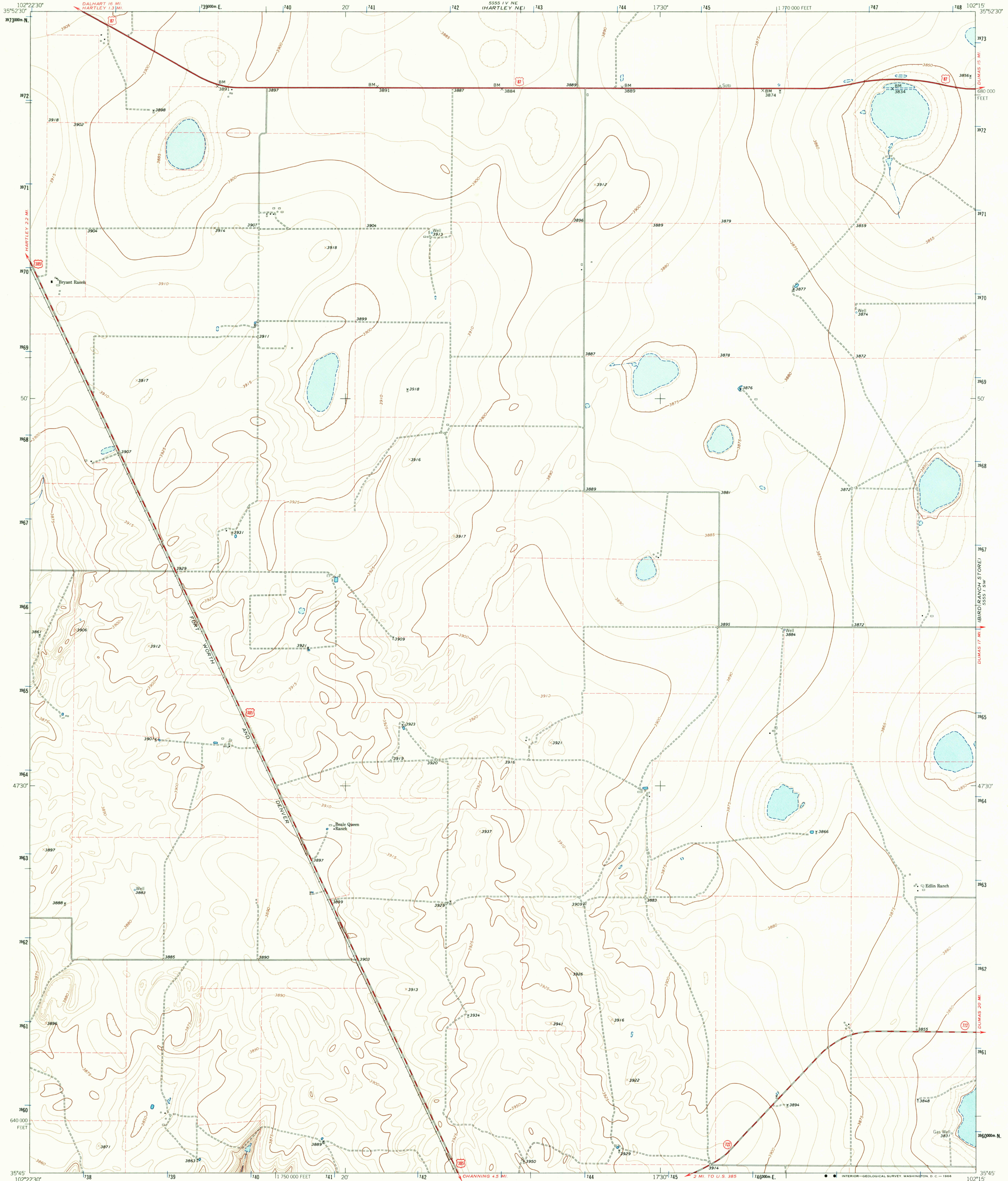

Mapped, edited, and published by the Geological Survey  
Control by USGS and USC&GS  
Planimetry by photogrammetric methods from aerial photographs taken 1962. Topography by planetable surveys 1963.  
Polyconic projection. 1927 North American datum. 10,000-foot grid based on Texas coordinate system, north zone 1000-meter Universal Transverse Mercator grid ticks, zone 13, shown in blue.  
Fine red dashed lines indicate selected fence lines.

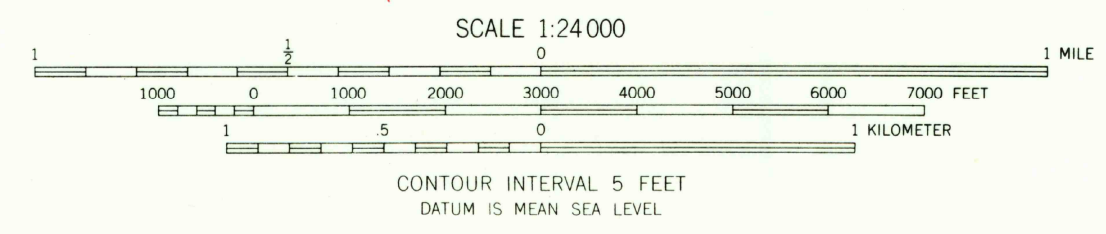
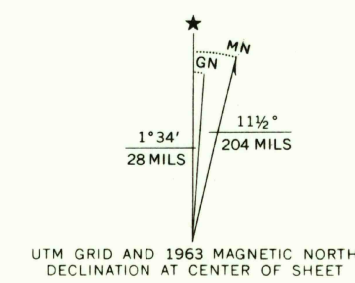

USGS Historical File Topographic Division

ROAD CLASSIFICATION

Heavy-duty	Light-duty
Medium-duty	Unimproved dirt

U.S. Route State Route



U.S.G.S.  
7.5 MINUTE SERIES  
TOPOGRAPHIC DIVISION

HARTLEY SE, TEX.  
N3545-W10215/7.5  
1963  
AMS 5555 IV SE - SERIES V882

3250  
NOV 21 1965

THIS MAP COMPLIES WITH NATIONAL MAP ACCURACY STANDARDS  
FOR SALE BY U.S. GEOLOGICAL SURVEY, DENVER, COLORADO 80225, OR WASHINGTON, D. C. 20242  
A FOLDER DESCRIBING TOPOGRAPHIC MAPS AND SYMBOLS IS AVAILABLE ON REQUEST