

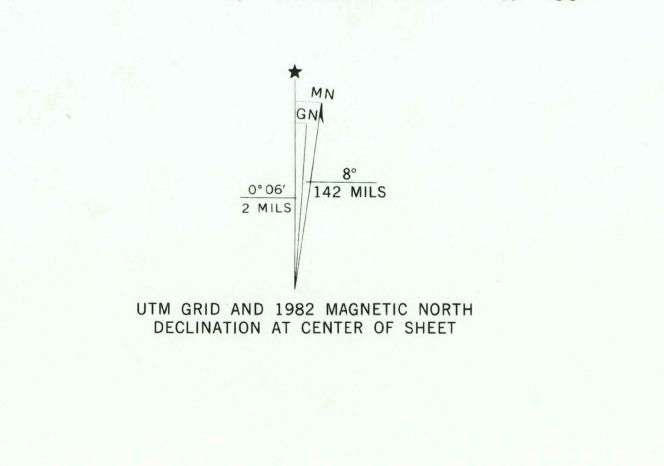

Mapped, edited, and published by the Geological Survey
Control by USGS and NOS/NOAA
Topography by photogrammetric methods from aerial
photographs taken 1969. Field checked 1970
Polyconic projection. 10,000-foot grid ticks based on Texas
coordinate system, south central zone. 1000-meter Universal Transverse
Mercator grid ticks, zone 14, shown in blue. 1927 North
American Datum. To place on the predicted North American
Datum 1983 move the projection lines 20 meters south and
30 meters east as shown by dashed corner ticks
Fine red dashed lines indicate selected fence lines
Revisions shown in purple and woodland compiled from
aerial photographs taken 1979 and other sources
This information not field checked. Map edited 1982



SCALE 1:24,000
(SAN GERONIMO)
6243 III SE
SAN GERONIMO 0.4 MI.
SAN ANTONIO 27 MI.
CONTOUR INTERVAL 20 FEET
NATIONAL GEODETIC VERTICAL DATUM OF 1929

ROAD CLASSIFICATION

- Primary highway, hard surface
- Light-duty road, hard or improved surface
- Secondary highway, hard surface
- Unimproved road
- Interstate Route
- U. S. Route
- State Route

QUADRANGLE LOCATION

JACK MOUNTAIN, TEX.
N2937.5—W9845/7.5
1970
PHOTOREVISED 1982
DMA 6243 III NE—SERIES V882

RETURN TO:
USGS AND HISTORICAL MAP ARCHIVES

MA 2-1982