

UNITED STATES
DEPARTMENT OF THE INTERIOR
GEOLOGICAL SURVEY

JULIA LAKE QUADRANGLE
TEXAS—HALE CO.
7.5 MINUTE SERIES (TOPOGRAPHIC)

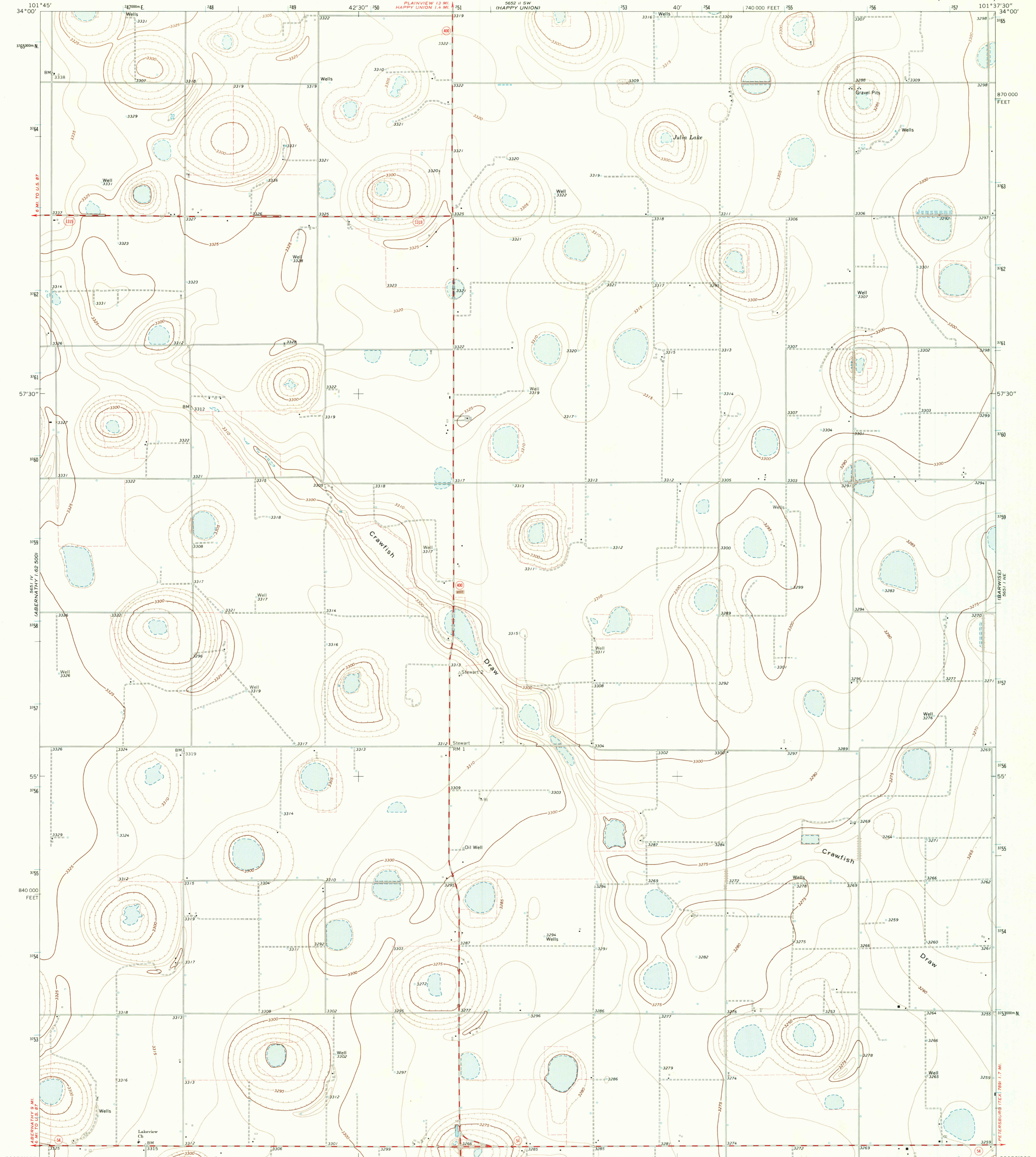

Mapped, edited, and published by the Geological Survey
Control by USGS and USC&GS
Planimetry by photogrammetric methods from aerial photographs
taken 1966. Topography by planimeter surveys 1966
Polyconic projection. 1927 North American datum
10,000-foot grid based on Texas coordinate system,
north central zone
1000-meter Universal Transverse Mercator grid ticks,
zone 14, shown in blue
Fine red dashed lines indicate selected fence lines

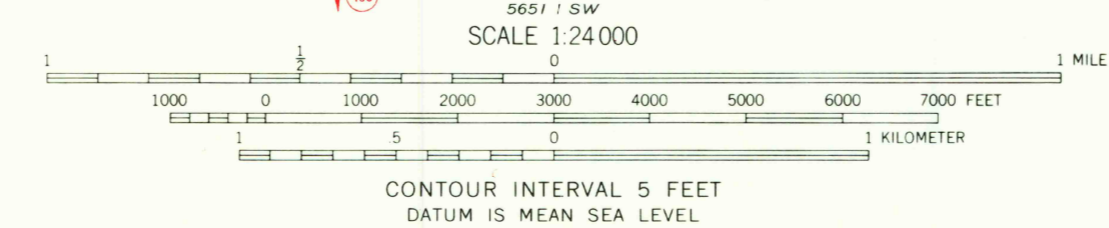
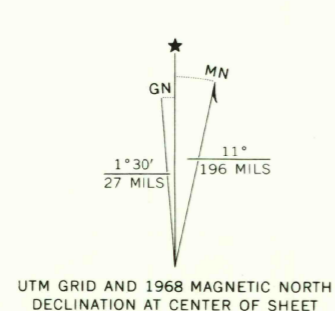

USGS
Historical Files
Topographic Division

ROAD CLASSIFICATION
Secondary highway, all weather, hard surface
Light-duty road, all weather, improved surface
Unimproved road, fair or dry weather
State Route



U.S.G.S.
FILE COPY
TOPOGRAPHIC DIVISION

JULIA LAKE, TEX.
N3352.5—W10137.5/7.5
1968

THIS MAP COMPLIES WITH NATIONAL MAP ACCURACY STANDARDS
FOR SALE BY U. S. GEOLOGICAL SURVEY, DENVER, COLORADO 80225, OR WASHINGTON, D. C. 20242
A FOLDER DESCRIBING TOPOGRAPHIC MAPS AND SYMBOLS IS AVAILABLE ON REQUEST