

DEPARTMENT OF THE INTERIOR  
FRANKLIN K. LANE, SECRETARY  
U. S. GEOLOGICAL SURVEY  
GEORGE OTIS SMITH, DIRECTOR

# TOPOGRAPHY

HARRIS COUNTY, TEXAS

W. H. WARD, COUNTY JUDGE

W. H. LLOYD, J. A. SMITH, W. H. KISER, D. BARKER  
COUNTY COMMISSIONERS

INSPECTION FILE  
TOPOGRAPHY  
Advance sheet  
Subject to correction

INSPECTION FILE  
TOPOGRAPHY

TEXAS  
HARRIS COUNTY  
KATY QUADRANGLE

Cypress

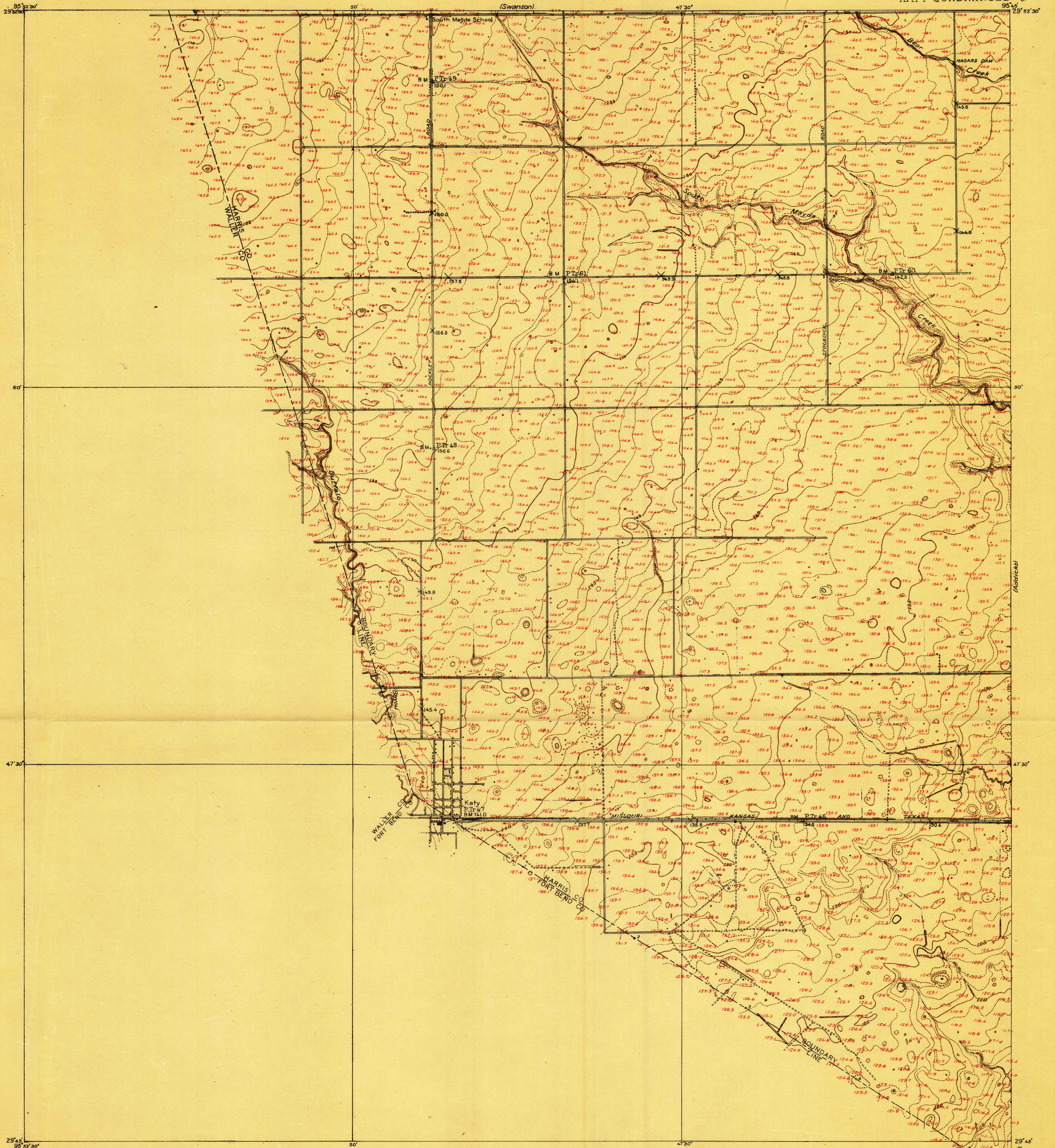

R. B. Marshall, Chief Geographer  
Sledge Tatum, Geographer in charge  
Topography by J. H. Wilke and T. P. Pendleton  
Control by U. S. Coast and Geodetic Survey  
E. L. McNair and R. R. Monbeck  
Surveyed in 1915  
SURVEYED IN COOPERATION WITH HARRIS COUNTY, TEXAS

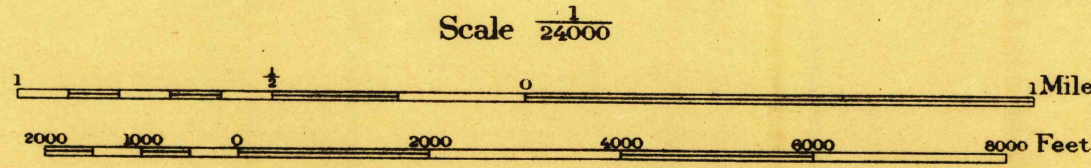

Contour interval 1 foot  
Datum is mean sea level

TRUE NORTH  
MAGNETIC NORTH  
APPROXIMATE MEAN  
DECLINATION 1915

USGS  
Historical File  
Topographic Division