

5756 NW
HANSFORD CAMP

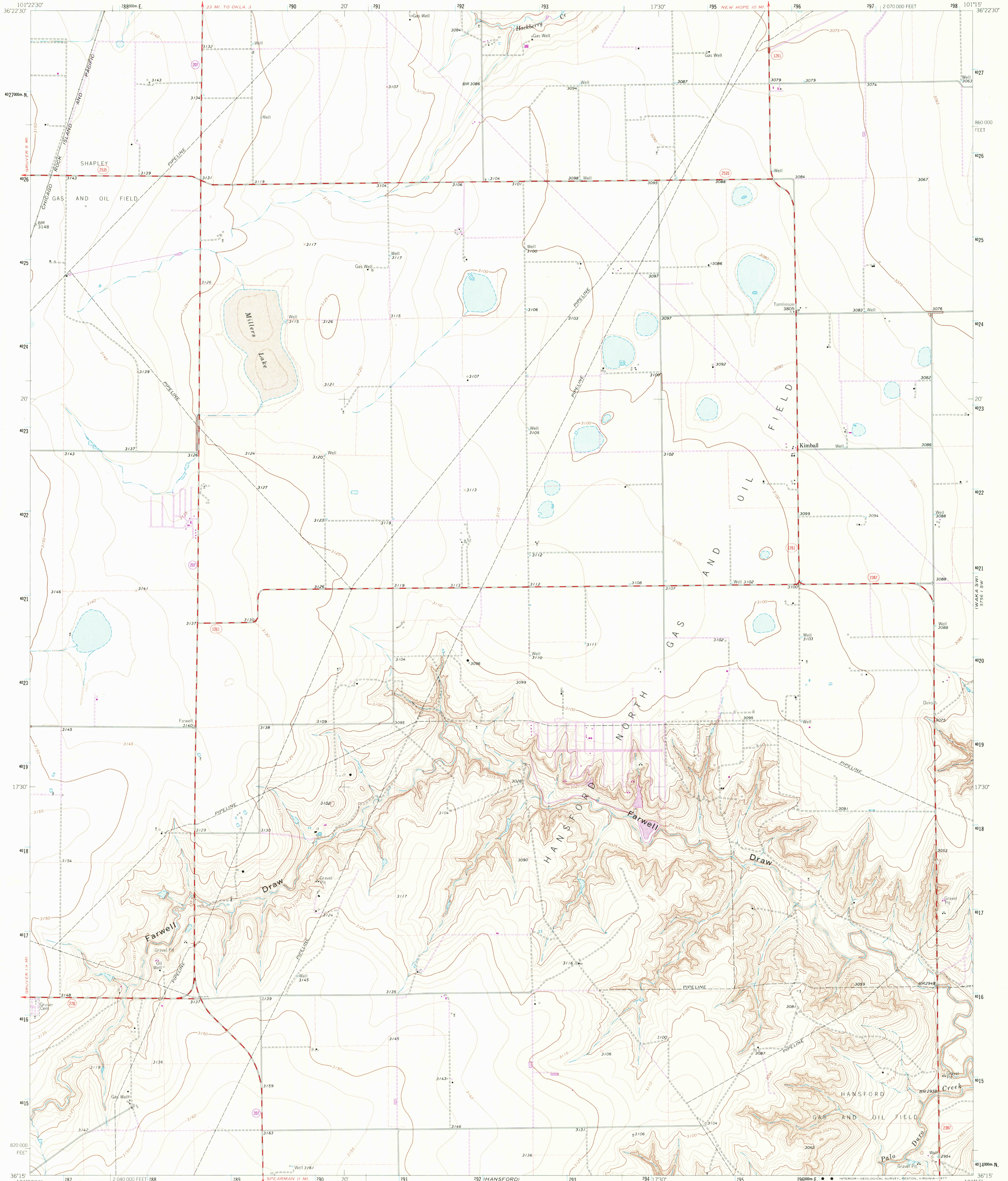

Mapped, edited, and published by the Geological Survey
Control by USGS and USC&GS
Topography by photogrammetric methods from aerial
photographs taken 1962 and planetable surveys 1962
Polyconic projection 1927 North American datum
10,000-foot grid based on Texas coordinate system, north zone
1000-meter Universal Transverse Mercator grid ticks,
zone 14, shown in blue
Fine rod dashed lines indicate selected fence lines
Revisions shown in purple compiled from aerial photographs
taken 1974. This information not field checked

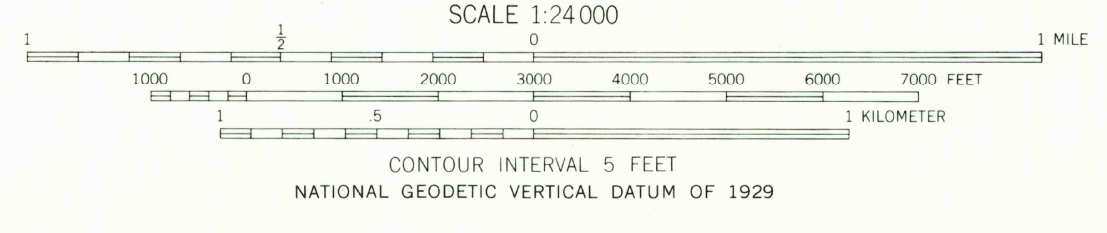
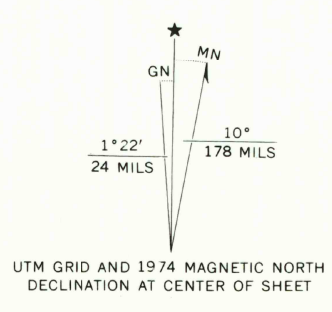

ROAD CLASSIFICATION

Medium-duty	Light-duty
Unimproved dirt	State Route

THIS MAP COMPLIES WITH NATIONAL MAP ACCURACY STANDARDS
FOR SALE BY U. S. GEOLOGICAL SURVEY, DENVER, COLORADO 80225, OR RESTON, VIRGINIA 22092
A FOLDER DESCRIBING TOPOGRAPHIC MAPS AND SYMBOLS IS AVAILABLE ON REQUEST

3601-131

USGS
Historical File
Topographic Division

KIMBALL, TEX.
N3615-W10115/7.5

SEP 26 1977
2750

1962
PHOTOREVISED 1974
AMS 5756 IV SE-SERIES V882