

DEPARTMENT OF THE INTERIOR
U. S. GEOLOGICAL SURVEY

GALVESTON COUNTY, TEXAS
COUNTY COMMISSIONERS COURT
E. B. HOLMAN, COUNTY JUDGE
JAMES A. BODDEKER (PRECINCT 1), HUMPHREY D. BOYD (PRECINCT 2)
VICTOR DANTIN (PRECINCT 3), AND W. T. SMITH (PRECINCT 4)
C. C. WASHINGTON, COUNTY ENGINEER
(Virginia Point)

U. S. G. S.
FILE COPY
Inspection and Editing.

TEXAS
(GALVESTON COUNTY)
LAKE COMO QUADRANGLE

Advance sheet
Subject to correction

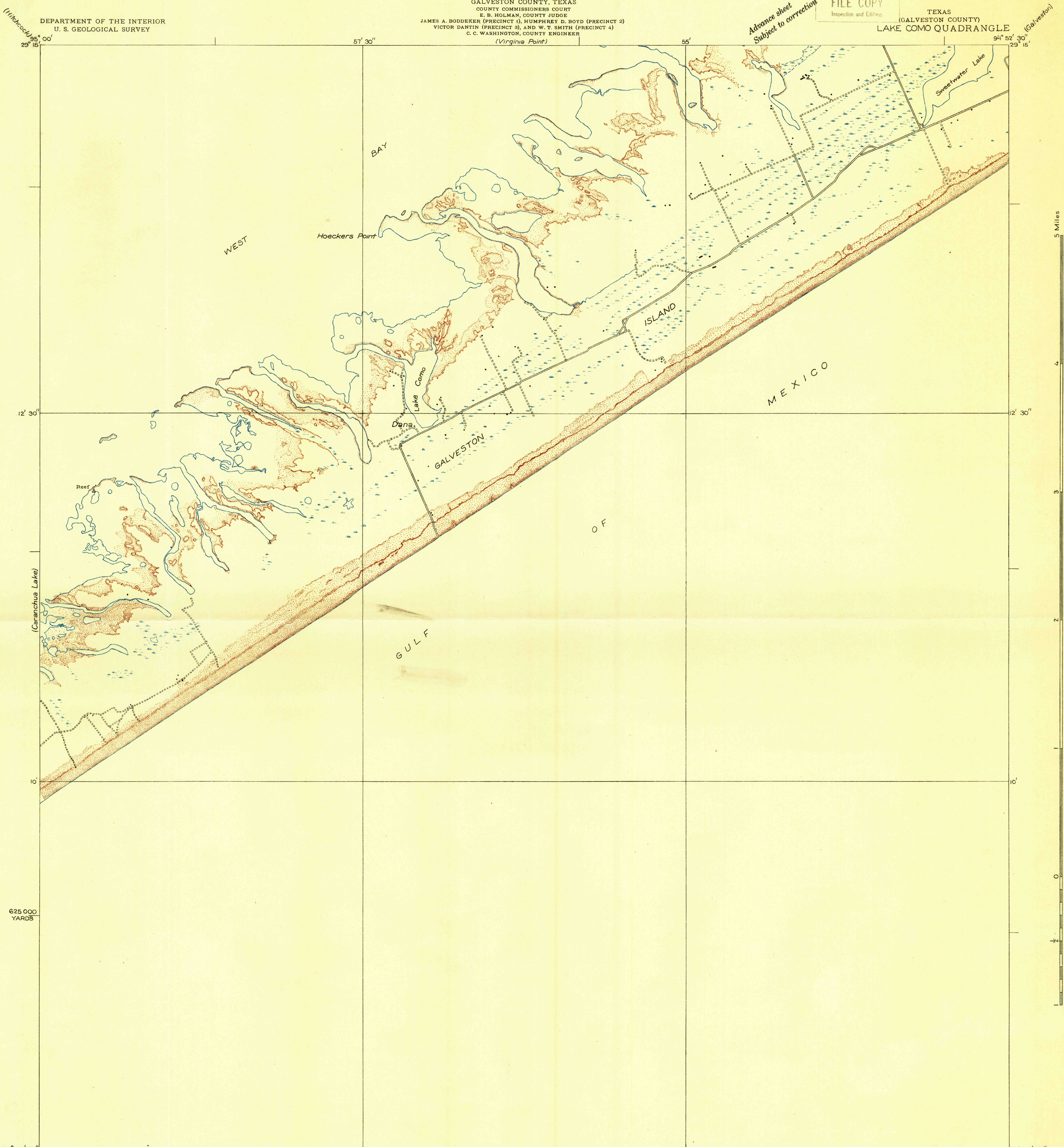

(Wichita) 95° 00'

(Galveston) 94° 52' 30"

12' 30"

12' 30"

10'

10'

625 000
YARDS

0

29° 07' 30"

29° 07' 30"

1 215 000 YARDS

Scale 1/24,000

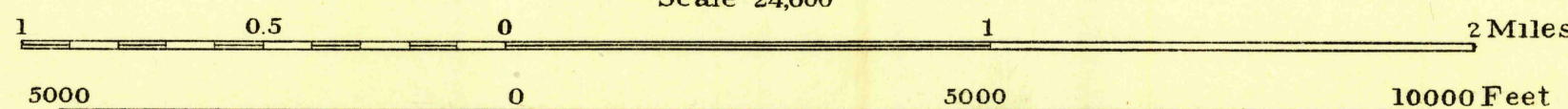

TRUE NORTH
MAGNETIC NORTH
APPROXIMATE MEAN
DECLINATION, 1931

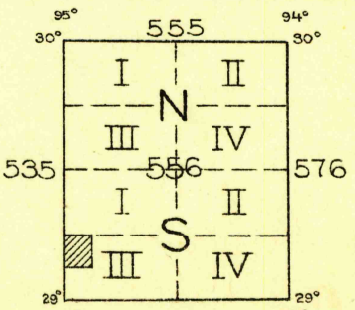

Polygonic projection, North American datum
5000 yard grid based upon U. S. zone system, D

LAKE COMO, TEX.

USGS
Historical File
Topographic Division

Glenn S. Smith, Division Engineer
Culture and drainage compiled from aerial photographs
taken by Air Corps, U. S. Army (Contours not mapped)
Control by U. S. Geological Survey and
Corps of Engineers, U. S. Army
Compiled in 1931

(San Luis Pass) 95° 00'