

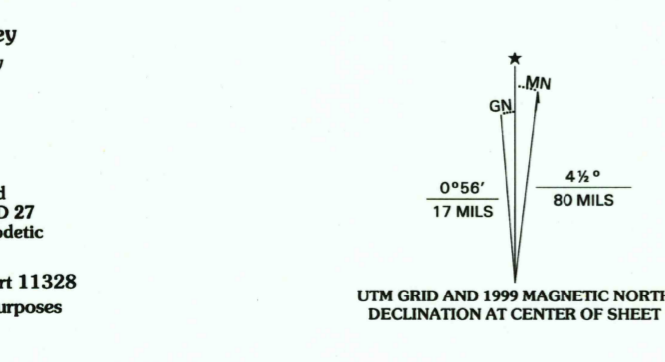

Produced by the United States Geological Survey
Topography compiled 1987. Planimetry derived from imagery taken 1995. Survey control current as of 1990.
North American Datum of 1983 (NAD 83). Projection and 1000-meter grid: Universal Transverse Mercator, zone 15
10 000-foot ticks: Texas Coordinate System of 1983 (south central zone)
North American Datum of 1927 (NAD 27) is shown by dashed corner ticks. The values of the shift between NAD 83 and NAD 27 for 7.5-minute intersections are obtainable from National Geodetic Survey NADCON software
Selected hydrographic data compiled from NOS/NOAA chart 11328 (1992). This information is not intended for navigational purposes
Landmark buildings verified 1990



SCALE 1:24 000
CONTOUR INTERVAL 5 FEET
NATIONAL GEODETIC DATUM OF 1929
TO CONVERT FROM FEET TO METERS, MULTIPLY BY 0.3048
THE MEAN RANGE OF TIDE IS NEGLIGIBLE

RECEIVED
SEP 30 2000
USGS NMU
HISTORICAL MAP ARCHIVES

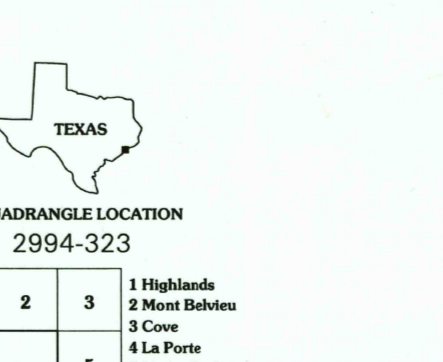

ROAD CLASSIFICATION
Primary highway hard surface Light-duty road, hard or improved surface
Secondary highway hard surface Unimproved road
Interstate Route U.S. Route State Route

QUADRANGLE LOCATION 2994-323

1	2	3
4	5	6
7	8	

1 Highlands
2 Mont Belvieu
3 Cove
4 La Porte
5 Umbrella Point
6 Laguna Cay
7 Baciff
8 Smith Point

MORGANS POINT, TX
1995
NIMA 7043 III NW-SERIES V882

THIS MAP COMPLIES WITH NATIONAL MAP ACCURACY STANDARDS
FOR SALE BY U.S. GEOLOGICAL SURVEY, P.O. BOX 25286, DENVER, COLORADO 80225
A FOLDER DESCRIBING TOPOGRAPHIC MAPS AND SYMBOLS IS AVAILABLE ON REQUEST

