

UNITED STATES  
DEPARTMENT OF THE INTERIOR  
GEOLOGICAL SURVEY

NEW DEAL QUADRANGLE  
TEXAS-LUBBOCK CO.  
7.5 MINUTE SERIES (TOPOGRAPHIC)  
NE/4 LUBBOCK 15' QUADRANGLE

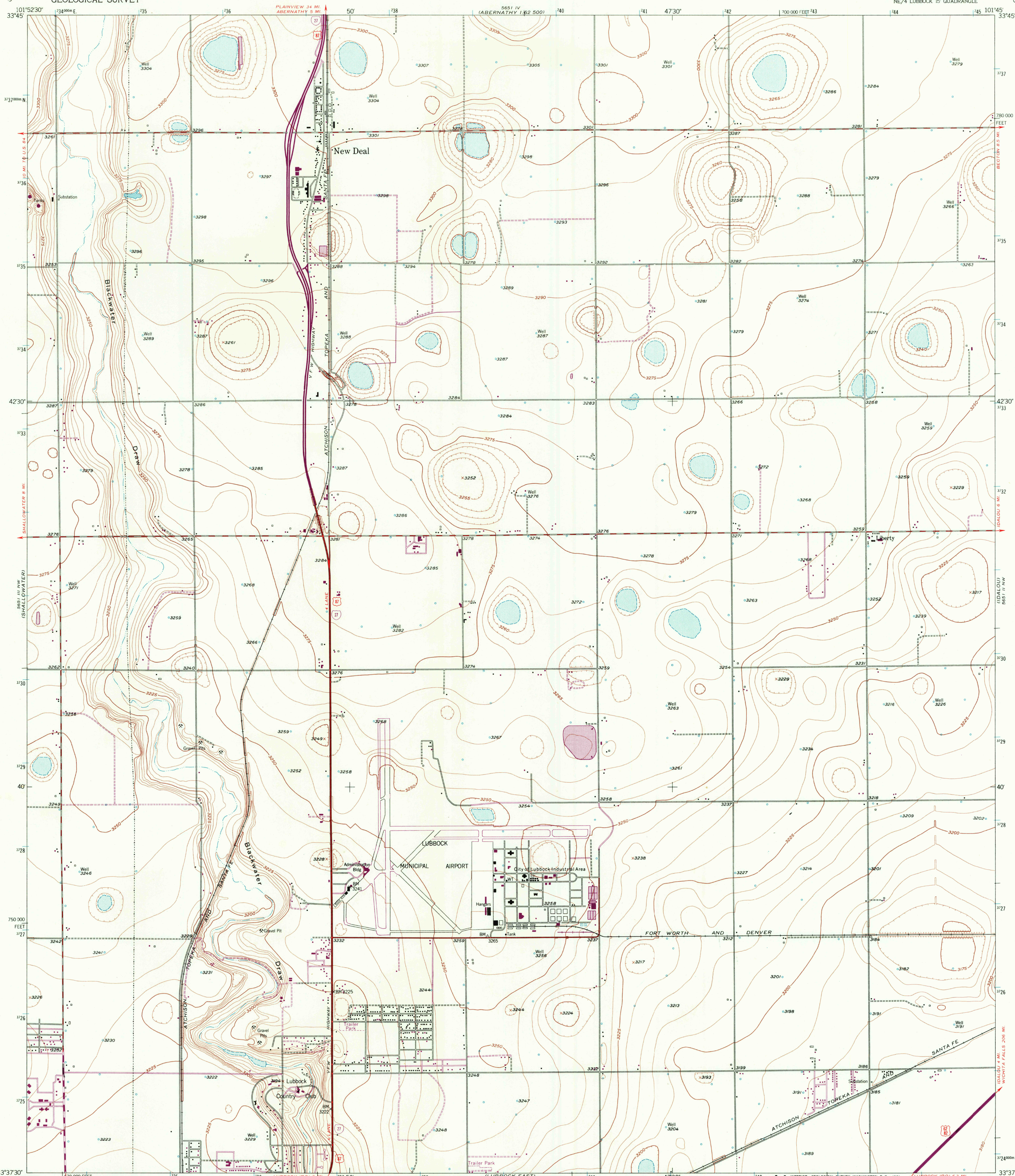

Mapped, edited, and published by the Geological Survey  
Control by USGS and USC&GS

Culture and drainage in part compiled from aerial photographs  
taken 1954. Topography by planetable surveys 1956

Polyconic projection. 1927 North American datum  
10,000-foot grid based on Texas coordinate system,  
north central zone  
1000-meter Universal Transverse Mercator grids ticks,  
zone 14, shown in blue

Revisions shown in purple compiled from aerial photographs  
taken 1970. This information not field checked

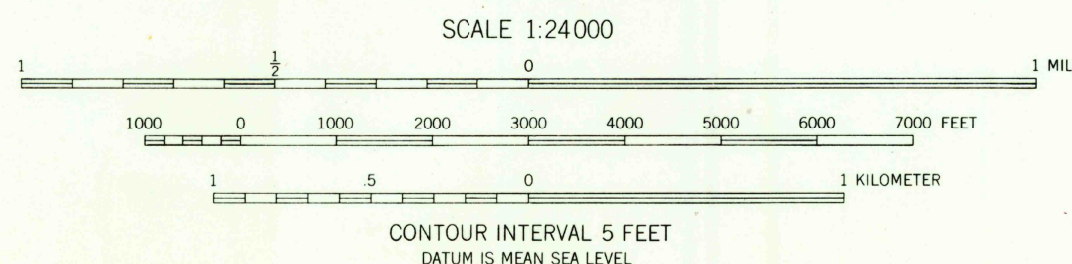
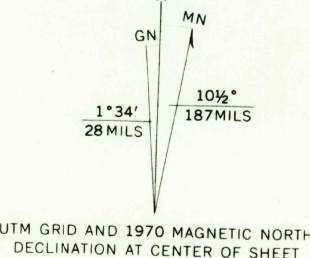

ROAD CLASSIFICATION  
Heavy-duty ——— Light-duty ———  
Medium-duty ——— Unimproved dirt ———  
Interstate Route U.S. Route



NEW DEAL, TEX.  
NE/4 LUBBOCK 15' QUADRANGLE  
N3337.5-W10145/7.5

USGS  
HISTORICAL FILE  
TOPOGRAPHIC DIVISION

1956  
PHOTOREVISED 1970  
AMS 5651 III NE-SERIES V882

OCT 7 1971

THIS MAP COMPLIES WITH NATIONAL MAP ACCURACY STANDARDS  
FOR SALE BY U. S. GEOLOGICAL SURVEY, DENVER, COLORADO 80225, OR WASHINGTON, D. C. 20242  
A FOLDER DESCRIBING TOPOGRAPHIC MAPS AND SYMBOLS IS AVAILABLE ON REQUEST