

NEW HOME NW

UNITED STATES
DEPARTMENT OF THE INTERIOR
GEOLOGICAL SURVEY

NEW HOME SE, QUADRANGLE
TEXAS
7.5 MINUTE SERIES ORTHOPHOTOQUAD

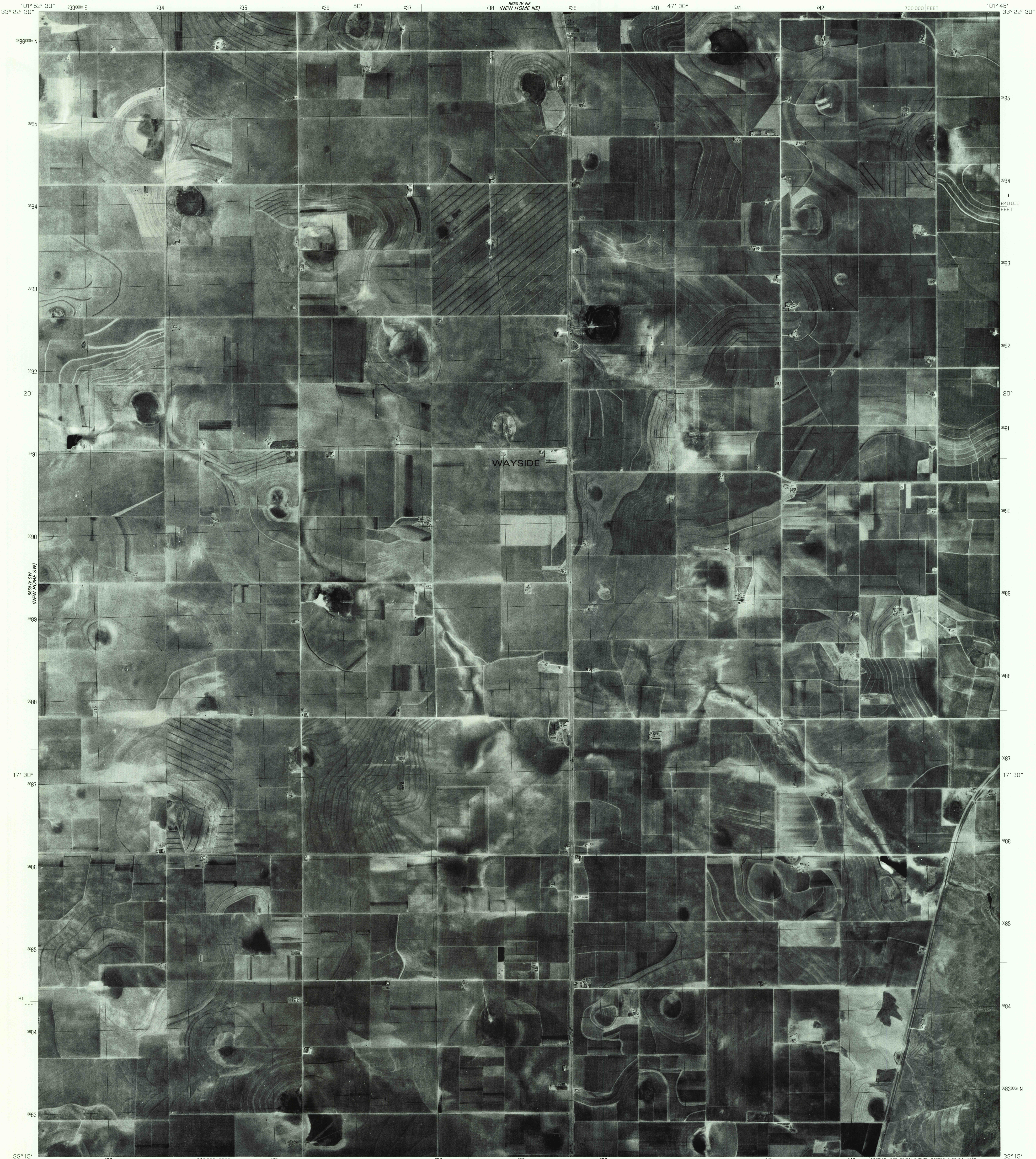

Produced by the Geological Survey
Orthophoto prepared from 1:80,000 scale
aerial photographs taken March 22, 1976
Projection and 10,000-foot grid ticks: Texas
coordinate system, north central zone (Lambert conformal conic)
1000-meter Universal Transverse Mercator grid,
Zone 13. 1927 North American datum
Photomage transformed by simple rectification

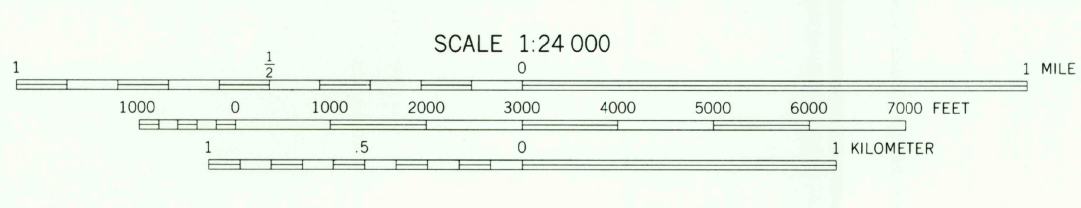
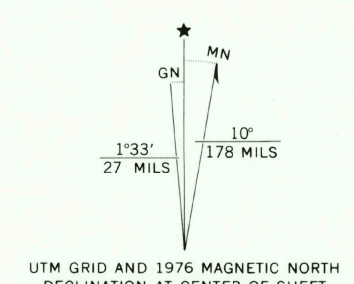

PRINCIPAL NUMBERED HIGHWAYS
○ Interstate Route ○ U.S. Route ○ State Route

This quadrangle area also covered by
1:62,500 scale topographic map
DEC 1 1 1978
NEW HOME SE, TEX.
N3315-W10145/7.5
1976
AMS 5650 IV SE—SERIES V082

THIS MAP COMPLIES WITH NATIONAL MAP ACCURACY STANDARDS
FOR SALE BY U. S. GEOLOGICAL SURVEY, DENVER, COLORADO 80225, OR RESTON, VIRGINIA 22092