

Advance sheet
Subject to correction

(Los Fresnos)
97° 22' 30"
26° 00'

97° 15'
26° 00'
U.S.G.S.
FILE COPY



U.S.G.S.
FILE COPY
Inspection and Editing

Glenn S. Smith, Division Engineer
Topography by W. B. Upton Jr. and S. S. Evans
Culture and drainage in part compiled from aerial photographs
Control by U. S. Geological Survey and
International Boundary Commission
Surveyed in 1929

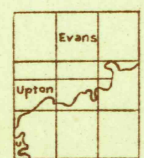

APPROXIMATE MEAN
DECLINATION, 1929

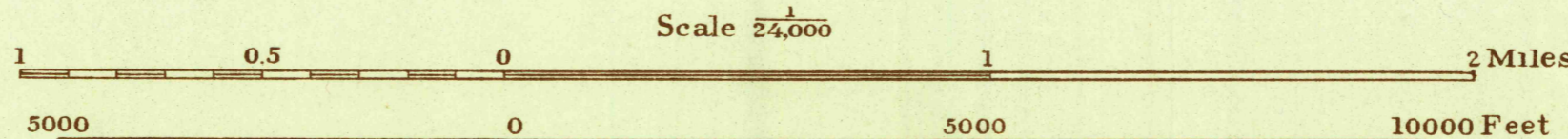

Scale 24,000
Contour interval 1 foot
Datum is mean sea level

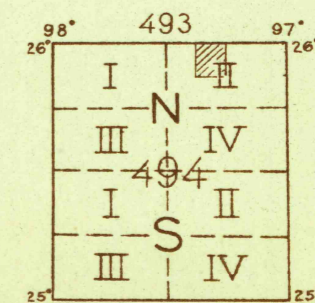

FILE COPY

MAP INFORMATION OFFICE
GEOLOGICAL SURVEY

PALMITO HILL, TEX.

(ENGR, for save for elevs)