

6438 IV NW  
(SARITA LAKE)

UNITED STATES  
DEPARTMENT OF THE INTERIOR  
GEOLOGICAL SURVEY

STATE OF TEXAS  
TEXAS DEPARTMENT OF WATER RESOURCES

RIVIERA QUADRANGLE  
TEXAS  
7.5 MINUTE SERIES (TOPOGRAPHIC)  
SECTION 4 RIVIERA 15' QUADRANGLE

6438 IV NW  
(RIVIERA BEACH NW)

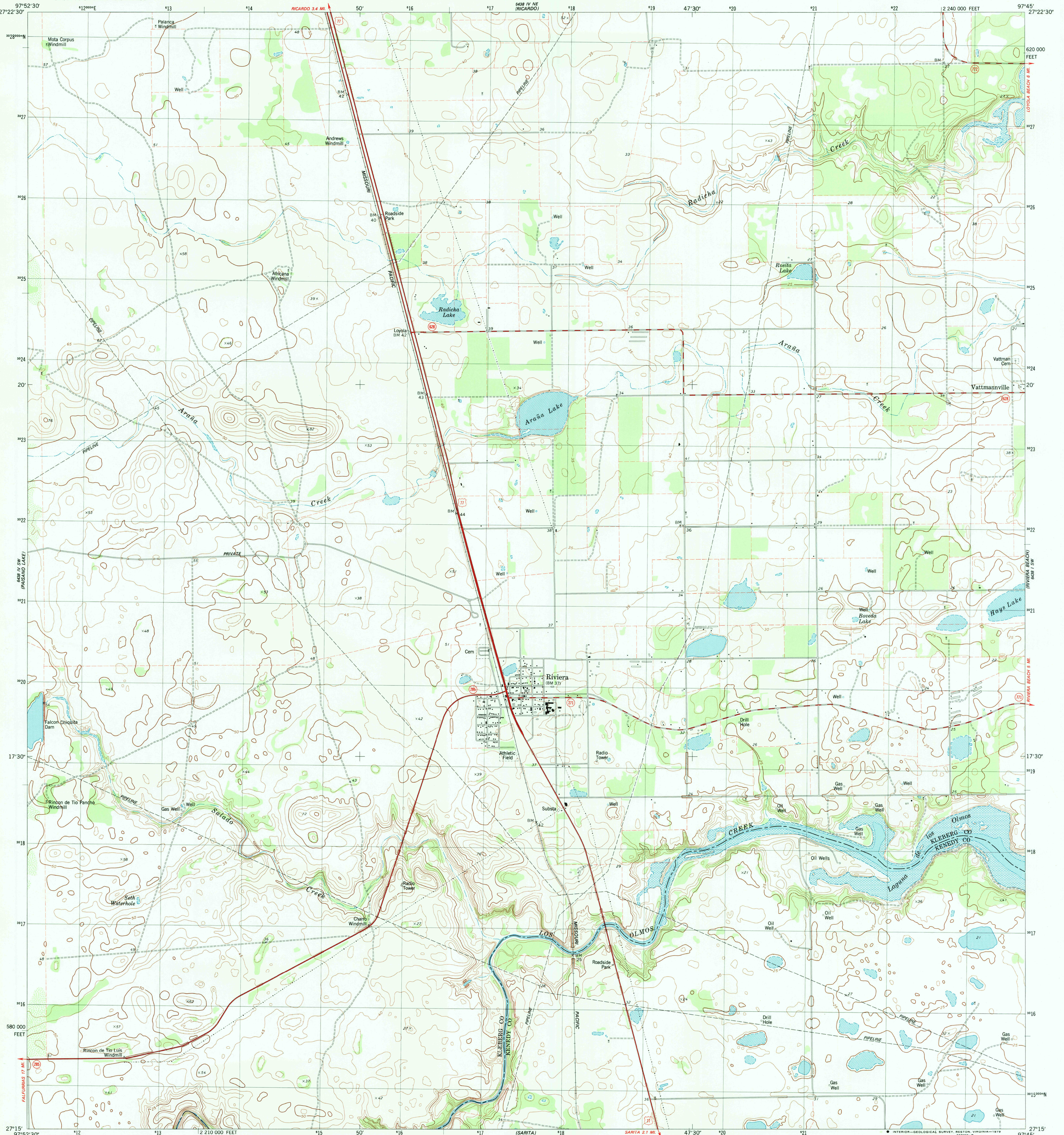

6438 IV SW  
(PALOMA RANCH)

Mapped, edited, and published by the Geological Survey  
Control by USGS and NOS/NOAA  
Topography by photogrammetric methods from aerial photographs taken 1974. Field checked 1975. Map edited 1979  
Projection and 10,000-foot grid ticks: Texas coordinate system, south zone (Lambert conformal conic)  
1000-meter Universal Transverse Mercator grid, zone 14 1927 North American datum  
Water stages in this area vary with meteorological conditions  
Approximate limits of occasional inundation shown by dashed blue lines where mean high water is undetermined for lack of visual evidence.  
Dotted blue lines indicate the approximate limits of low water  
Fine red dashed lines indicate selected fence lines

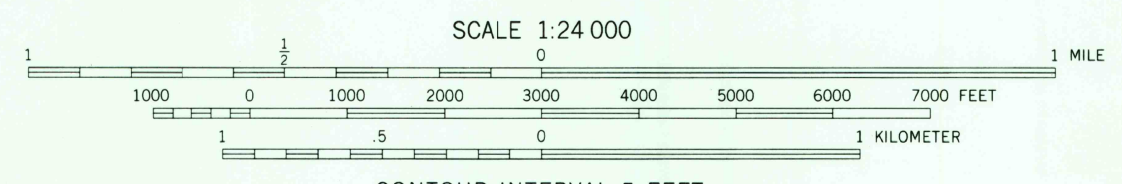
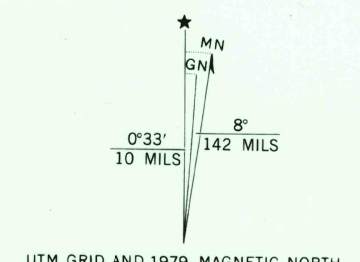

CONTOUR INTERVAL 5 FEET  
NATIONAL GEODETIC VERTICAL DATUM OF 1929  
SHORELINE SHOWN REPRESENTS THE APPROXIMATE LINE OF MEAN HIGH WATER  
THE MEAN RANGE OF TIDE IS LESS THAN 16 FEET

THIS MAP COMPLIES WITH NATIONAL MAP ACCURACY STANDARDS  
FOR SALE BY U.S. GEOLOGICAL SURVEY, DENVER, COLORADO 80225, OR RESTON, VIRGINIA 22092  
A FOLDER DESCRIBING TOPOGRAPHIC MAPS AND SYMBOLS IS AVAILABLE ON REQUEST

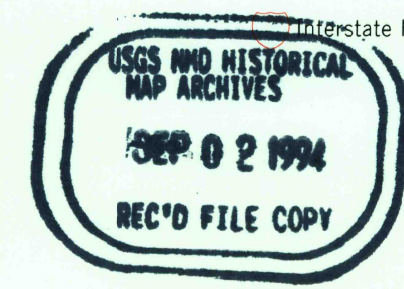

ROAD CLASSIFICATION

Primary highway, hard surface	Light-duty road, hard or improved surface
Secondary highway, hard surface	Unimproved road
Interstate Route	U. S. Route
	State Route

RIVIERA, TEX.  
SECTION 4 RIVIERA 15' QUADRANGLE  
N2715-W9745/7.5

1979  
DMA 6438 IV SE-SERIES W882

6438 IV NW  
(LA PALOMA RANCH)