

U. S. G. S.
FILE COPY
Inspection and Editing.

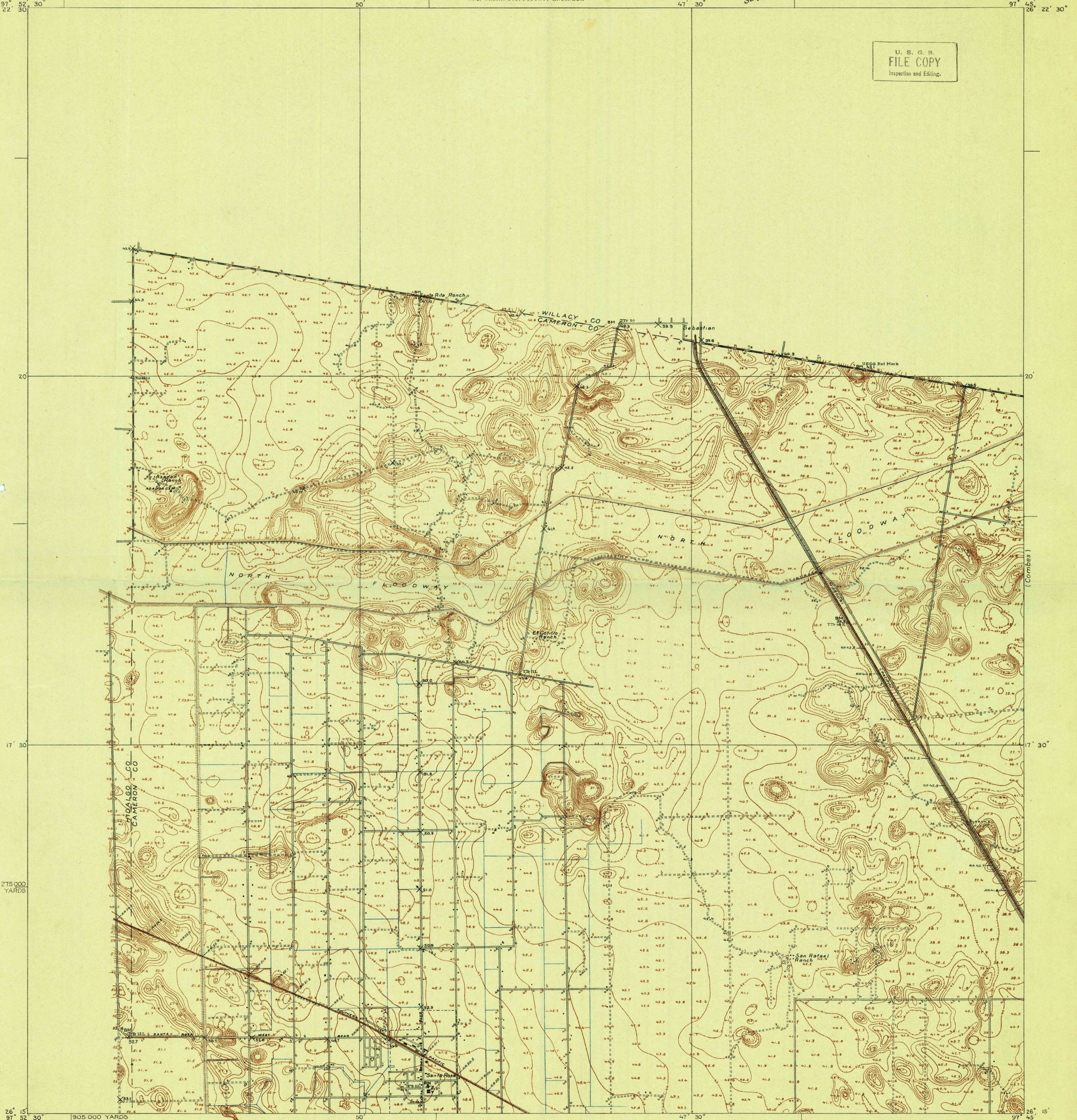

275 000 YARDS
905 000 YARDS
H. H. Hodgeson, Division Engineer
Topography by R. W. Burchard and T. F. Murphy
Culture and drainage in part compiled from aerial photographs
Control by U. S. Geological Survey U. S. Coast and Geodetic Survey
and Texas Reclamation Department
Surveyed in 1929

TRUE NORTH
MAGNETIC NORTH
APPROXIMATE MEAN
DECLINATION, 1925

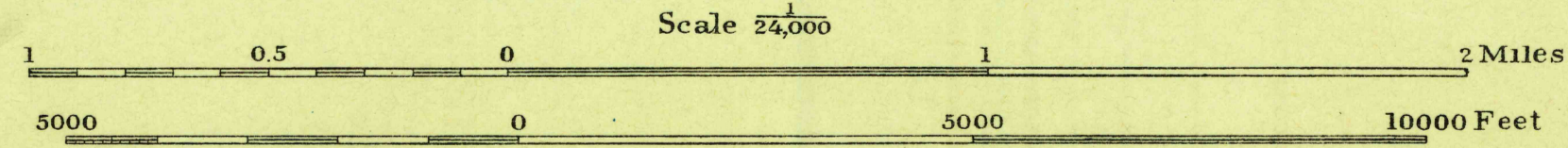

Scale 24,000
Contour interval 1 foot
Datum is mean sea level

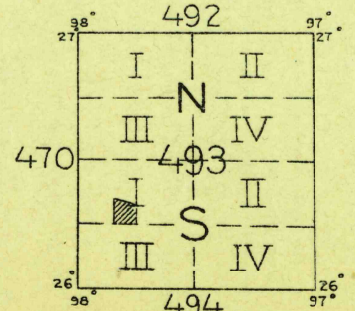

USGS
Historical File
Topographic Division

SANTA ROSA, TEXAS

Polyconic projection: North American datum
5000 yard grid based upon U. S. zone system, D