

42 MI. TO U.S. 62 AND 180

UNITED STATES  
DEPARTMENT OF THE INTERIOR  
GEOLOGICAL SURVEY



SIERRA BLANCA QUADRANGLE  
TEXAS-HUDSPETH CO.  
7.5 MINUTE SERIES (TOPOGRAPHIC)

42 MI. TO U.S. 62 AND 180

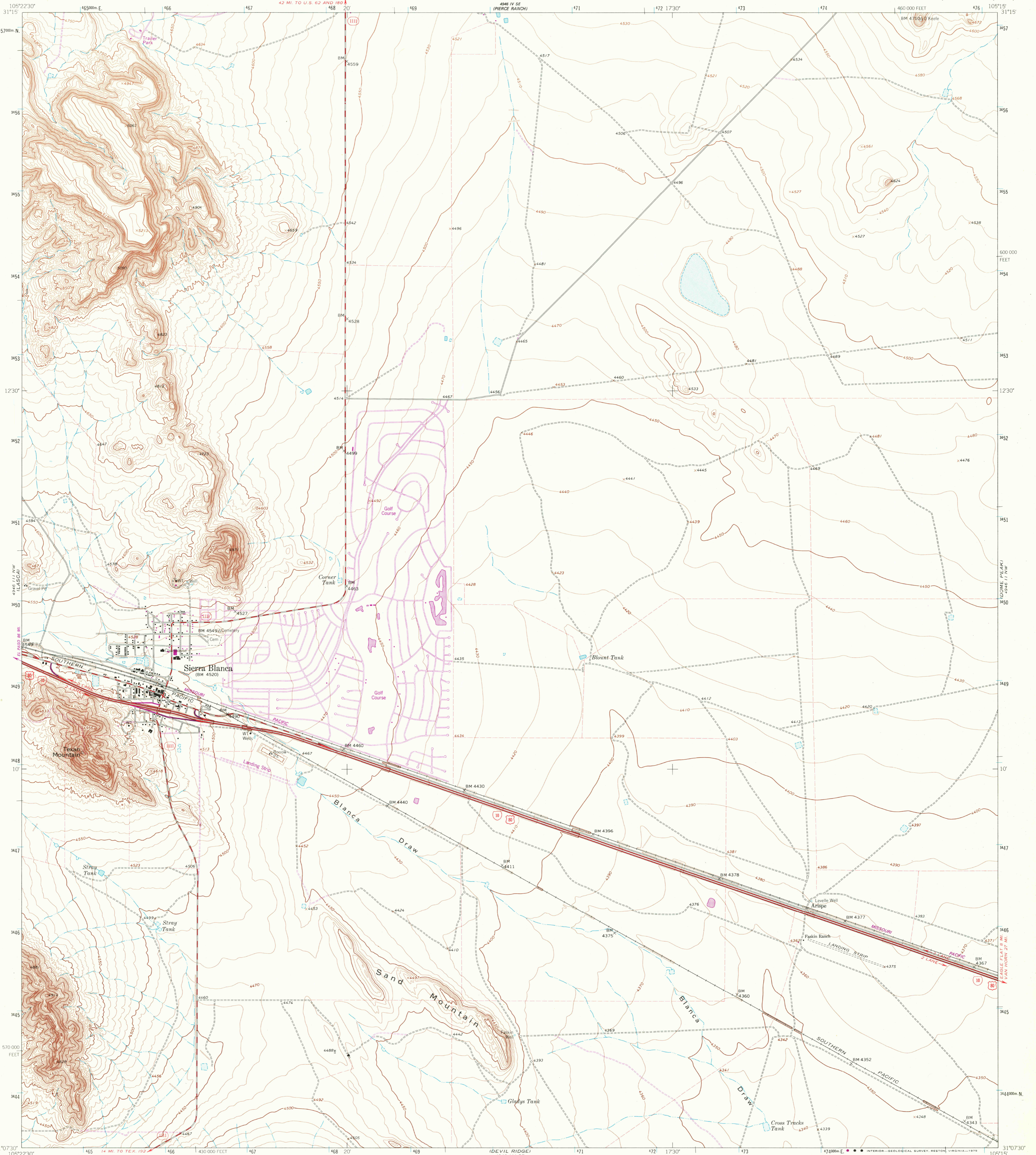

Mapped, edited, and published by the Geological Survey  
Control by USGS and USC&GS  
Topography by photogrammetric methods from aerial photographs taken 1963. Field checked 1964  
Polyconic projection. 1927 North American datum  
10,000-foot grid based on Texas coordinate system, central zone  
1000 meter Universal Transverse Mercator grid ticks,  
zone 13, shown in blue  
Fine red dashed lines indicate selected fence lines  
Revisions shown in purple compiled from aerial photographs  
taken 1976 and other source data. This information not  
field checked. Map edited 1979

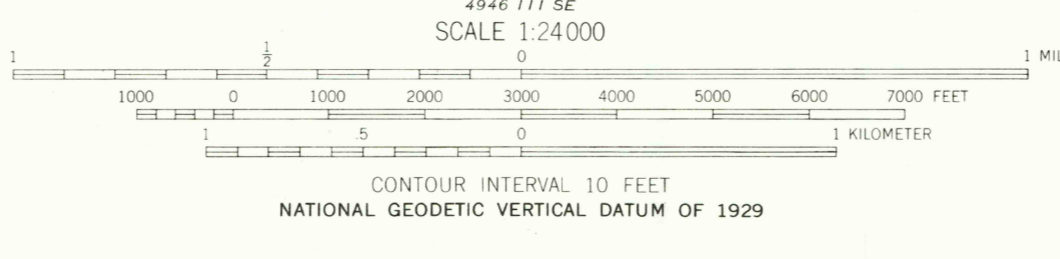
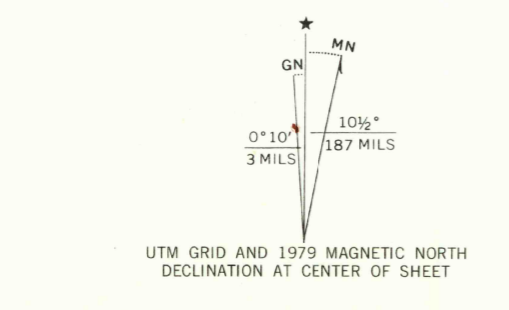

ROAD CLASSIFICATION

Heavy-duty	Light-duty
Medium-duty	Unimproved dirt
Interstate Route	U.S. Route
	State Route

THIS MAP COMPLIES WITH NATIONAL MAP ACCURACY STANDARDS  
FOR SALE BY U. S. GEOLOGICAL SURVEY, DENVER, COLORADO 80225, OR RESTON, VIRGINIA 22092  
A FOLDER DESCRIBING TOPOGRAPHIC MAPS AND SYMBOLS IS AVAILABLE ON REQUEST

3105-124

USGS  
Historical File  
Topographic Division

SIERRA BLANCA, TEX.  
N3107.5-W10515.7.5  
1964  
PHOTOREVISED 1979  
AMS 4946 III NE-SERIES V882

MAY 14 1979

1700