

4-21-N-IV-E/2-NE/4  
**TOPOGRAPHY**  
 STATE OF TEXAS  
 BOARD OF WATER ENGINEERS  
 JOHN A. NORRIS, CHAIRMAN  
 C. S. CLARK, A. H. DUNLAP  
 (Quarry Creek)

DEPARTMENT OF THE INTERIOR  
 ALBERT B. FALL, SECRETARY  
 U. S. GEOLOGICAL SURVEY  
 GEORGE OTIS SMITH, DIRECTOR

Advance sheet.  
 Subject to correction.

TEXAS  
 (RUNNELS COUNTY)  
 ROWENA QUADRANGLE

(Maverick)  
 106°07'30"  
 31°45'

(Hatchel)  
 100°00'  
 31°45'



C. H. Birdseye, Chief Topographic Engineer,  
 T. G. Gerdine, Division Topographic Engineer,  
 Topography by C.C. Holder and T.F. Murphy.  
 Control by C.F. Urquhart, C.E. Fulmer, and A.K. Andrews.  
 Surveyed in 1921

Holder	
Murphy	
H	

SURVEYED IN COOPERATION WITH THE STATE OF TEXAS

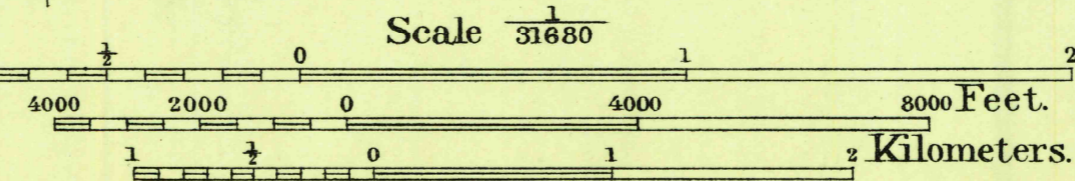

Contour interval 5 feet.  
 Datum is mean sea level.

USGS  
 Historical File  
 Topographic Division

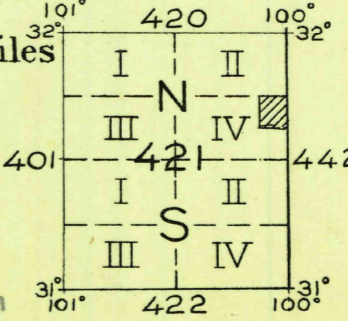

Polyconic projection. To place on North American datum move projection lines 160 feet north and 120 feet east.

5000 yard grid based upon U. S. zone system, D

TRUE NORTH  
 MAGNETIC NORTH  
 APPROXIMATE MEAN DECLINATION 1921

ROWENA, TEX.