

RETAINED COPY
This sheet must not be taken from
the files without an order from the
Chief Topographic Engineer.

TOPOGRAPHIC FILES

DEPARTMENT OF THE INTERIOR
U. S. GEOLOGICAL SURVEY

442-S-11-W/2-NW/4
STATE OF TEXAS
BOARD OF WATER ENGINEERS
JOHN A. NORRIS, CHAIRMAN
C. S. CLARK, A. H. DUNLAP

Advance sheet
Subject to correction

TEXAS
BRADY 2-b QUADRANGLE

SEP 8 1945



Topography by R. H. Reineck
Culture and drainage in part from aerial photographs
from Air Service, U. S. Army
Surveyed in 1925

Polyconic projection. North American datum
5000 yard grid based upon U. S. zone system, D

TRUE NORTH
MAGNETIC NORTH
APPROXIMATE MEAN
DECLINATION, 1925

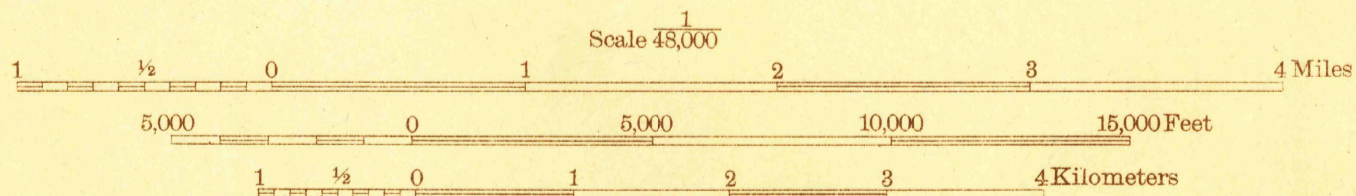

Contour interval 20 feet
10 foot contours in dashed lines
Datum is mean sea level

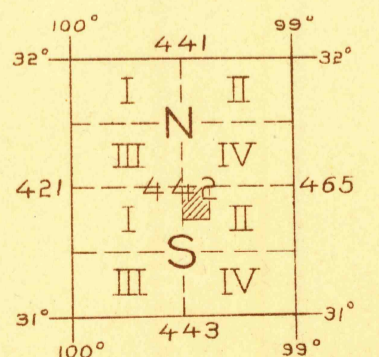

BRADY 2-b TEX

RETURN TO:
USGS NMD HISTORICAL MAP ARCHIVES

Published as part of Waldrip 15' (partial quad)