

(Greenbury 4-a)
32° 07' 30"

DEPARTMENT OF THE INTERIOR
U. S. GEOLOGICAL SURVEY

487-S-IV-W/2-SW/4
STATE OF TEXAS
BOARD OF WATER ENGINEERS
JOHN A. NORRIS, CHAIRMAN
C. S. CLARK, A. H. DUNLAP
(Cleburne 3-b)

Advance sheet
Subject to correction

TEXAS
CLEBURNE 3-c QUADRANGLE

97° 22' 30"
32° 07' 30"



Topography by F.A. Danforth, H.E. Simmons, J.F. Woodward,
L.D. Simmons, H.L. Turner, and W.H. Lambeth
Surveyed in 1923-1924

Polyconic projection. North American datum
5000 yard grid based upon U. S. zone system, D



TRUE NORTH
MAGNETIC NORTH
APPROXIMATE MEAN
DECLINATION 1924

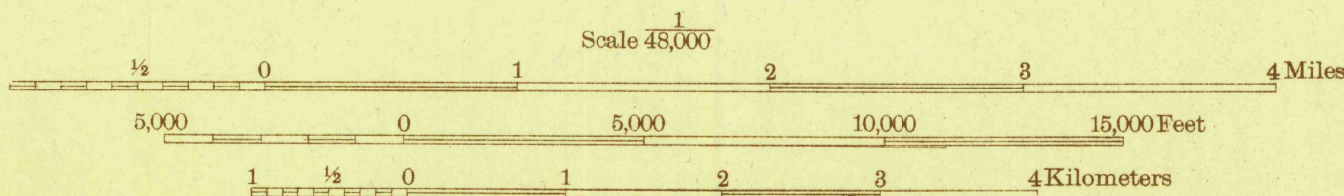

Contour interval 20 feet
Datum is mean sea level

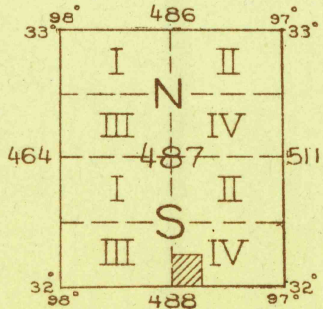

CLEBURNE 3-c, TEX.

FILE COPY
RETURN TO:
USGS AND HISTORICAL MAP ARCHIVES
MAP INFORMATION OFFICE
GEOLOGICAL SURVEY

PUB. & PART. DE. BLUM. 151 PARTIAL