

DEPARTMENT OF THE INTERIOR  
U. S. GEOLOGICAL SURVEY

510-S-111-E/2-SE/4  
STATE OF TEXAS  
BOARD OF WATER ENGINEERS  
JOHN A. NORRIS, CHAIRMAN  
C. S. CLARK, A. H. DUNLAP

TEXAS  
(COLLIN COUNTY)  
McKINNEY 4-d QUADRANGLE

Advance sheet  
Subject to correction

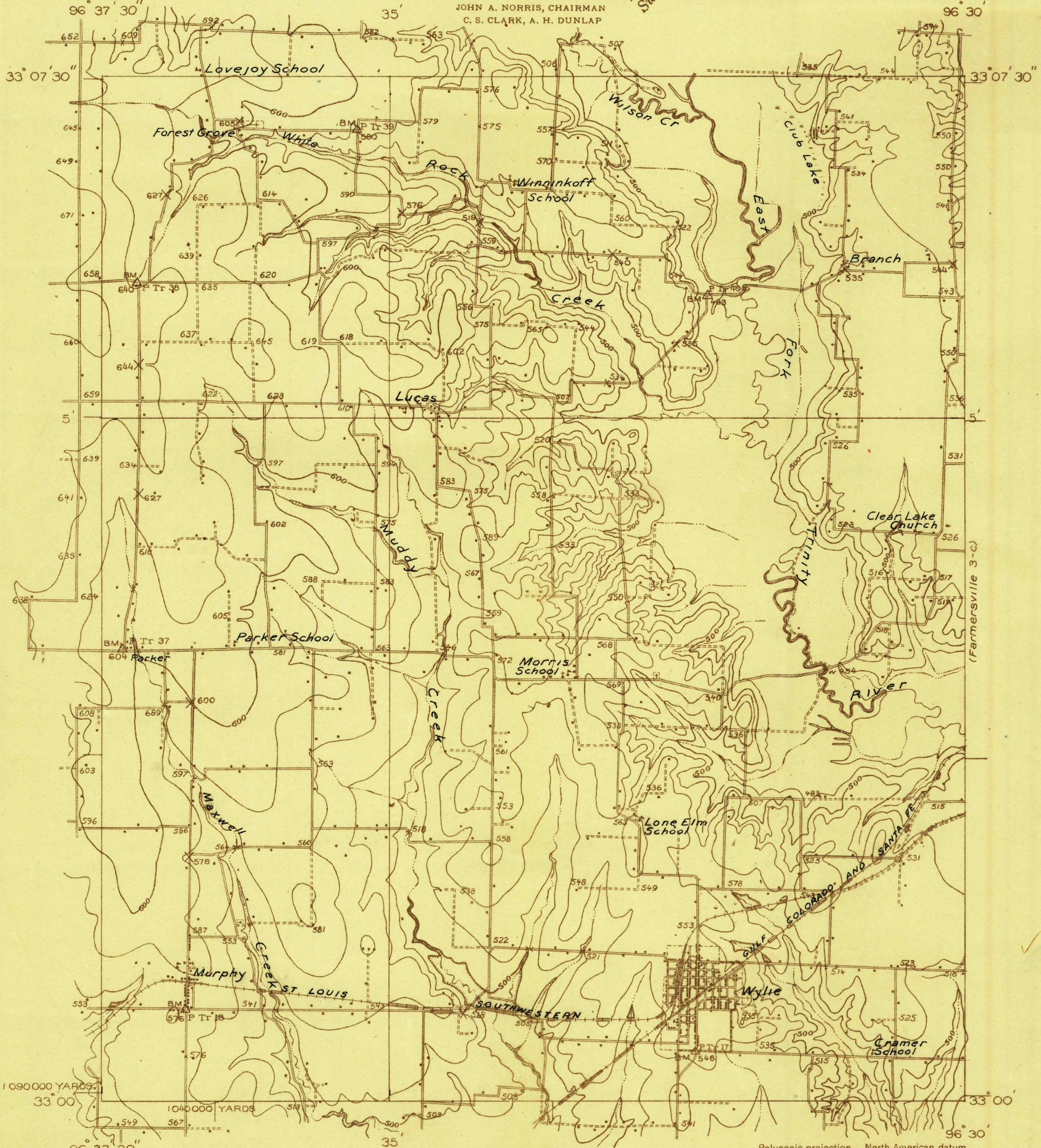

Topography by R. H. Reineck and G. E. Sisson  
Surveyed in 1924

Scale 48,000

Polyconic projection. North American datum  
5000 yard grid based upon U. S. zone system, D

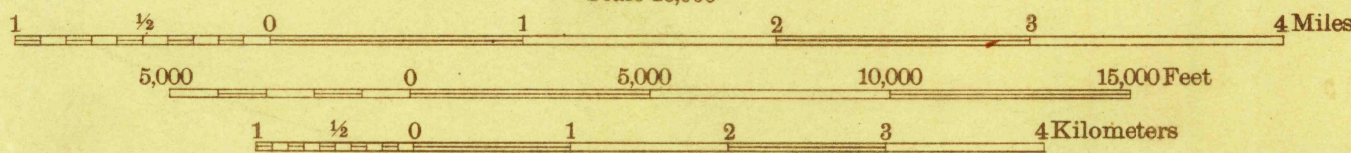

Contour interval 20 feet.  
Datum is mean sea level

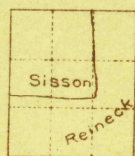

APPROXIMATE MEAN  
DECLINATION 1924

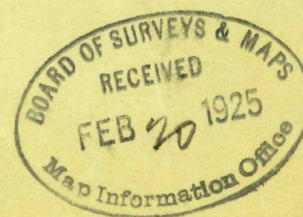
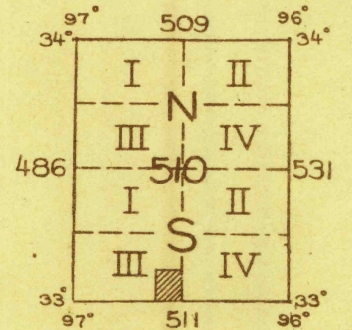

McKINNEY 4-d, TEX.  
Board of Surveys & Maps  
FILE COPY  
Map Information Office

RETURN TO:  
USGS NHD HISTORICAL MAP ARCHIVES

Entered card 4/21/25