

U. S. G. S.  
**FILE COPY**  
Inspection and Editing.

RETAINED COPY  
This sheet must not be taken from  
the files without an order from the  
Chief Topographic Engineer.

# TOPOGRAPHIC FILES

APR 15 1925

464-N-1-W-2-NE/4  
STATE OF TEXAS  
BOARD OF WATER ENGINEERS  
JOHN A. NORRIS, CHAIRMAN  
C. S. CLARK, A. H. DUNLAP

Advance sheet  
Subject to correction

TEXAS  
(PALO PINTO COUNTY)  
PALO PINTO 2-a QUADRANGLE

DEPARTMENT OF THE INTERIOR  
U. S. GEOLOGICAL SURVEY



1080 000  
YARDS

Topography by E.S. Rickard, O.C. Cope and Ward Eison  
Surveyed in 1924

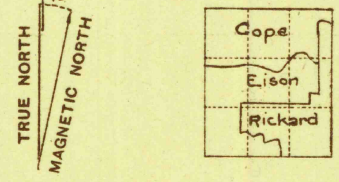

Polyconic projection. North American datum  
5000-yard grid based upon U. S. zone system, D

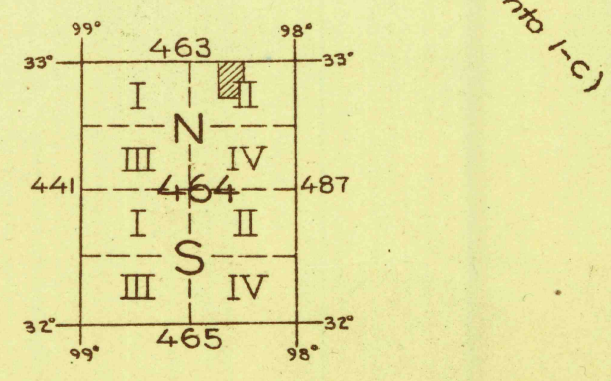
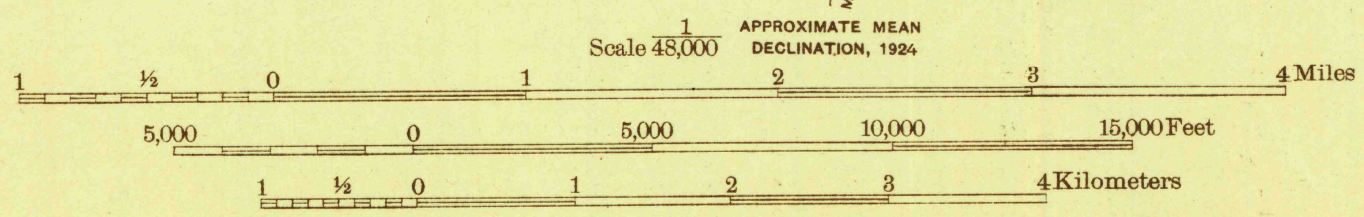

Contour interval 20 feet  
A few 10 foot contours added in dashed lines  
Datum is mean sea level

PALO PINTO 2-a, TEXAS

U. S. G. S.  
**FILE COPY**  
Inspection and Editing.