

464-N-IV-E/2-NW/4  
STATE OF TEXAS  
BOARD OF WATER ENGINEERS  
JOHN A. NORRIS, CHAIRMAN  
C. S. CLARK, A. H. DUNLAP  
(Palo Pinto 1-c)

Advance sheet  
Subject to correction

TEXAS  
(PALO PINTO COUNTY)  
PALO PINTO 4-b QUADRANGLE

98° 07' 30"

(Palo Pinto 2-d)  
98° 15'  
32° 45'

DEPARTMENT OF THE INTERIOR  
U. S. GEOLOGICAL SURVEY



1050 000  
YARDS

32° 37' 30"  
98° 15'

Topography by A. J. Ogle and H. S. Milsted  
Culture and drainage in part from aerial photographs  
by Air Service, U. S. Army  
Control in part by U. S. Coast and Geodetic Survey  
Surveyed in 1925

Scale 48,000

1 1/2 0 1 2 3 4 Miles

5,000 0 5,000 10,000 15,000 Feet

1 1/2 0 1 2 3 4 Kilometers

Contour interval 20 feet  
10 foot contours in dashed lines  
Datum is mean sea level

Polyconic projection. North American datum.  
5000 yard grid based upon U. S. zone system, D

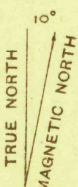

APPROXIMATE MEAN  
DECLINATION, 1925

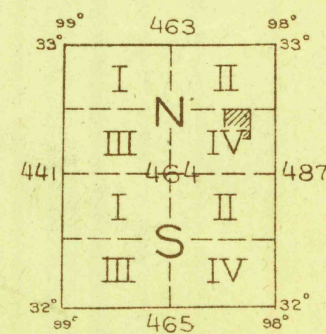

PALO PINTO 4-b, TEX.