

DEPARTMENT OF THE INTERIOR  
U. S. GEOLOGICAL SURVEY

445-N-11-E/2-NW/4  
STATE OF TEXAS  
BOARD OF WATER ENGINEERS  
JOHN A. NORRIS, CHAIRMAN  
C. S. CLARK, A. H. DUNLAP

*Advance sheet  
Subject to correction*

TEXAS  
(FRIO COUNTY)  
PEARSALL I-b QUADRANGLE

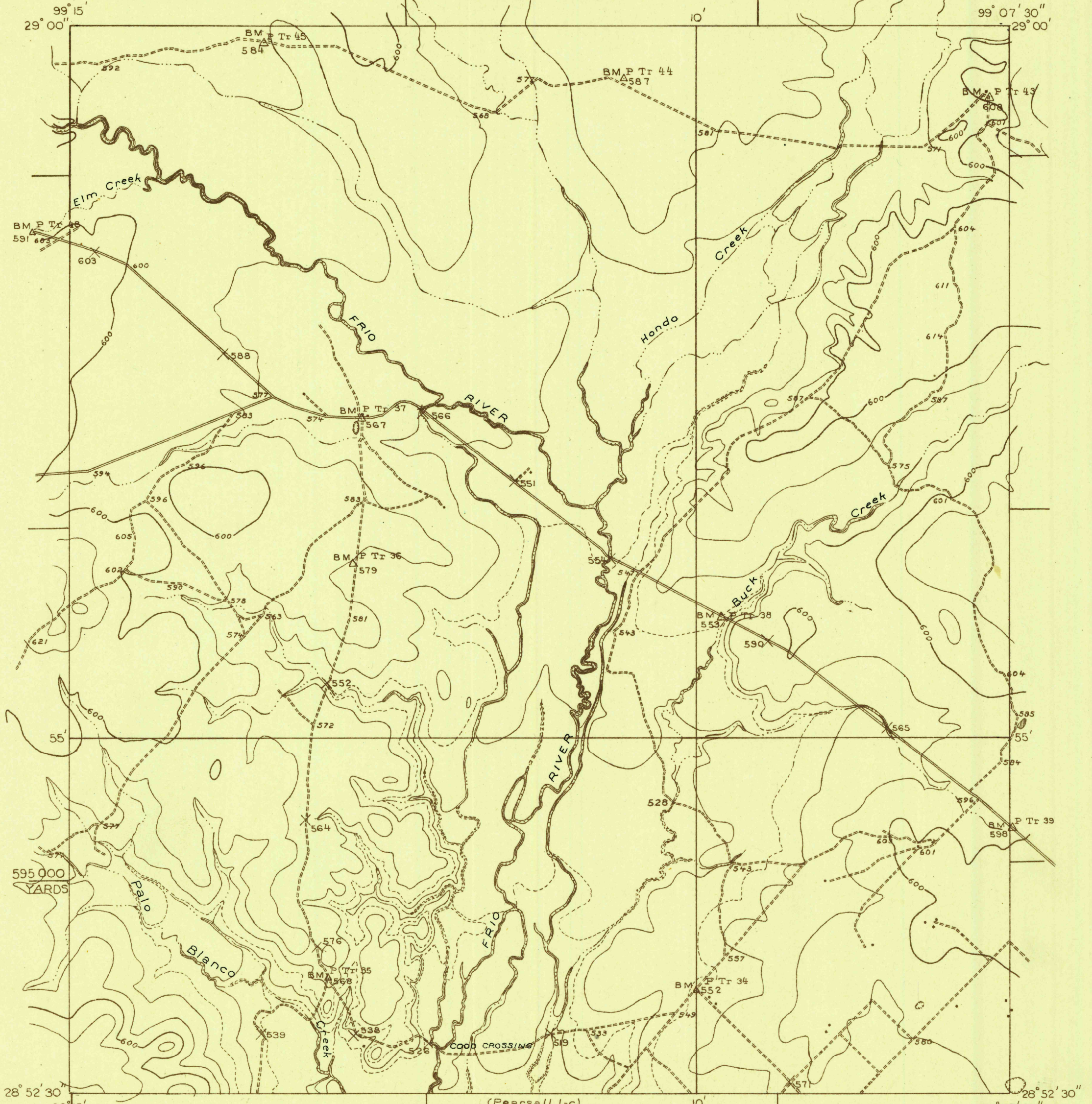

Topography by T.F. Murphy and W.A. Fisher  
Culture and drainage in part from aerial photographs  
by Air Service, U. S. Army  
Control by U. S. Geological Survey  
Surveyed in 1925

Polyconic projection. North American datum  
5000 yard grid based upon U. S. zone system, D

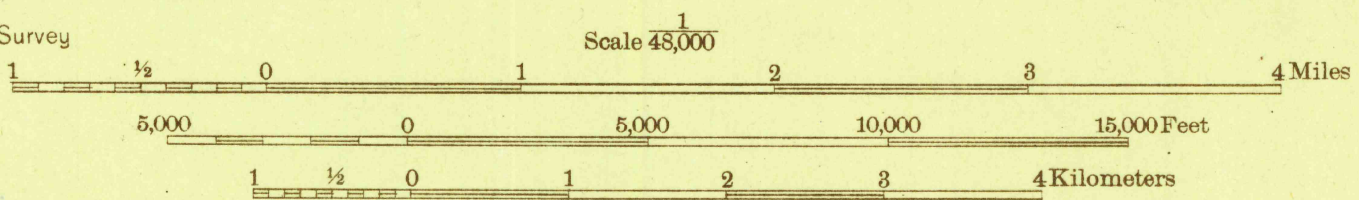

Contour interval 20 feet  
10 foot contours in dashed lines  
Datum is mean sea level

PEARSALL I-b, TEX.

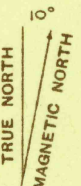
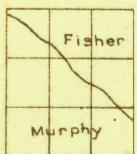

APPROXIMATE MEAN  
DECLINATION, 1925

