

DEPARTMENT OF THE INTERIOR  
U. S. GEOLOGICAL SURVEY

439-S-III-W/2-NE/4  
STATE OF TEXAS  
BOARD OF WATER ENGINEERS  
JOHN A. NORRIS, CHAIRMAN  
C. S. CLARK, A. H. DUNLAP

Advance sheet  
Subject to correction

TEXAS  
QUANAH 3-a QUADRANGLE



(Quanah 3-b)

10'  
1235 000  
YARDS

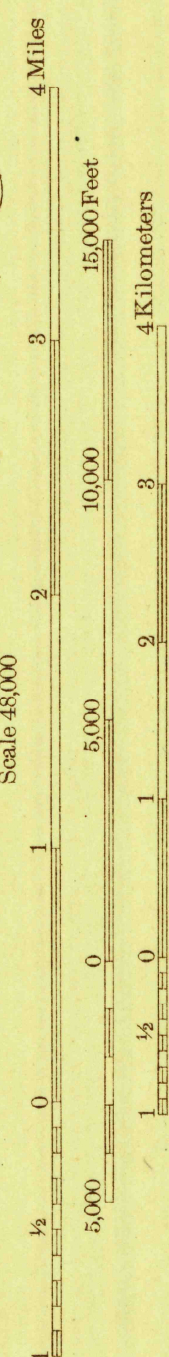

W. H. Herron, Division Engineer  
Topography by R.W. Burchard and S.T. Penick  
Culture and drainage in part compiled from aerial photographs  
taken by Air Corps, U. S. Army  
Control by U. S. Geological Survey  
Surveyed in 1926-1927

TRUE NORTH  
MAGNETIC NORTH  
APPROXIMATE MEAN  
DECLINATION, 1927

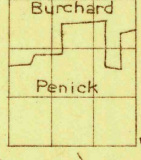

Polyconic projection. North American datum  
5000 yard grid based upon U. S. zone system, D

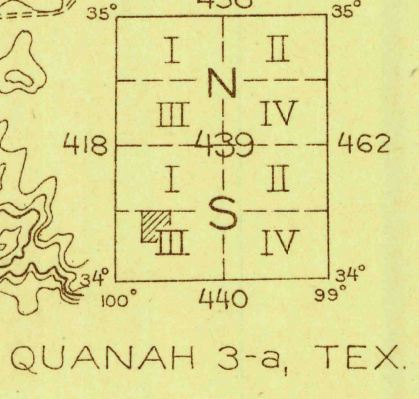

BOARD OF SURVEYS & MAPS  
RECEIVED  
DEC 6 - 1927  
Map Information Office