

U. S. G. S.
FILE COPY
Inspection and Editing.

TOPOGRAPHIC FILES

RETAINED COPY

MAY 2 1925

This sheet must not be taken from the files without an order from Chief Topographic Engineer.

421-S-11-W/2-SW/4
STATE OF TEXAS
BOARD OF WATER ENGINEERS
JOHN A. NORRIS, CHAIRMAN
C. S. CLARK, A. H. DUNLAP
(San Angelo 2-b)

Advance sheet
Subject to correction

TEXAS
(TOM GREEN COUNTY)
SAN ANGELO 2-c QUADRANGLE

DEPARTMENT OF THE INTERIOR
U. S. GEOLOGICAL SURVEY

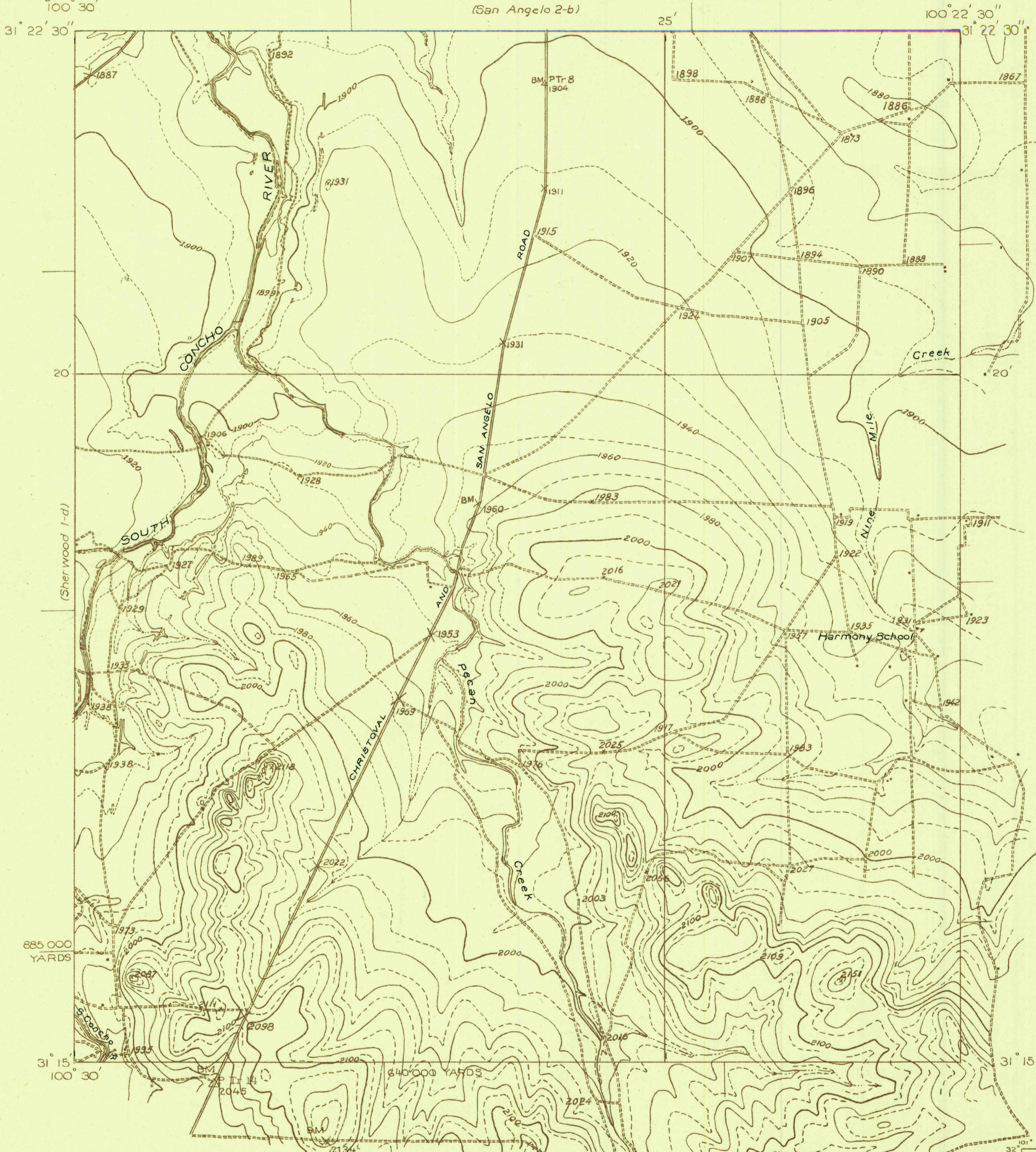

Topography by WH Griffin, WL Miller, and HS Milsted
Surveyed in 1923-1924

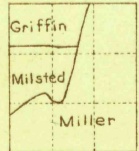

TRUE NORTH
MAGNETIC NORTH
APPROXIMATE MEAN DECLINATION, 1924

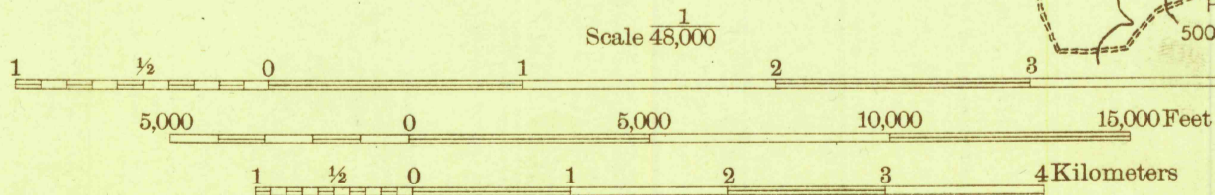

Scale 48,000
Contour interval 20 feet
10 foot contours in dashed lines
Datum is mean sea level

Polyconic projection. North American datum
5000 yard grid based upon U. S. zone system, D

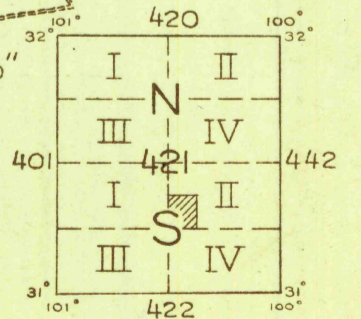

SAN ANGELO 2-c, TEX.

U. S. G. S.
FILE COPY
Inspection and Editing.